

© Copyright 2006 Brockette/Davis/Drake, Inc. All Rights Reserved.
 This drawing is the property of Brockette/Davis/Drake, Inc. Any modification or use of this drawing without the express written authorization of Brockette/Davis/Drake, Inc. is prohibited.

26412

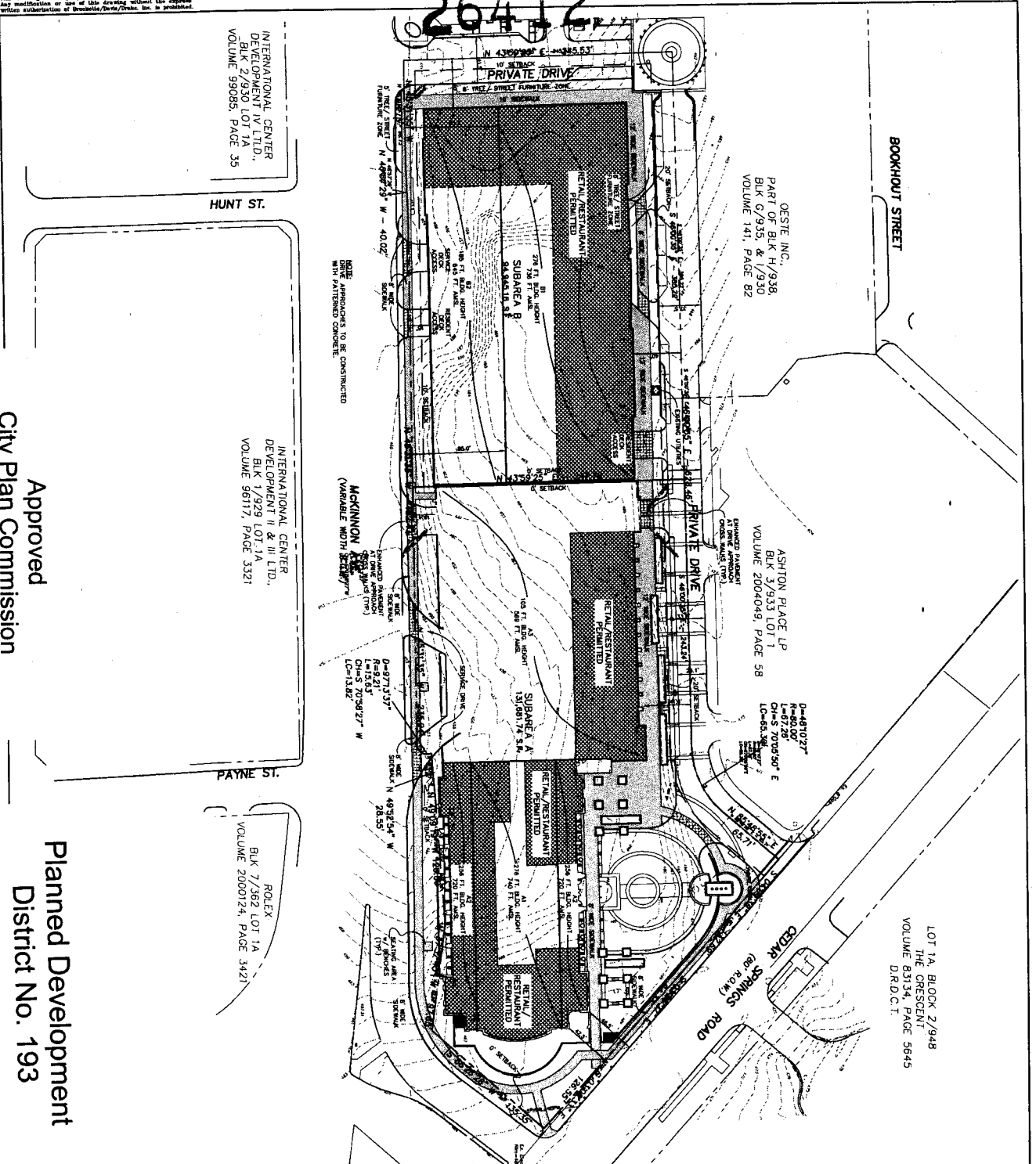

INTERNATIONAL CENTER DEVELOPMENT IV LTD., BLK 2/930 LOT 1A VOLUME 99085, PAGE 35

HUNT ST.

INTERNATIONAL CENTER DEVELOPMENT II & III LTD., BLK 1/929 LOT 1A VOLUME 98117, PAGE 3321

PAYNE ST.

ROLEX BLK 7/362 LOT 1A VOLUME 2000124, PAGE 3421

OSSTE INC. PART OF BLK H/938 BLK G/935 & I/930 VOLUME 141, PAGE 82

ASHTON PLACE LP BLK 5/933 LOT 1 VOLUME 2004093, PAGE 58

BOOKHOUT STREET

LOT 1A, BLOCK 2/948 THE CRESCENT, PAGE 5645 D.R.C.T.

COAK SPRINGS ROAD (OLD R.O.W.)

Approved
 City Plan Commission
 June 22, 2006

Planned Development
 District No. 193

PDS No. 74

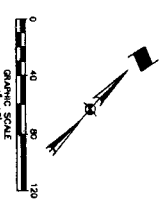
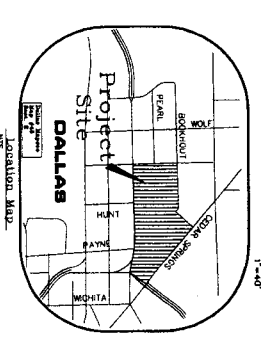

NOTES:

1. HAVE FLOOR AREA FOR ALL RETAIL USES COMBINED ON THE PROPERTY IS 20,000 SQ. FT.
2. HAVE FLOOR AREA FOR ALL OFFICE USES COMBINED ON THE PROPERTY IS 44,000 SQ. FT.
3. HAVE FLOOR AREA FOR ALL OFFICE USES COMBINED IN 500' X 100' AREA IS 10,000 SQ. FT.
4. HAVE FLOOR AREA FOR ALL OFFICE USES COMBINED IN 500' X 100' AREA IS 10,000 SQ. FT.
5. HAVE FLOOR AREA FOR ALL OFFICE USES COMBINED IN 500' X 100' AREA IS 10,000 SQ. FT.
6. HAVE FLOOR AREA FOR ALL OFFICE USES COMBINED IN 500' X 100' AREA IS 10,000 SQ. FT.
7. HAVE FLOOR AREA FOR ALL OFFICE USES COMBINED IN 500' X 100' AREA IS 10,000 SQ. FT.
8. HAVE FLOOR AREA FOR ALL OFFICE USES COMBINED IN 500' X 100' AREA IS 10,000 SQ. FT.
9. HAVE FLOOR AREA FOR ALL OFFICE USES COMBINED IN 500' X 100' AREA IS 10,000 SQ. FT.
10. HAVE FLOOR AREA FOR ALL OFFICE USES COMBINED IN 500' X 100' AREA IS 10,000 SQ. FT.
11. HAVE FLOOR AREA FOR ALL OFFICE USES COMBINED IN 500' X 100' AREA IS 10,000 SQ. FT.
12. HAVE FLOOR AREA FOR ALL OFFICE USES COMBINED IN 500' X 100' AREA IS 10,000 SQ. FT.
13. HAVE FLOOR AREA FOR ALL OFFICE USES COMBINED IN 500' X 100' AREA IS 10,000 SQ. FT.
14. HAVE FLOOR AREA FOR ALL OFFICE USES COMBINED IN 500' X 100' AREA IS 10,000 SQ. FT.
15. HAVE FLOOR AREA FOR ALL OFFICE USES COMBINED IN 500' X 100' AREA IS 10,000 SQ. FT.
16. HAVE FLOOR AREA FOR ALL OFFICE USES COMBINED IN 500' X 100' AREA IS 10,000 SQ. FT.
17. HAVE FLOOR AREA FOR ALL OFFICE USES COMBINED IN 500' X 100' AREA IS 10,000 SQ. FT.
18. HAVE FLOOR AREA FOR ALL OFFICE USES COMBINED IN 500' X 100' AREA IS 10,000 SQ. FT.
19. HAVE FLOOR AREA FOR ALL OFFICE USES COMBINED IN 500' X 100' AREA IS 10,000 SQ. FT.
20. HAVE FLOOR AREA FOR ALL OFFICE USES COMBINED IN 500' X 100' AREA IS 10,000 SQ. FT.

ADDITIONAL REQUIREMENTS:

- A. NO MORE THAN 70% OF THE PROPERTY.
- B. STRUCTURES WITH A HEIGHT HIGHER THAN THE LOWER OF 100 FT. OR 50% MAX. WAVE COVER NO MORE THAN 50% OF THE PROPERTY.

REMARKS:

- 1. 464' AREAS
- 2. 726' FT. HEIGHT*
- 3. 726' FT. HEIGHT*
- 4. 726' FT. HEIGHT*
- 5. 726' FT. HEIGHT*
- 6. 726' FT. HEIGHT*
- 7. 726' FT. HEIGHT*
- 8. 726' FT. HEIGHT*
- 9. 726' FT. HEIGHT*
- 10. 726' FT. HEIGHT*
- 11. 726' FT. HEIGHT*
- 12. 726' FT. HEIGHT*
- 13. 726' FT. HEIGHT*
- 14. 726' FT. HEIGHT*
- 15. 726' FT. HEIGHT*
- 16. 726' FT. HEIGHT*
- 17. 726' FT. HEIGHT*
- 18. 726' FT. HEIGHT*
- 19. 726' FT. HEIGHT*
- 20. 726' FT. HEIGHT*

ADDITIONAL NOTES:

- 1. 464' AREAS
- 2. 726' FT. HEIGHT*
- 3. 726' FT. HEIGHT*
- 4. 726' FT. HEIGHT*
- 5. 726' FT. HEIGHT*
- 6. 726' FT. HEIGHT*
- 7. 726' FT. HEIGHT*
- 8. 726' FT. HEIGHT*
- 9. 726' FT. HEIGHT*
- 10. 726' FT. HEIGHT*
- 11. 726' FT. HEIGHT*
- 12. 726' FT. HEIGHT*
- 13. 726' FT. HEIGHT*
- 14. 726' FT. HEIGHT*
- 15. 726' FT. HEIGHT*
- 16. 726' FT. HEIGHT*
- 17. 726' FT. HEIGHT*
- 18. 726' FT. HEIGHT*
- 19. 726' FT. HEIGHT*
- 20. 726' FT. HEIGHT*

ROSEWOOD COURT DEVELOPMENT
 DALLAS, TEXAS

CONCEPTUAL PLAN Z056 213 DW

BROCKETTE-DAVIS-DRAKE, INC.
 Chief of Structural Engineering - Supervising
 4444 North Central Expressway, Suite 700 • Dallas, Texas 75246
 (214) 750-0000 • Fax: (214) 750-0000

DESIGNED	DATE	SCALE	SHEET	TOTAL SHEETS	FILE	NO.
BDI	8/1/06	1"=40'	500	00580		P01