

28859

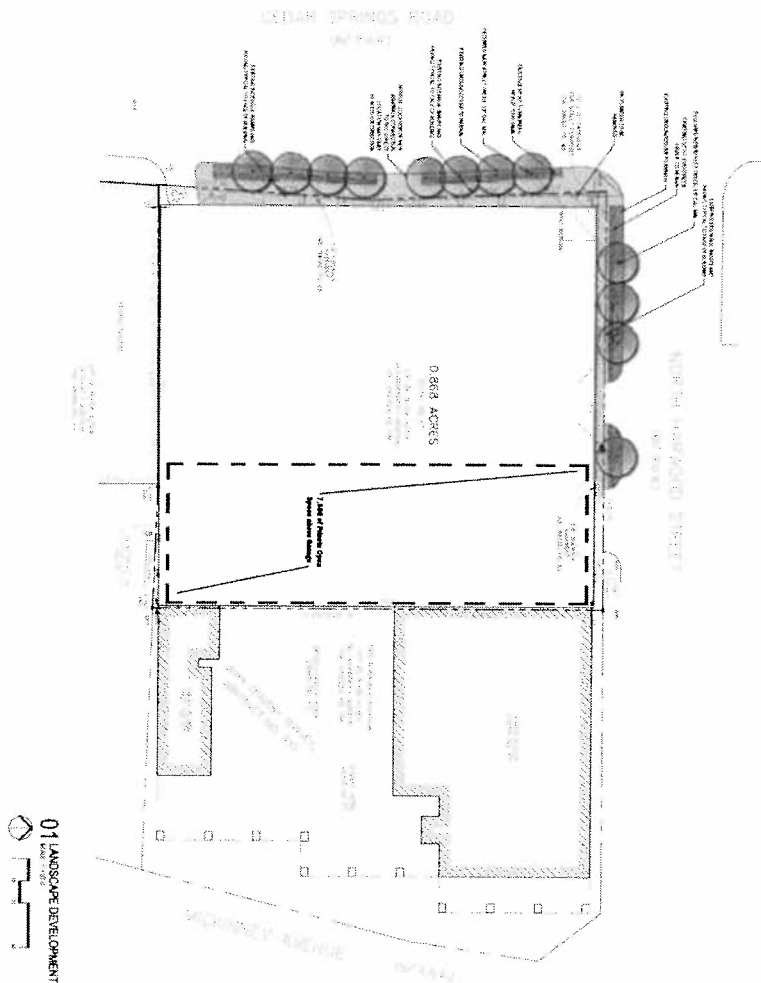

Planned Development
Subdistrict No. 50

Planned Development
District No. 193

Approved
City Plan Commission
September 20, 2012

01 LANDSCAPE DEVELOPMENT PLAN
Scale: 1/8" = 1'-0"



01 LANDSCAPE DEVELOPMENT PLAN

GENERAL NOTES:

1. ALL PLANTINGS SHALL BE INSTALLED AS SHOWN ON THIS PLAN.
2. ALL PLANTINGS SHALL BE INSTALLED IN ACCORDANCE WITH THE CITY OF DALLAS PLANTING SPECIFICATIONS.
3. ALL PLANTINGS SHALL BE INSTALLED IN ACCORDANCE WITH THE CITY OF DALLAS PLANTING SPECIFICATIONS.
4. ALL PLANTINGS SHALL BE INSTALLED IN ACCORDANCE WITH THE CITY OF DALLAS PLANTING SPECIFICATIONS.
5. ALL PLANTINGS SHALL BE INSTALLED IN ACCORDANCE WITH THE CITY OF DALLAS PLANTING SPECIFICATIONS.
6. ALL PLANTINGS SHALL BE INSTALLED IN ACCORDANCE WITH THE CITY OF DALLAS PLANTING SPECIFICATIONS.
7. ALL PLANTINGS SHALL BE INSTALLED IN ACCORDANCE WITH THE CITY OF DALLAS PLANTING SPECIFICATIONS.
8. ALL PLANTINGS SHALL BE INSTALLED IN ACCORDANCE WITH THE CITY OF DALLAS PLANTING SPECIFICATIONS.
9. ALL PLANTINGS SHALL BE INSTALLED IN ACCORDANCE WITH THE CITY OF DALLAS PLANTING SPECIFICATIONS.
10. ALL PLANTINGS SHALL BE INSTALLED IN ACCORDANCE WITH THE CITY OF DALLAS PLANTING SPECIFICATIONS.

LOT DATA

LOT SIZE	37,791 SF
TOTAL COVERED AREA	10,000 SF
LOT COVERABLE AREA	94% (35,491 SF)
EXISTING DRIVE FRONT	100' (100' DRIVE)
EXISTING DRIVE SIDE	100' (100' DRIVE)
EXISTING DRIVE REAR	100' (100' DRIVE)
EXISTING DRIVE OTHER	100' (100' DRIVE)
NO DISTRICT USE	

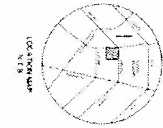

LANDSCAPE ARCHITECT
DALLAS, TEXAS
09/20/12

2112-126

LDP-1

1900 CEDAR SPRINGS
DALLAS, TEXAS
DEVELOPMENT PLAN

Good Fulton & Farrell Architects
2809 Fairview Street
Suite 200
Dallas, Texas 75201
214.803.8500/141
214.803.8512/Fax
www.gff.com