

# EXHIBIT S-32A TRAVIS STREET

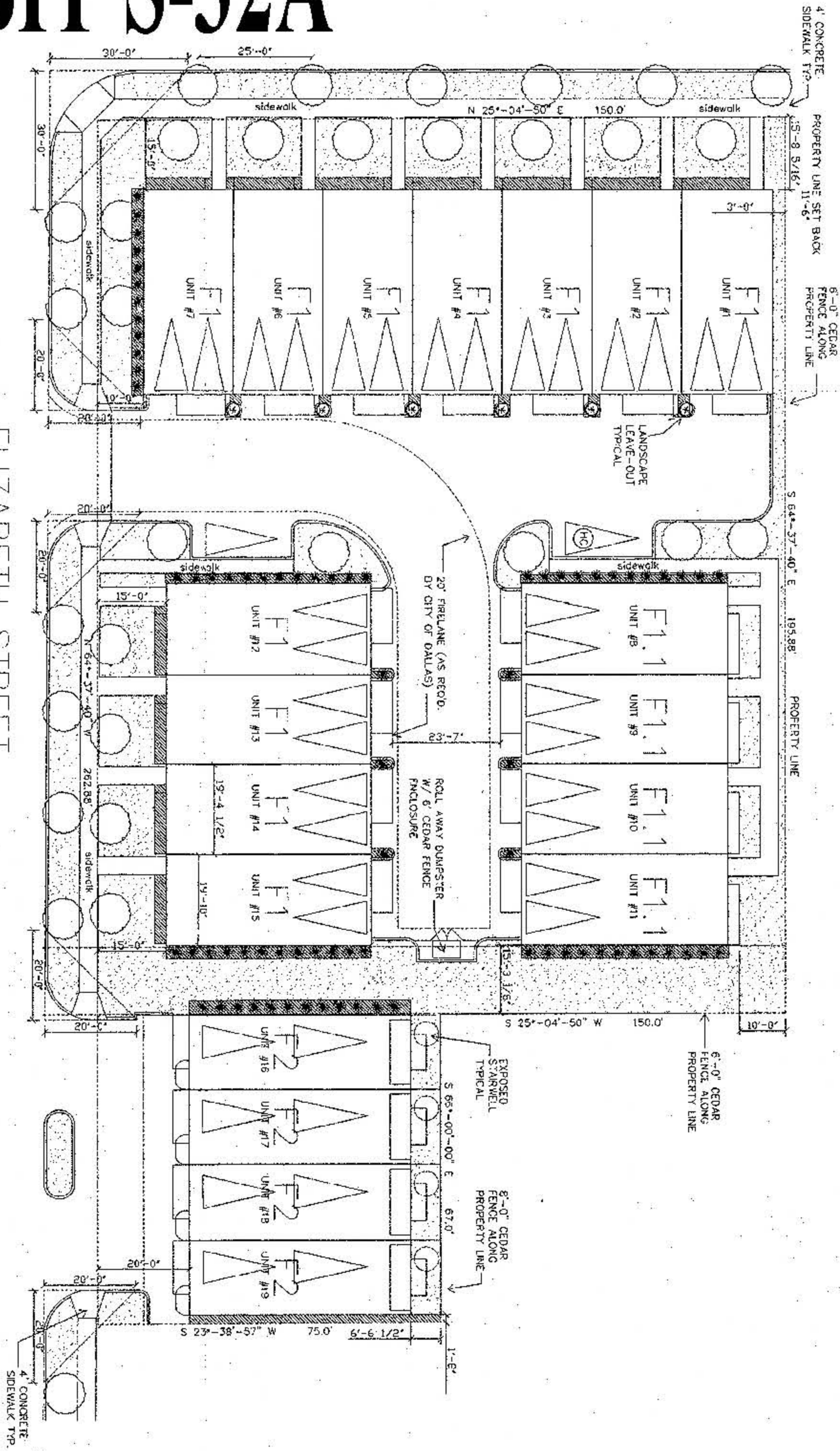

## CITY HOMES

4100 TRAVIS STREET, DALLAS, TEXAS



DEVELOPMENT / LANDSCAPE PLAN  
SCALE: 1" = 20'-0"

ELIZABETH STREET

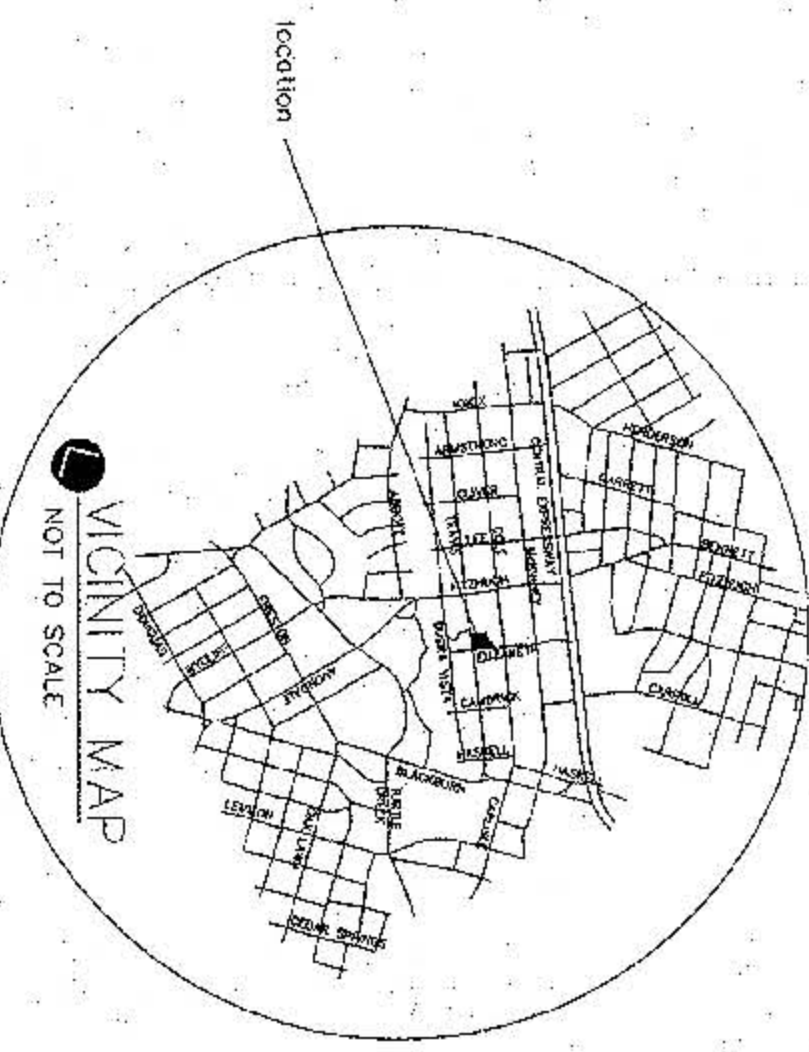

### PROGRAM

F1 CONDOMINIUM	NET AREA:	2,182 SF
	GROSS AREA:	2,585 SF
11 UNITS	TOTAL NET AREA:	24,002 SF
	TOTAL GROSS AREA:	28,435 SF
F1.1 CONDOMINIUM	NET AREA:	2,182 SF
	GROSS AREA:	2,585 SF
4 UNITS	TOTAL NET AREA:	8,728 SF
	TOTAL GROSS AREA:	10,340 SF
F2 CONDOMINIUM	NET AREA:	1,607 SF
	GROSS AREA:	2,352 SF
4 UNITS	TOTAL NET AREA:	6,428 SF
	TOTAL GROSS AREA:	9,408 SF
19 UNITS	TOTAL NET AREA:	39,158 SF
	TOTAL GROSS AREA:	48,183 SF
	SITE AREA:	0.788 ACRE
	DENSITY:	22.8 UNITS/ACRE
	BUILDING HEIGHT:	36'
	LOT COVERAGE:	50%

### LANDSCAPE LEGEND

- 14" RED-OAK 3"-4" CALIPER  
GENERAL PLANTING AREA
- 4" - 6" CREPE MYRTLE
- 2' - 3' INDIAN HAWTHORNE
- GENERAL PLANTING AREA
- SPECIAL PLANTING AREA
- OFF STREET PARKING (TYPICAL)

991875  
23909  
APPROVED BY  
CITY COUNCIL

JUN 09 1999  
City Secretary  
Approved  
City Plan Commission

PLANNED DEVELOPMENT DISTRICT NO. 32

PLANNED DEVELOPMENT DISTRICT NO. 193  
2989-184/10837-CL08