

201734

Exhibit S-156B

31675

Planned Development Subdistrict No. 156

Planned Development District No. 93

Approved City Plan Commission September 3, 2020

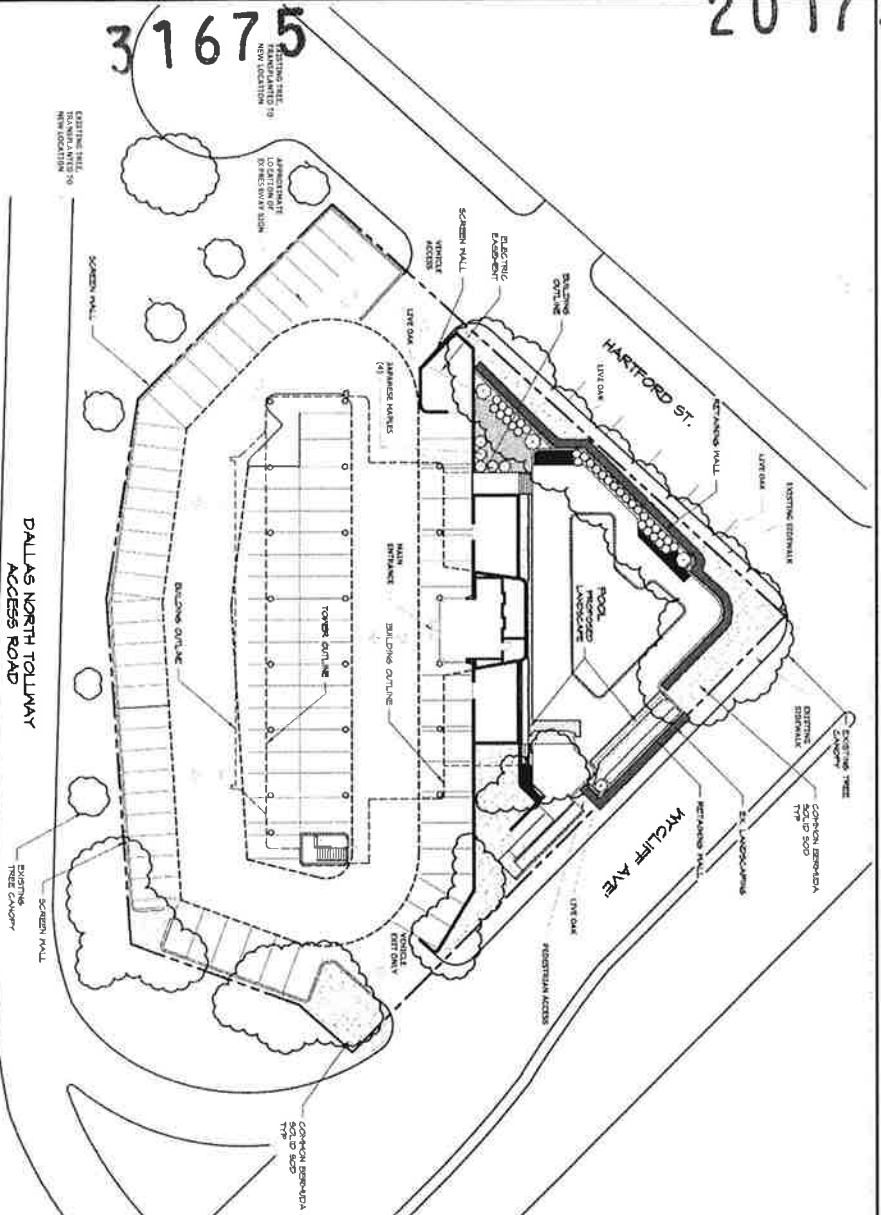

REQUIRED LANDSCAPE

- MYCLIFF AVE: Existing trees to remain and plant toward provided. Required plantings.
HARTFORD STREET: Existing trees to remain and plant toward provided. Required plantings.
DNT ACCESS ROAD: Existing trees to remain and plant toward provided. Required plantings.
SITE TREES: 1-3" CAL. TREE / 4000 SF OR LOT AREA. 4-5" CAL. TREE / 1000 SF OR LOT AREA. 6-7" CAL. TREE / 500 SF OR LOT AREA.
DESIGN STANDARDS: 1. EXISTING TREES TO REMAIN AND PLANT TOWARD PROVIDED. 2. EXISTING TREES TO REMAIN AND PLANT TOWARD PROVIDED. 3. EXISTING TREES TO REMAIN AND PLANT TOWARD PROVIDED. 4. EXISTING TREES TO REMAIN AND PLANT TOWARD PROVIDED.

LANDSCAPE LEGEND

- 1" CAL. TREE / 4000 SF OR LOT AREA. 4" CAL. TREE / 1000 SF OR LOT AREA. 6" CAL. TREE / 500 SF OR LOT AREA.
EXISTING TREE CANOPY (TO BE MAINTAINED)
EXISTING TREE CANOPY (TO BE REPLANTED)
CORNER BENCHON (20" DIA. SOLID SPP)
CORNER BENCHON (20" DIA. SOLID SPP)

SITE/BUILDING ACCESS LEGEND

- 'A' MAIN ENTRANCE TO THE BUILDING AT ELEVATOR LOBBY / PARKING LOT LEVEL. NO STAIRS REQUIRED TO ENTER BUILDING.
'B' PEDESTRIAN ENTRANCE TO THE BUILDING AT LEVEL 1 LOBBY. SMALL SET OF STAIRS TO REACH MAIN ENTRY DOOR.
'C' PEDESTRIAN ACCESS TO THE REACH POOL AREA.
'D' VEHICULAR ACCESS TO THE PROPERTY. ACCESSIBLE RAMP TO PROPERLY ACCESSIBLE RAMP TO VEHICULAR ACCESS ONLY.

LANDSCAPE AND SCREENING

Landscaping Plans Braniff Building City of Dallas, Dallas County, Texas

Scale bar (0 to 20 feet), North arrow, STUDY logo, PROJECT INFORMATION: PROJECT: BAR009, SHEET: L1 of 1, DATE: 11/2/2020.

2190-055