

31493

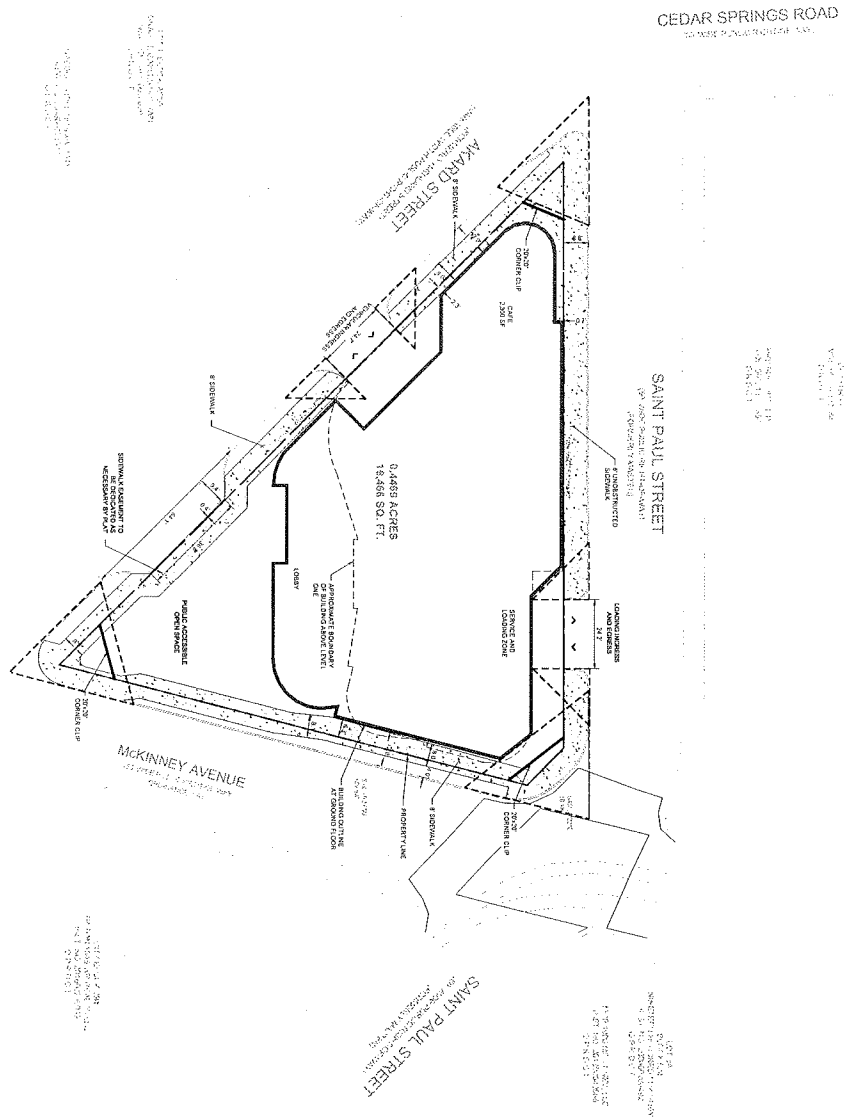

Approved
City Plan Commission
January 23, 2020

Planned Development
Subdistrict No. 153

Planned Development
District No. 93

811
Know what's below.
Call before you dig.

NUMBER 811 CALL BEFORE YOU DIG



PARKING

| | |
|---------------|----|
| STREETS | 28 |
| MULTI-PURPOSE | 15 |
| TOTAL | 43 |

MINIMUM SETBACKS

| | |
|-------|---|
| FRONT | 0 |
| REAR | 0 |
| SIDE | 5 |

Overall Site Data

| | |
|----------------------|-----------------|
| SITE AREA | 13,863 |
| LOT COVERAGE | 75% |
| PROPOSED COVERING | 26,381 SQ. FT. |
| PROPOSED COVERING | 129,191 SQ. FT. |
| UNDERGROUND COVER | 15,000 SQ. FT. |
| PAVING DIVISION AREA | 30,000 SQ. FT. |

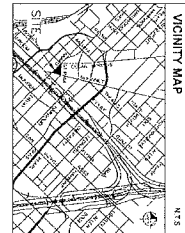

DEVELOPMENT PLAN
DEV14

CASE #
1899 MCKINNEY AVENUE
DALLAS TEXAS

Kimley»Horn
© 2018 KIMLEY-HORN AND ASSOCIATES, INC.
13455 NOEL ROAD, TWO GALERIA OFFICE TOWER
SUITE 700, DALLAS, TEXAS 75246
PHONE: 972-736-4338 FAX: 972-238-3833
WWW.KIMLEY-HORN.COM TXF-928

| | |
|---------|---------|
| DATE | 1/23/20 |
| BY | ... |
| CHECKED | ... |
| DATE | ... |
| BY | ... |
| CHECKED | ... |
| DATE | ... |
| BY | ... |
| CHECKED | ... |
| DATE | ... |
| BY | ... |
| CHECKED | ... |
| DATE | ... |
| BY | ... |