

**LEGEND:**

- PROPERTY LINE
- SETBACK (MEASURED FROM PROPERTY LINE)
- FRONT: 10'-0"
- SIDE: 10'-0" (EXCEPT AS NOTED)
- REAR: 15'-0"
- 30' X 20' VISIBILITY OBSTRUCTION TRIANGLE

**PROJECT DATA:**

- SITE: 48,287 S.F. / 1.12 ACRES
- BUILDING: 14,000 S.F.
- LOT COVERAGE: 14.4%
- BUILDING HEIGHT: 24'-0"
- NUMBER OF STORIES: 2
- NUMBER OF UNITS: 50
- PARKING: 0.3 SPACE / BED PARKING PERMITTED WITHIN SIDE AND REAR SETBACKS
- LOADING: 1 SMALL LOADING SPACE
- LANDSCAPE: COMPLIANCE WITH ARTICLE X OF DEVELOPMENT CODE EXCEPT WHERE SHOWN OTHERWISE
- PERIMETER LANDSCAPE BUFFER: 10'-0" FROM FRONT PROPERTY LINE, 3'-0" FROM SIDE AND REAR PROPERTY LINES
- INGRESS / EGRESS: ONE POINT OF INGRESS AND EGRESS SHALL BE PERMITTED ON BOTH DICKASON AVENUE AND HOOD STREET

MAXIMUM HEIGHT OF ON-SITE STRUCTURES IS 24'-0" P.E.A.

**VICINITY MAP**

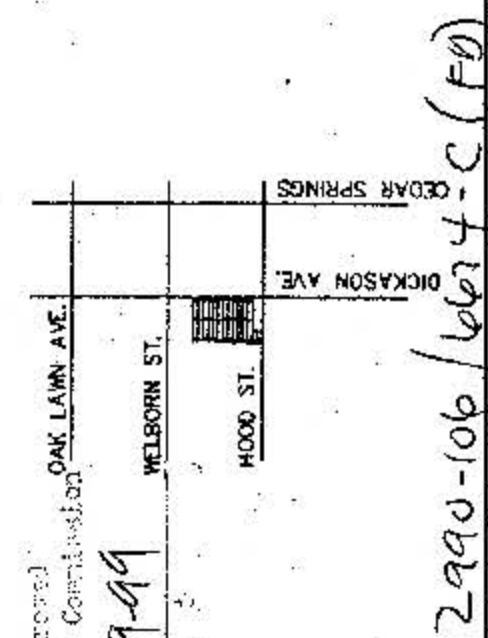

JAMES H. WHEELER ARCHITECT  
9600 Chatsworth Drive, Suite E03  
San Diego, CA 92123  
(619) 571-9800

PROJECT NO.	DATE
REVISIONS/ADDITIONS	
PROJECT	
ActivCare at Turtle Creek	
OWNER: HEALTH CARE GROUP	
DRAWING TITLE: Skilled Nursing Facility Wing Conversion Development Plan	
DRAWN BY: JFHU	PROJECT NO.
CHECKED:	CAD FILE NO.
PLOT DATE:	DRAWING NO.
DATE: 11-24-99	
SCALE:	

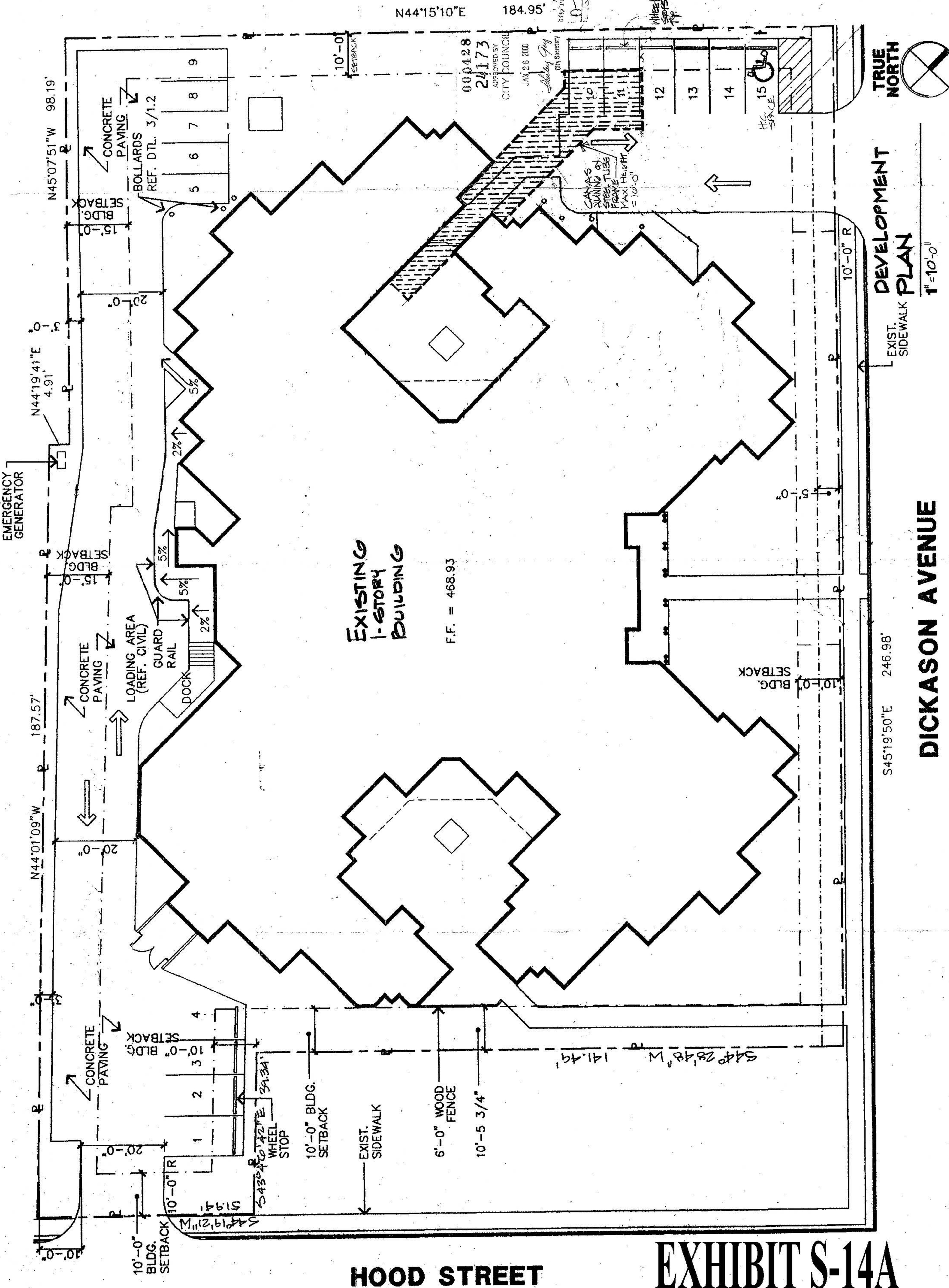

**EXHIBIT S-14A**