

31095

190116

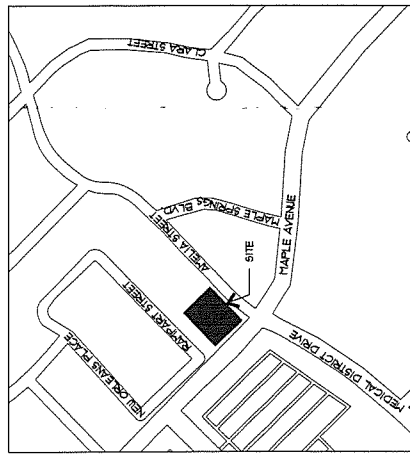

SITE AREA: .5197 AC.
22,613.13 SQ. FT.

USES:
LIMITED GR SUBDISTRICT USES (refer to ordinance)

FLOOR AREA: PER GR DISTRICT STANDARDS
RESTAURANT: MAX. 4,000 SQ. FT.
RETAIL: MAX. 8,000 SQ. FT.
BAR, LOUNGE, OR TAVERN: MAX. 11,800 SQ. FT.

COVERAGE: 32%
PARKING: PER GR DISTRICT STANDARDS
RESTAURANT: 1/110 SQ. FT.
RETAIL: 1/220 SQ. FT.

YARDS:
FRONT: 10 FT. ALONG MAPLE AVE
5 FT. ALONG AMELIA ST. AFTER 5 FT. ROW DEDICATION
SIDE AND REAR: NONE

HEIGHT: 36 FT.

FLOOR AREA RATIO: MAX. 2:1

LANDSCAPE: PER LANDSCAPE PLAN

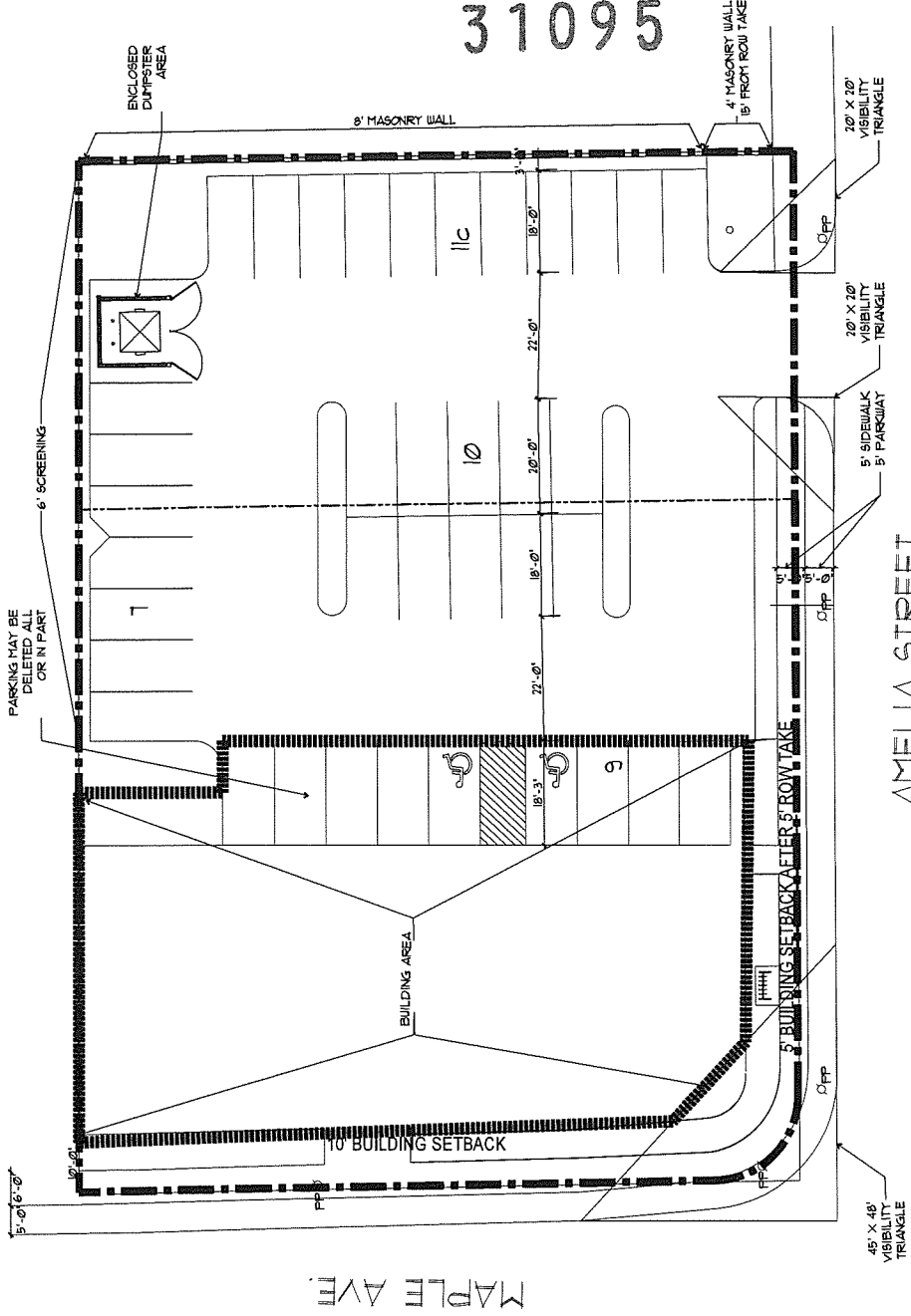

SCALE: 1" = 10'-0"

EXHIBIT S-
PD 193, PDS NO. _____
REVISED: 10/05/2018



DEVELOPMENT PLAN

DALLAS, TEXAS

Z178-282

PRELIMINARY PLAN
NOT FOR CONSTRUCTION

A1

JOB NO. _____ DATE: 10/05/2018
SCALE AS NOTED

Exhibit S-145A

Planned Development
District No. 193

Planned Development
District No. 145

Approved
City Plan Commission
October 18, 2018



DALLAS, TX 972.365.5851
www.gsoarchitects.com
THIS DRAWING IS THE PROPERTY OF GSO ARCHITECTS AND SHALL NOT BE REPRODUCED OR TRANSMITTED IN ANY FORM OR BY ANY MEANS, ELECTRONIC OR MECHANICAL, INCLUDING PHOTOCOPYING, RECORDING, OR BY ANY INFORMATION STORAGE AND RETRIEVAL SYSTEM.