

30667

171612

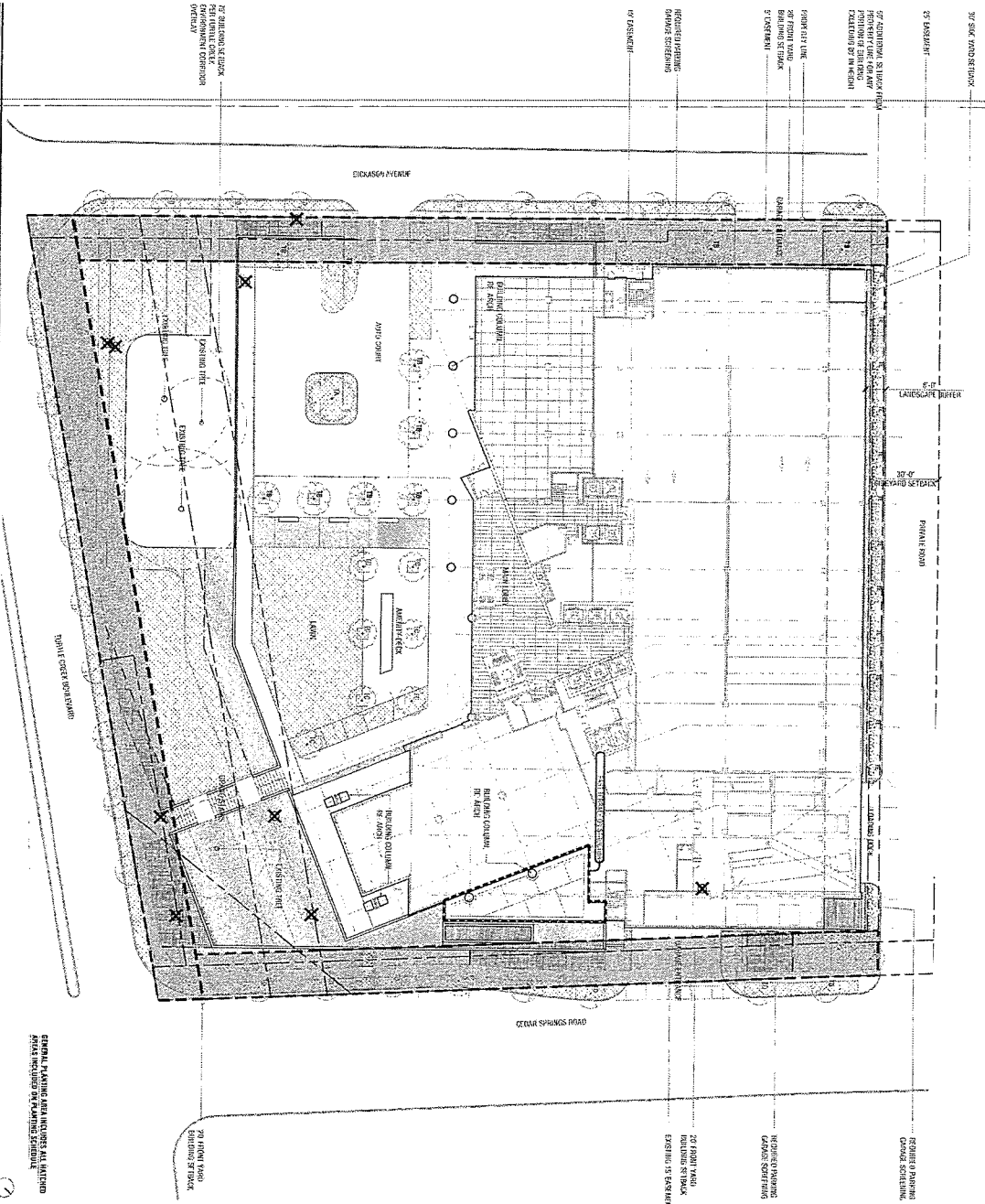

GENERAL PLANNING DATA

AREA	AREA #	AREA NAME	AREA TYPE	AREA CLASS	AREA CODE
RESIDENTIAL AREA	1135	RESIDENTIAL AREA	RESIDENTIAL	R10	1135
COMMERCIAL AREA	1136	COMMERCIAL AREA	COMMERCIAL	C20	1136

GENERAL PLANNING DATA (continued)

AREA	AREA #	AREA NAME	AREA TYPE	AREA CLASS	AREA CODE
RECREATION AREA	1137	RECREATION AREA	RECREATION	R20	1137
INDUSTRIAL AREA	1138	INDUSTRIAL AREA	INDUSTRIAL	I10	1138

GENERAL PLANNING DATA (continued)

AREA	AREA #	AREA NAME	AREA TYPE	AREA CLASS	AREA CODE
UNDEVELOPED LAND	1139	UNDEVELOPED LAND	UNDEVELOPED	U10	1139

Approved
City Plan Commission
September 7, 2017

LANDSCAPE CODE PLAN 00

CITY OF DALLAS LANDSCAPE CODE PLAN

REVISIONS: 01-18-2017

ISSUED BY: JAMES THOMAS

DATE: 01-18-2017

KEY

KEY	DESCRIPTION
(Symbol)	EXISTING TREES TO BE REMOVED
(Symbol)	TREES TO BE PLANTED
(Symbol)	LANDSCAPE FEATURES TO BE INSTALLED
(Symbol)	LANDSCAPE FEATURES TO BE REMOVED

PLANTING SCHEDULE

NO.	DESCRIPTION	SPECIES	SIZE	PLANTING DATE	PLANTING METHOD
1	SPRING PLANTING AREA	FRUITING TREE - GINGER WAXMOUTH	4-6"	SPRING	PLANTING
2	FOLIAGE PLANTING AREA	FRUITING TREE - GINGER WAXMOUTH	4-6"	FALL	PLANTING
3	SHRUB PLANTING AREA	FRUITING TREE - GINGER WAXMOUTH	4-6"	FALL	PLANTING

PICKARD CHILTON Power logo with contact information: 817.625.5000, www.pickardchilton.com

ARCHITECT: PICKARD CHILTON ARCHITECTS, INC.
880 CHINA STREET
NEW HAVEN, CONNECTICUT 06510
ARCHITECT OF RECORD: BOB POWELL, LLC
200 PARRIS LANE, SUITE 300
DALLAS, TEXAS 75241

GENERAL CONTRACTOR: WEST COMMERCIAL
2001 W. JONES ROAD, SUITE 200
DALLAS, TEXAS 75244

LANDSCAPE ARCHITECT: JAMES THOMAS ASSOCIATES, INC.
5150 N. CENTRAL EXPRESSWAY, STE 100
DALLAS, TEXAS 75241

CONSULTING ENGINEER: FRIBORG ENGINEERING, INC.
11700 N. DALLAS PARKWAY, STE 3000
DALLAS, TEXAS 75248

ENGINEER: PACHECO KOCH
7557 RAMBLER RD, SUITE 1400
DALLAS, TEXAS 75241

LANDSCAPE ARCHITECT: THE OFFICE OF JAMES BURNETT
711 LOUISIANA, SUITE 111
HOUSTON, TEXAS 77002

PREPARED BY: JAMES THOMAS ASSOCIATES, INC.
5150 N. CENTRAL EXPRESSWAY, STE 100
DALLAS, TEXAS 75241

PROJECT: 3001 TURTLE CREEK BLVD
DALLAS, TX 75218

DATE: 05-01-2017

Z167-306(W/E)

LANDSCAPE PLAN
Project Number: MARCH 17, 2017
L.O.05