



1 PD DEVELOPMENT PLAN  
SCALE: 1" = 20'-0"

Planned Development  
Subdistrict No. 125

Planned Development  
District No. 193

Approved  
City Plan Commission  
June 2, 2016

CASE NUMBER: Z156-164

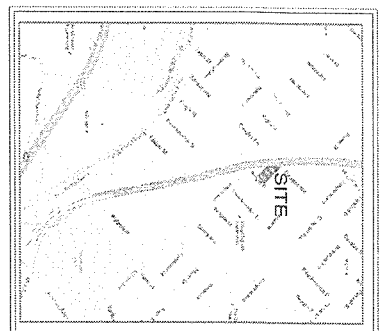
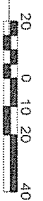
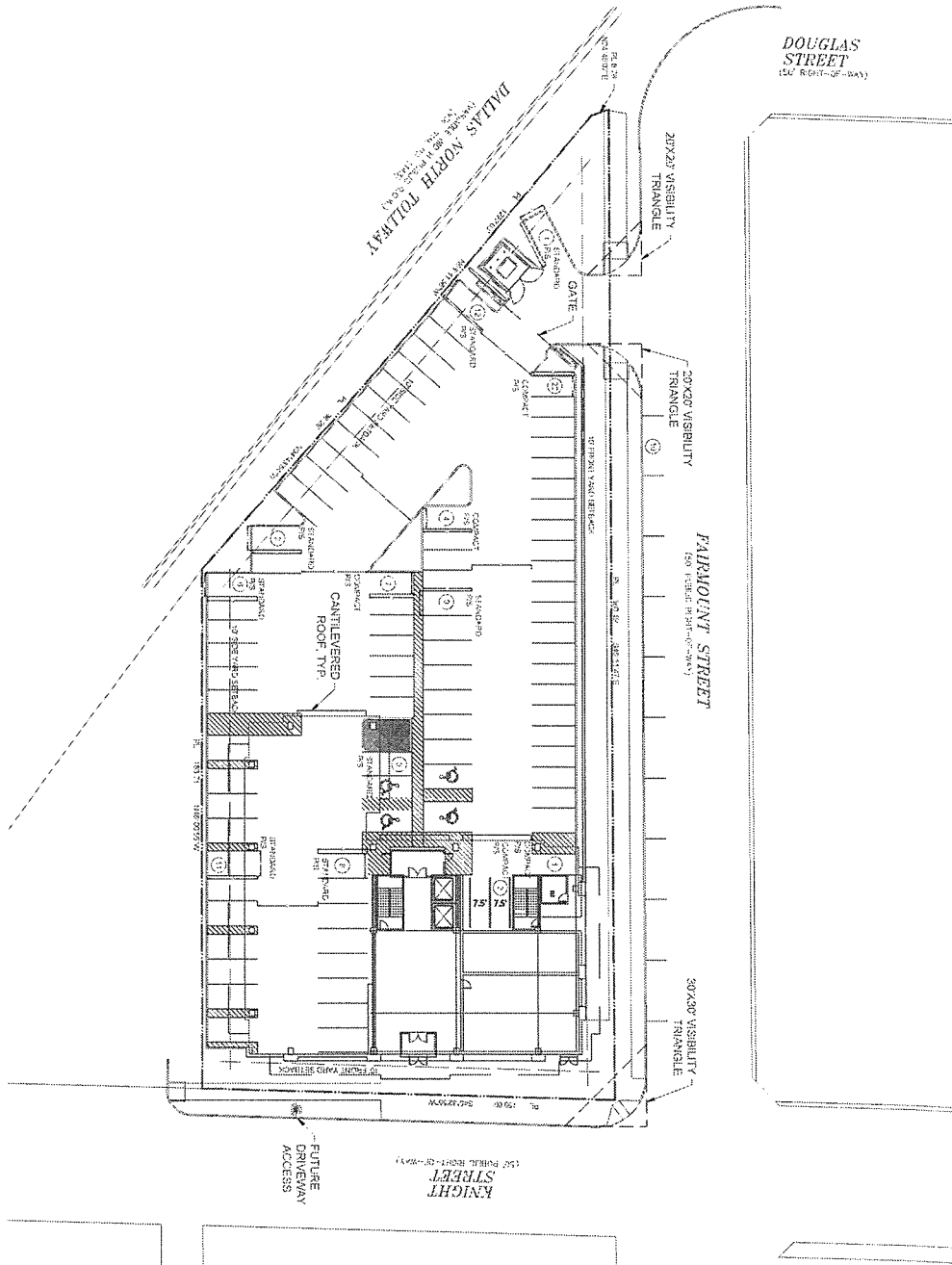

**SITE INFORMATION:**

- ZONING DISTRICT: PD 193 PDS
- LOT AREA: 0.59 ACRES
- LAND USE: OFFICE, RESTAURANT
- MAXIMUM FLOOR AREA: 45,000 SF (RESTAURANT LIMITED TO 1,500 SF)
- MAXIMUM BUILDING HEIGHT: 85'
- MAXIMUM LOT COVERAGE: 45%
- MANHOLE SETBACKS:
  - FRONT YARD: 10'
  - SIDE YARD: 10'
  - REAR YARD: N/A
- PARKING:
  - REQUIRED = 100 P/S
  - PROVIDED = 100 P/S
  - 89 ON-SITE
  - 10 ON-STREET
  - REMAINING SPACES PROVIDED BY PD 193
- FUTURE DRIVEWAY ACCESS

FAIRMOUNT AND KNIGHT  
CITY OF DALLAS, TEXAS

**Baldwin**  
Associates

BALDWIN ASSOCIATES  
3904 Elm Street, Suite B  
Dallas, Texas 75226  
MOBILE: 214.729.7949  
OFFICE: 214.824.7949  
rob@baldwinplanning.com

05/18/2016  
PROJECT NUMBER  
CADD NUMBER