

25423

# EXHIBIT 96A

032856

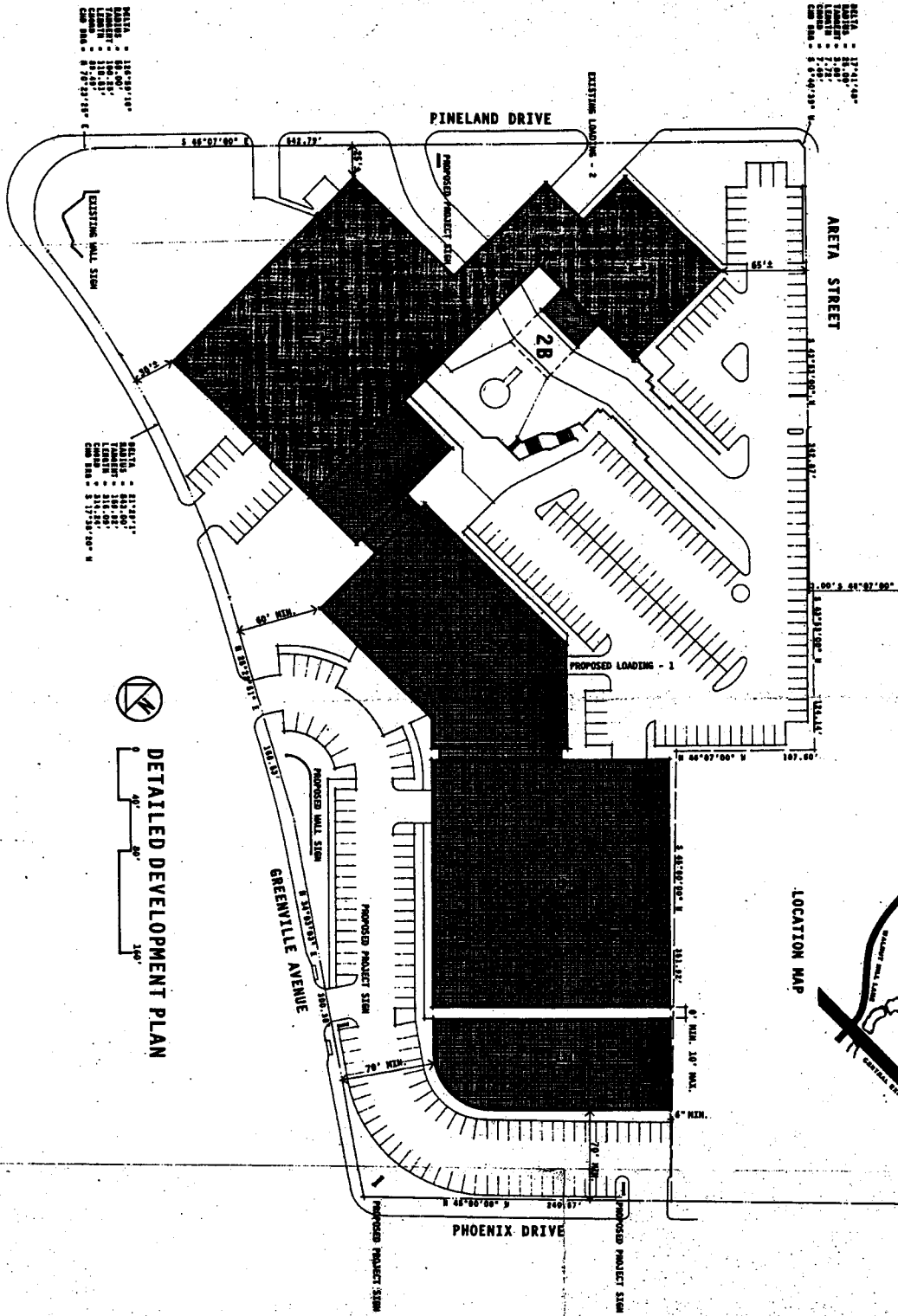

1	EXISTING BUILDING TO REMAIN	73,000 SF
2A	PROPOSED ENCLOSED ENTRY	1,500 SF
2B	PROPOSED COVERED ENTRY	1,500 SF
3	EXISTING COVERED PLAZA TO BE ENCLOSED	5,000 SF
4	PROPOSED OFFICE BUILDING	140,000 SF
5	PROPOSED OFFICE BUILDING	40,000 SF
6	PROPOSED PARKING STRUCTURE	150,000 SF
	TOTAL BUILDING SQUARE FOOTAGE (MAXIMUM)	250,500 SF
	MINIMUM BUILDING HEIGHT	140'
	MINIMUM PARKING PROVIDED	PER CODE
	SITE AREA	334,481 SF

LOCATION MAP

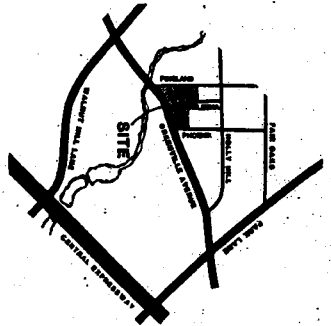

DETAILED DEVELOPMENT PLAN



Planned development request No. 316  
 2.555 - 200 / 954 - 14

893011  
 20426  
 APPROVED BY  
 CITY COUNCIL  
 2/7/95  
 2/7 15 00  
 KASS  
 ARCHITECTS  
 2077 Dallas Parkway # 2000 Dallas, Texas 75231  
 (214) 750-5371

DATE MAY 03 1995 SHEET NUMBER 1	REVISIONS 2/11/95	<p><b>DETAILED DEVELOPMENT PLAN</b></p> <p><b>THE AMERICAN HEART ASSOCIATION NATIONAL CENTER EXPANSION</b></p> <p>7320 GREENVILLE AVENUE DALLAS, TEXAS 75231 (214) 750-5371</p>	<p><b>MPD</b></p> <p>Architecture &amp; Planning &amp; Interiors Design        2077 Dallas Parkway # 2000 Dallas, Texas 75231</p>
--	----------------------	---	---