

25423

032856

EXHIBIT 67E

001 DEVELOPMENT PLAN
SCALE 1" = 30'-0"

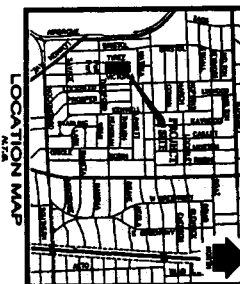
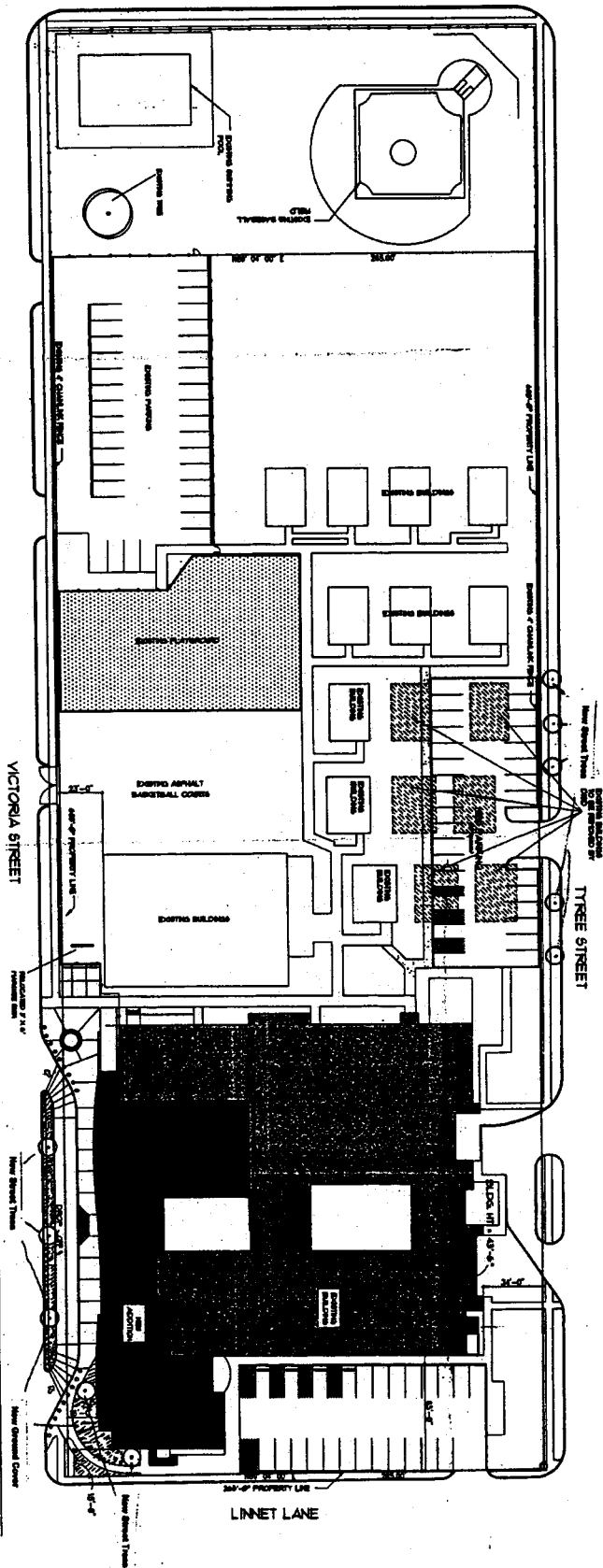

SITE DATA SUMMARY

PROPOSED USE	PUBLIC SCHOOL
TOTAL LOT AREA	8029 SQ. FT.
TOTAL BUILDING AREA	4488 SQ. FT.
DOCKETS	1327 SQ. FT.
ADDITION	3161 SQ. FT.
DEMOLITION AREA	
MAJOR BUILDING HEIGHT	12'-0"
TOTAL LOT COVERAGE	55.8%
CLASSROOMS	23
DOCKETS	22
PARKING PROVIDED	30
PARKING REQUIRED	30
DOCKETS PROVIDED	30
DOCKETS REQUIRED	30

Site area enclosed
1-5-15-03 3023-310 1
NAMED INSTRUMENT NUMBER 30-12

<p>091708 25283 JUN 11 2003 CITY COUNCIL</p>	<p>Additions and Renovations to K. B. Polk Elementary School 6911 Victoria Avenue Dallas, Texas 75209 for the Dallas Independent School District</p>	<p>PRATT JACKSON 1546 STEAKING FRMY #2 - DALLAS, TEXAS 75207-214-520-8000</p>	<p>PRELIMINARY Independent Documents Not for Construction Approval or Construction Texas Registration #1466</p>
<p>SITE PLAN DESIGN DEVELOPMENT DSD 8P/03 CITY COUNCIL</p>	<p>PROJECT NO. 0208 DATE: 27 APRIL 2003 DRAWN BY: CHECKED BY:</p>	<p>DEVI 1 SHEET 01 SHEETS</p>	<p>091708 25283 JUN 11 2003 CITY COUNCIL</p>