

Exhibit 5N

APPROVED BY
CITY COUNCIL
JAN 10 1974
H. B. BROWN
SEAL

EXISTING FREIGHT ALLEYS

RECORD MAP: TOP OF RETAINING WALL
ELEV. = 115.0 ±

NOTE:
1. MAXIMUM BLDG HEIGHT - 20'-0"
2. MAXIMUM LIGHT POLE HEIGHT @ INTERSECTION - 20'-0"
3. MAXIMUM LIGHT POLE HEIGHT @ SIDE ROAD - 20'-0"
4. LIGHT FIXTURE @ LIGHT POLE - 10'-0" HIGHER THAN 2'-0" CLEARANCE

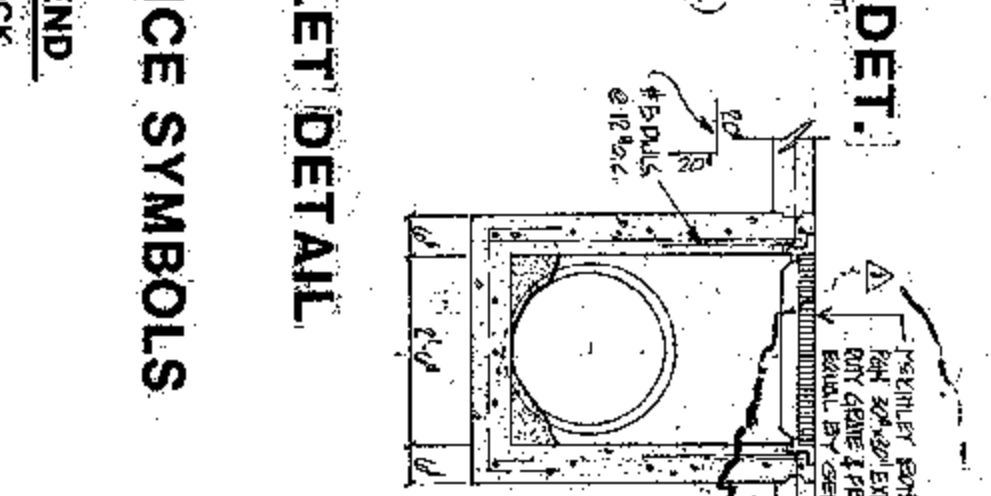
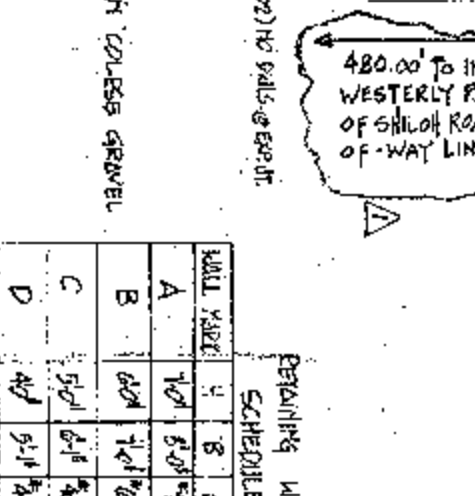
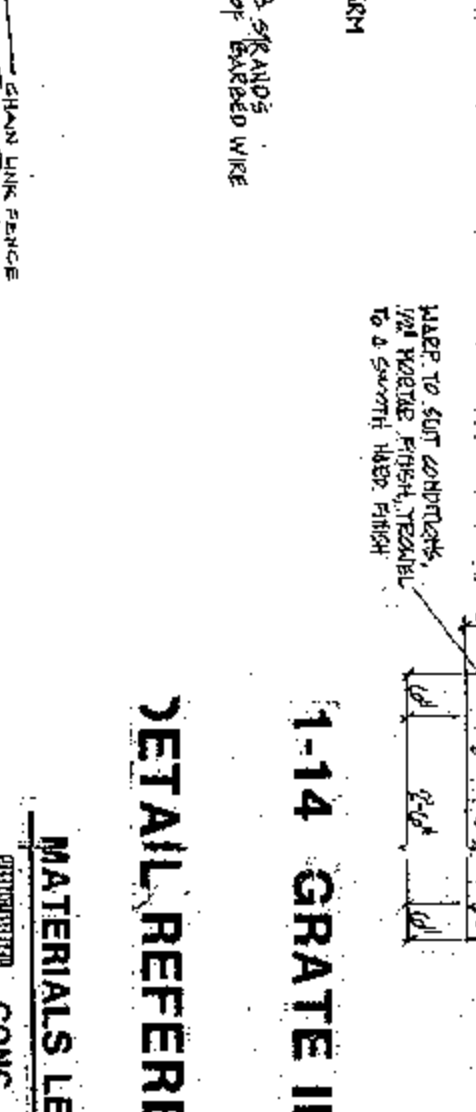
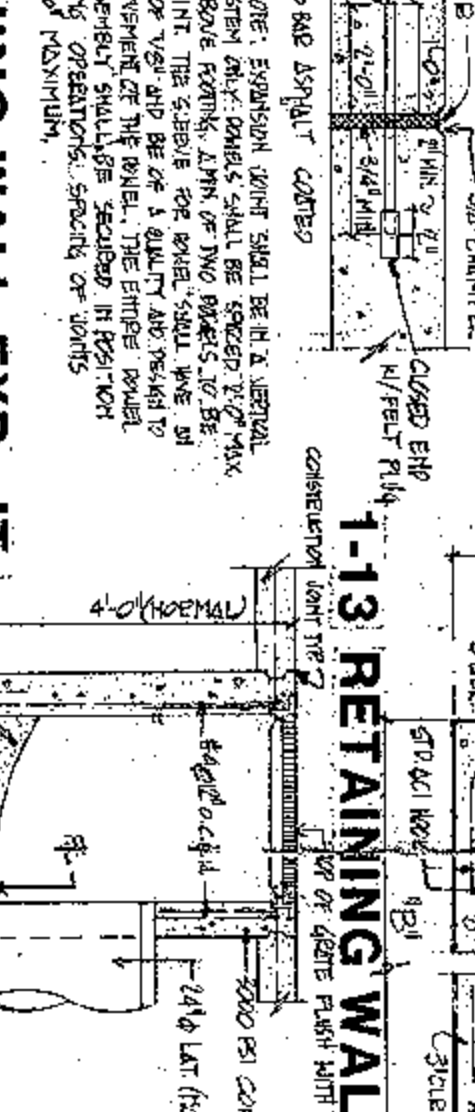
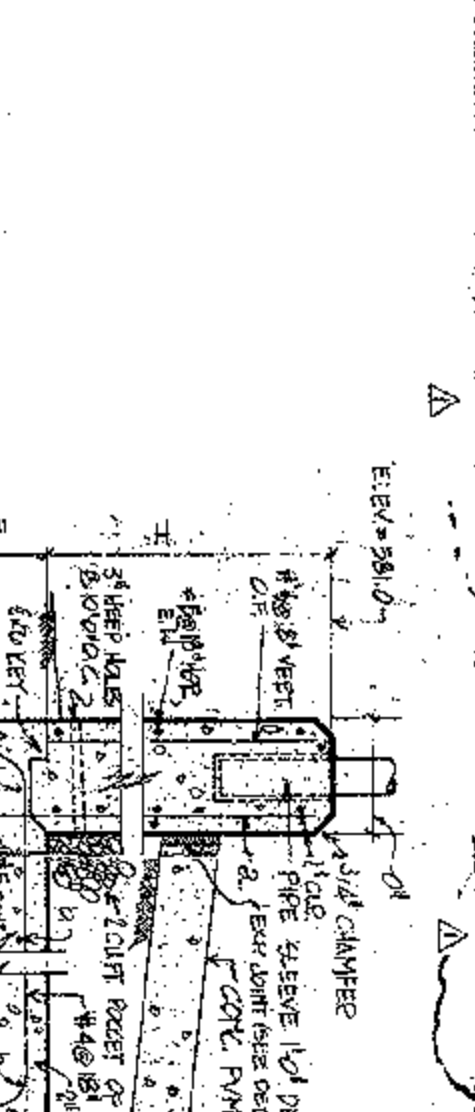
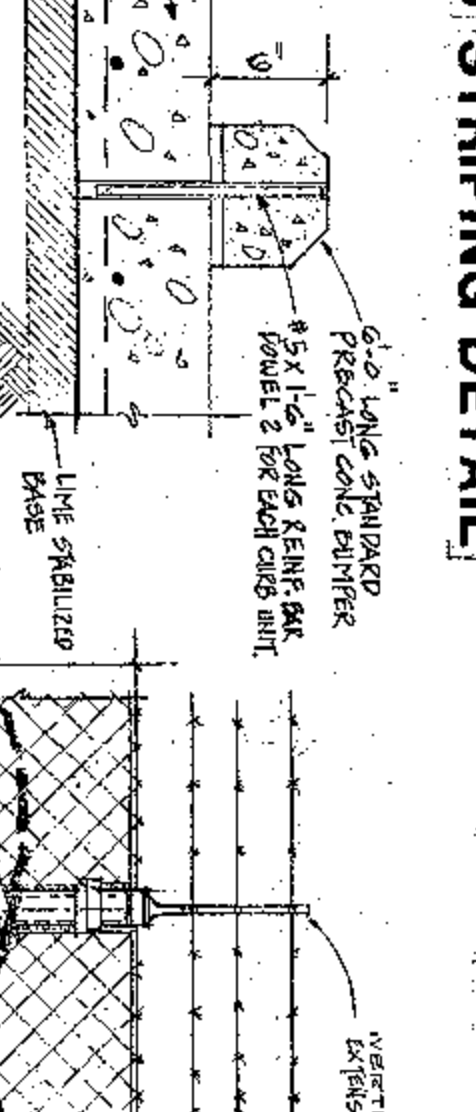
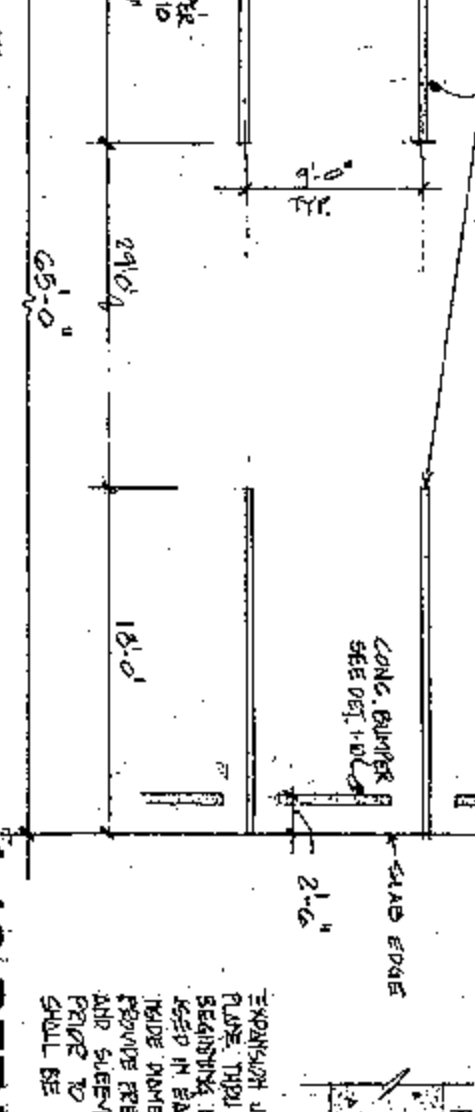
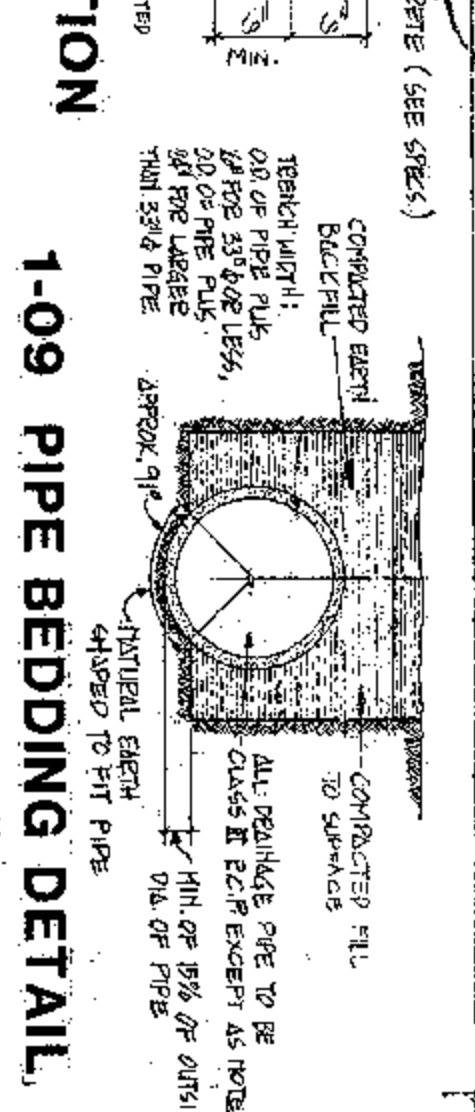
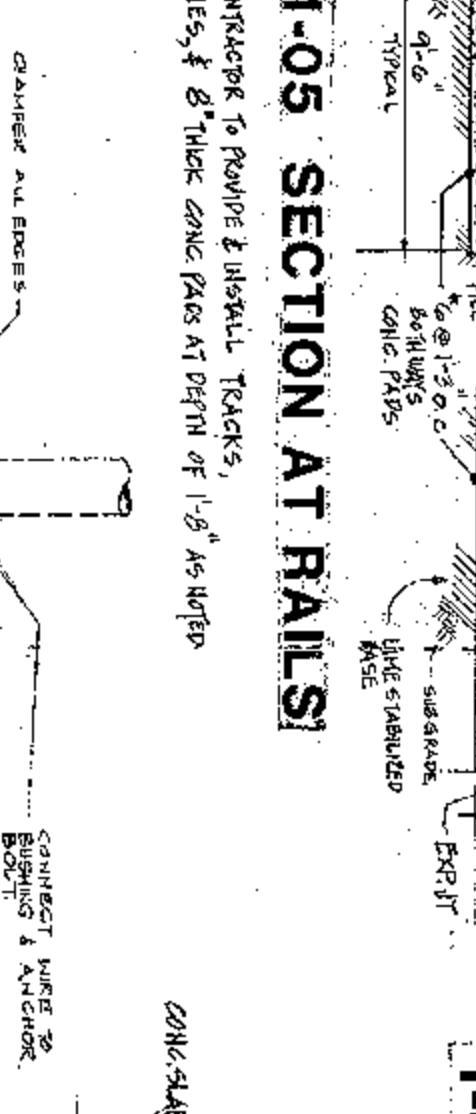
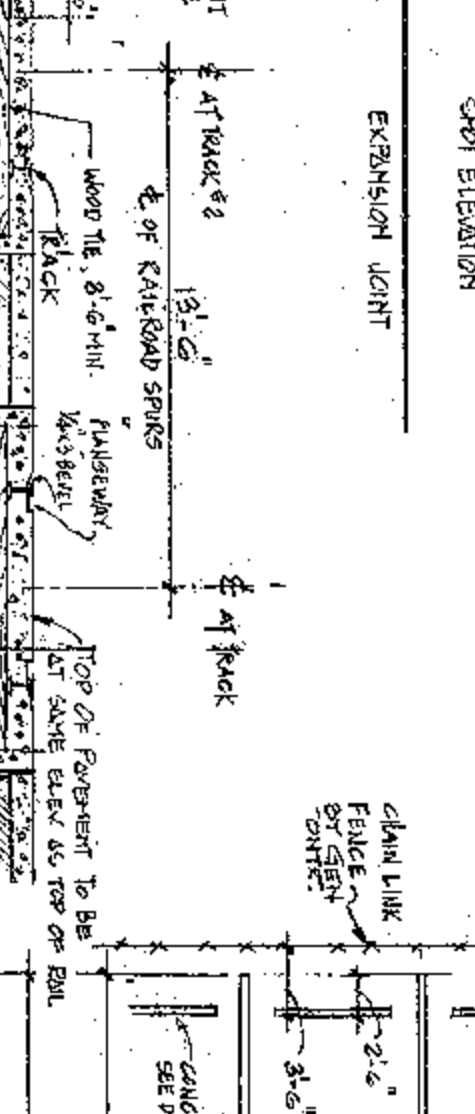
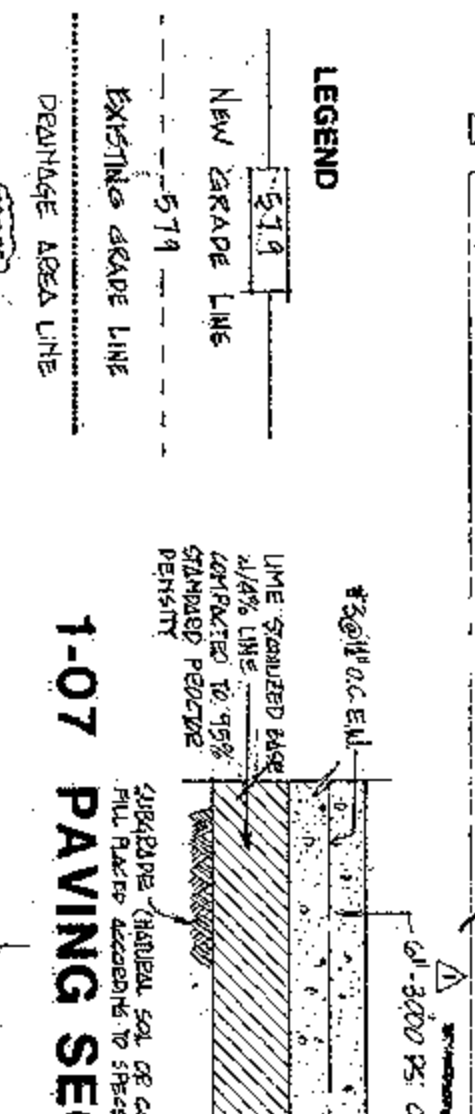
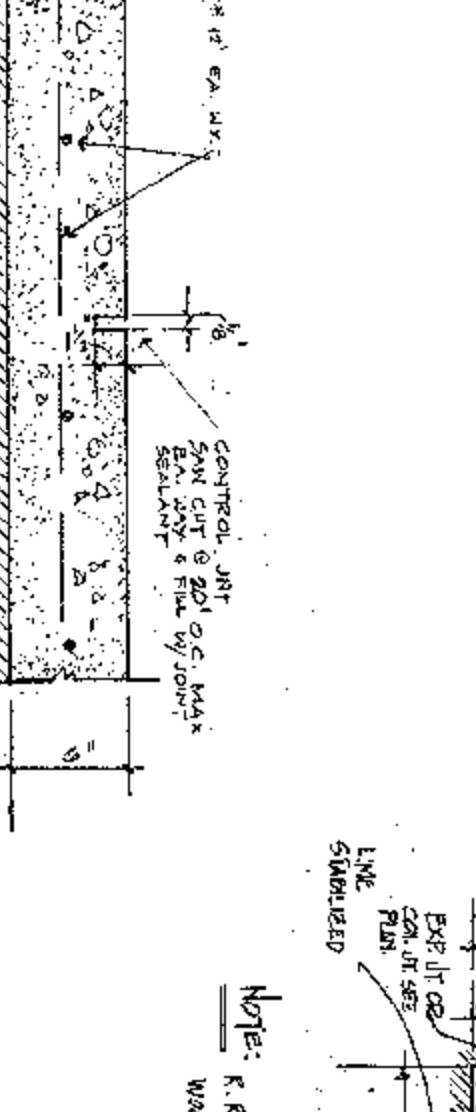
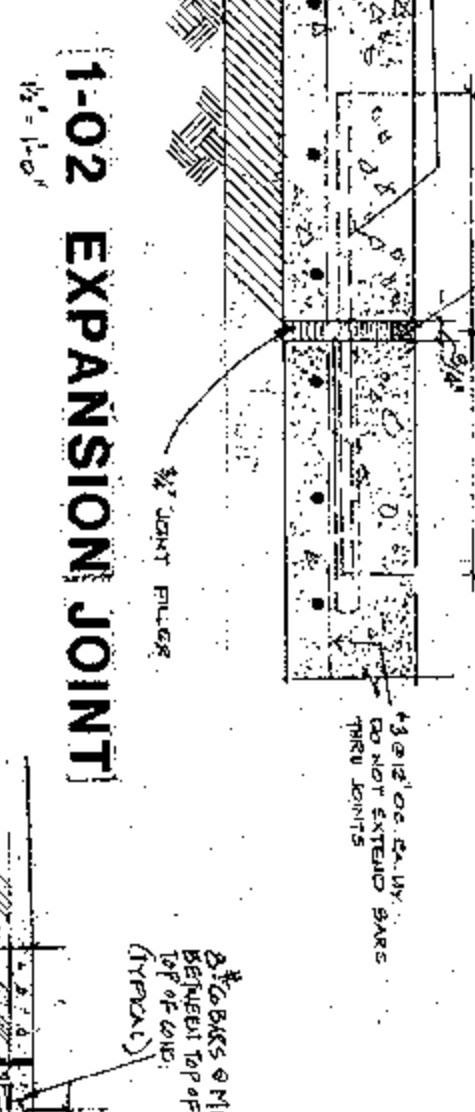
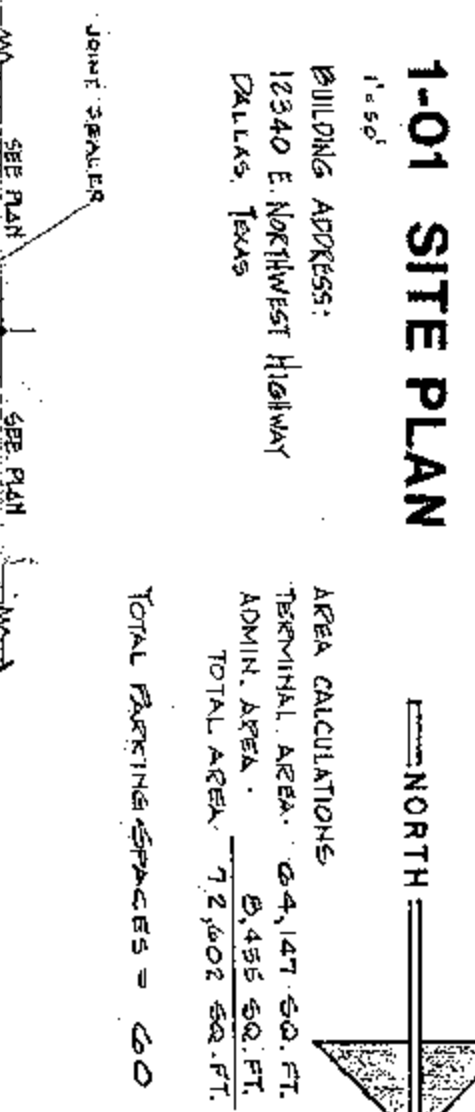
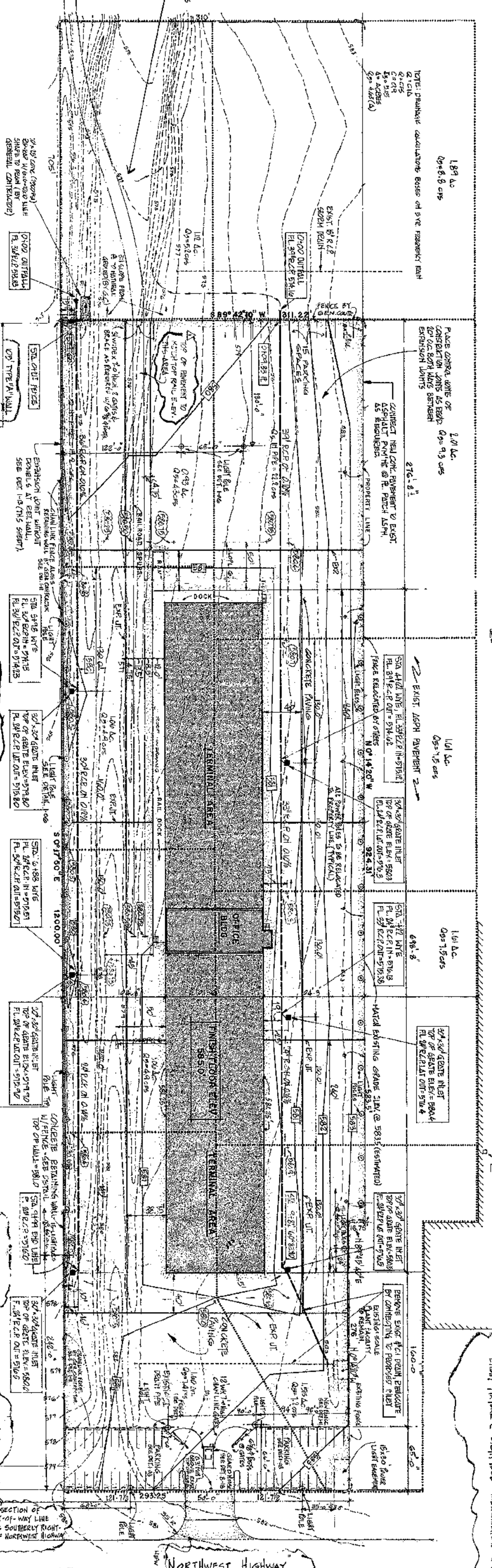

MATERIALS LEGEND

CONC. BLOCK	CONCRETE
WOOD	INSULATED WALL UP TO STRUCTURAL

WALL SECTION

BUILDING SECTION

ELEVATION REFERENCE

DETAIL REFERENCE

GORDON SIBBECK & ASSOC., INC. ARCHITECTS
DALLAS, TEXAS

DATE: 11-29-72
SHEET NO. 5

SEARS TERMINAL FREIGHT FACILITY DALLAS, TEXAS