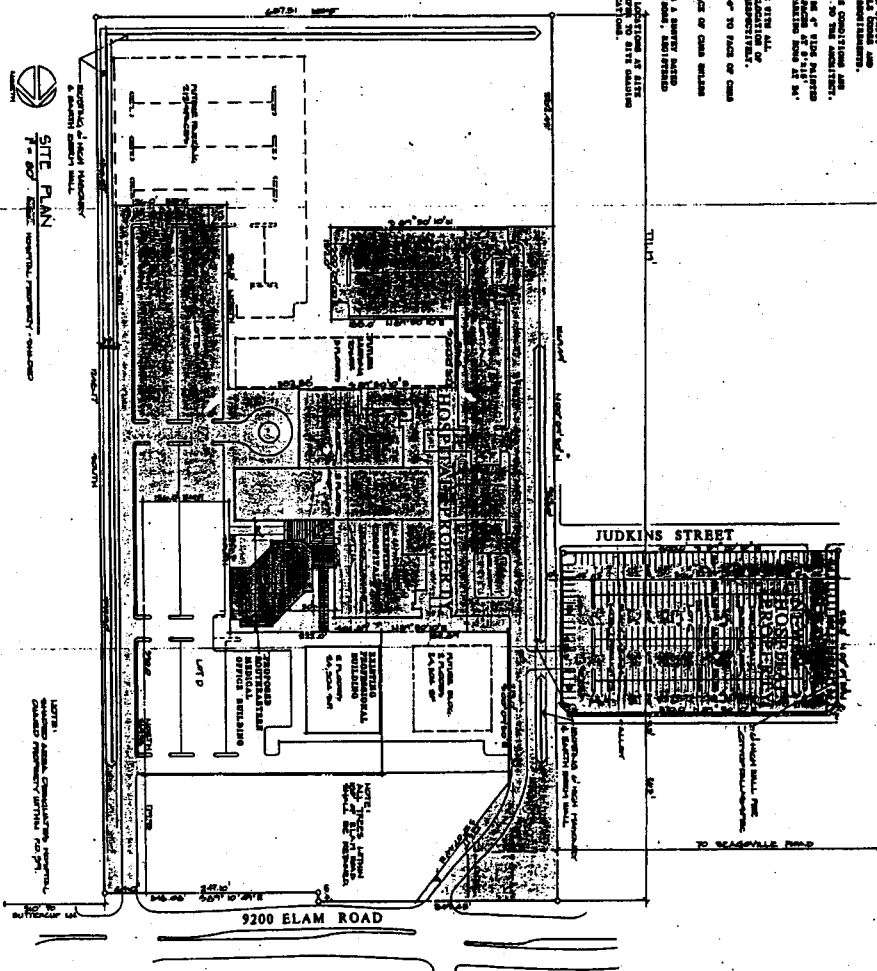

EXHIBIT 59A

1. ALL CONSTRUCTION SHALL BE IN ACCORDANCE WITH THE LATEST EDITIONS OF THE INTERNATIONAL BUILDING CODES AND THE TEXAS BUILDING CODE.
2. CONTRACTOR TO VERIFY ALL CONDITIONS AND REPORT ANY DISCREPANCIES TO THE ARCHITECT.
3. FINISH LINE SHALL BE 3/4" ABOVE FINISH FLOOR AND ALL OTHERS SHALL BE FINISH FLOOR AT 0".
4. CONTRACTOR TO VERIFY ALL CONDITIONS AND REPORT ANY DISCREPANCIES TO THE ARCHITECT.
5. ALL CONSTRUCTION SHALL BE IN ACCORDANCE WITH THE LATEST EDITIONS OF THE INTERNATIONAL BUILDING CODES AND THE TEXAS BUILDING CODE.
6. ALL DIMENSIONS ARE TO FACE OF CURB UNLESS OTHERWISE NOTED.
7. ALL DIMENSIONS ARE TO FACE OF CURB UNLESS OTHERWISE NOTED.
8. ALL DIMENSIONS ARE TO FACE OF CURB UNLESS OTHERWISE NOTED.
9. ALL DIMENSIONS ARE TO FACE OF CURB UNLESS OTHERWISE NOTED.
10. ALL DIMENSIONS ARE TO FACE OF CURB UNLESS OTHERWISE NOTED.
11. ALL DIMENSIONS ARE TO FACE OF CURB UNLESS OTHERWISE NOTED.
12. ALL DIMENSIONS ARE TO FACE OF CURB UNLESS OTHERWISE NOTED.
13. ALL DIMENSIONS ARE TO FACE OF CURB UNLESS OTHERWISE NOTED.
14. ALL DIMENSIONS ARE TO FACE OF CURB UNLESS OTHERWISE NOTED.
15. ALL DIMENSIONS ARE TO FACE OF CURB UNLESS OTHERWISE NOTED.
16. ALL DIMENSIONS ARE TO FACE OF CURB UNLESS OTHERWISE NOTED.
17. ALL DIMENSIONS ARE TO FACE OF CURB UNLESS OTHERWISE NOTED.
18. ALL DIMENSIONS ARE TO FACE OF CURB UNLESS OTHERWISE NOTED.
19. ALL DIMENSIONS ARE TO FACE OF CURB UNLESS OTHERWISE NOTED.
20. ALL DIMENSIONS ARE TO FACE OF CURB UNLESS OTHERWISE NOTED.



PROJECT DATA

OWNER: SOUTHEASTERN MEDICAL CENTER
 ARCHITECT: PARK KEY & PARTNERS ARCHITECTS
 DATE: 03/13/88
 SHEET NO.: 59A

REVISIONS

NO.	DATE	DESCRIPTION
1	03/13/88	ISSUED FOR PERMIT
2	03/13/88	ISSUED FOR PERMIT
3	03/13/88	ISSUED FOR PERMIT
4	03/13/88	ISSUED FOR PERMIT
5	03/13/88	ISSUED FOR PERMIT
6	03/13/88	ISSUED FOR PERMIT
7	03/13/88	ISSUED FOR PERMIT
8	03/13/88	ISSUED FOR PERMIT
9	03/13/88	ISSUED FOR PERMIT
10	03/13/88	ISSUED FOR PERMIT
11	03/13/88	ISSUED FOR PERMIT
12	03/13/88	ISSUED FOR PERMIT
13	03/13/88	ISSUED FOR PERMIT
14	03/13/88	ISSUED FOR PERMIT
15	03/13/88	ISSUED FOR PERMIT
16	03/13/88	ISSUED FOR PERMIT
17	03/13/88	ISSUED FOR PERMIT
18	03/13/88	ISSUED FOR PERMIT
19	03/13/88	ISSUED FOR PERMIT
20	03/13/88	ISSUED FOR PERMIT

APPROVED BY
 CITY COUNCIL
 031348
 17809
 03/13/88
 2383-149/1005-S
 PD # 59

SOUTHEASTERN MEDICAL OFFICE BUILDING

SOUTHEASTERN MEDICAL JOINT VENTURE



PARK KEY & PARTNERS Architects
 300 Union Station
 Dallas, Texas 75201
 214/762-6700