

TRAFFIC Z190-367 MANAGEMENT PLAN



Hunter W. Lemley

ST. PHILIP'S SCHOOL
CITY OF DALLAS

Introduction

The services of **Pacheco Koch** (PK) were retained by **St. Philip's School and Community Center** to prepare a Traffic Management Plan (TMP) for zoning approval in the City of Dallas for the St. Philip's School (the "School") located at 1600 Pennsylvania Avenue in Dallas, Texas. This TMP is site-specific and relates to the peak traffic activity associated with school traffic at the site.

School Description

- Type: Existing Private School
- Address: 1600 Pennsylvania Avenue
- Grades: PreK-6th
- Start/End Times:
 - 8:00 AM – 3:30 PM (Pre-Kindergarten – Kindergarten)
 - 8:00 AM – 3:45 PM (1st – 6th)
- Existing Zoning/Proposed Zoning: PD 597/Amendment of Existing PD
- Existing Enrollment: 228 Students
- Future Enrollment: No change

School Access

- Adjacent Streets:
 - Pennsylvania Avenue: Two lanes, two-way operation, no median
 - I-45 Frontage Road: Two lanes, one-way frontage road, no median
- Projected Travel Modes:



7557 Rambler Road, Suite 1400
Dallas, Texas 75231-2388
(972) 235-3031 www.pkce.com
TX.REG: ENGINEERING FIRM F-469
TX. REG. SURVEYING FIRM LS-100080-00

December 17, 2020

- Bus: 0%
- Walk: 0%
- After-School Care: 60%
- Picked Up by Parent: 40%

*Enrollment and Travel Mode Data provided by St. Philip's School and Community Center

NOTE: Pedestrian infrastructure improvements at all active crosswalks on Pennsylvania Avenue will be required at permitting.

Traffic Management Operations

Parent traffic is to approach the campus from the I-45 Frontage Road, adjacent to the school building and enter the site via the only driveway on the frontage road. Ingress traffic shall queue internally as shown on **Exhibit 1** and **Exhibit 2** in a one-way, counterclockwise directional flow. Actual unloading/loading shall occur northeast of the school building for Pre-Kindergarten – Kindergarten and northwest of the school building for 1st – 6th grades.

Parent and student traffic are to exit the campus by continuing west and exit onto Pennsylvania Avenue after the vehicle has sufficiently unloaded/loaded the student(s) out of/into the vehicle. Dismissal will consist of two separate dismissal groups. The first dismissal group will be Pre-Kindergarten and Kindergarten and the second dismissal group will be 1st through 6th grades.

Special Event Traffic and Parking Management

Due to the occasional event that occurs on the campus that results in a high volume of people to the school, valet parking is operational for guests (such as parents and other visitors) for special events that occur outside of normal school hours. The valet service operates in front of the school building where guests arrive in front of the building while their vehicles are retrieved by valet services as the vehicle is then parked in the existing parking lot north of Pennsylvania Avenue, adjacent to the school.

Guests for all other special events are expected to park at the existing parking lot north of Pennsylvania Avenue. Guests then cross the existing mid-block crosswalk on Pennsylvania Avenue located between Holmes Street and Colonial Avenue to arrive at the building. Sidewalk connectivity and signage and markings for the existing crosswalks along with appropriate ADA compliant ramps are provided for the crossing of Pennsylvania Avenue.

School Administration Input Statement

The site engineer, the architect and the traffic engineer have collaborated the traffic patterns of parent routes, bus routes, and recommendations of the TMP with the on-site personnel. The onsite personnel have completed a thorough review and any changes that have been discussed have been applied to this version of the plan. Assessment and evaluation of traffic operations discussed with Dr. Terry J. Flowers occurred on Friday, October 16, 2020.

December 17, 2020

TRAFFIC MANAGEMENT PLAN

On-site dismissal observations were conducted on Tuesday, March 3, 2020. A summary of existing conditions is provided below:

- Parent pick-up activity currently occurs within the site. Also, Parent pick-up activity extends out along the I-45 Frontage Road adjacent to the school building.
- A small number of students are picked up by vans from within the queue line.
- 60% of students will attend an after-school program that includes enrichment activities that take place on campus after the school release period. Students attending these after-school programs are picked up from a two-hour pick-up window.
- Staff and Visitor Parking occurs in the parking lot just north of the school building.
- No students walk to and from the school building at release times.

All the above operations will continue to be as part of the proposed Traffic Management Plan except for the following operations:

1. Release period will be separated into two separate dismissal groups.
2. The second release period (Grades 1st – 6th) will exit the site from the western most driveway on Pennsylvania Avenue.

A graphical summary of specific recommendations and proposed conditions is depicted in **Exhibit 1** (Pre-K through K) and **Exhibit 2** (1st Grade through 6th Grade).

December 17, 2020

Acknowledgement Statement

REVIEW AND COMMITMENT

This school traffic management plan (TMP) for St. Philip's School and Community Center was developed with the intent of optimizing safety and efficiently accommodating vehicular traffic generated during the school's typical student drop-off and pick-up periods. This plan was developed with direct input from individuals familiar with the general characteristics of the traffic needs of the school. It is important to note that a concerted and ongoing effort by and the full participation of the school administration are essential to accomplish these goals.

By the endorsement provided below, the school administration hereby agrees to implement, adhere to, and support the strategies presented in this TMP for which the school is held responsible until or unless the City of Dallas deems those strategies are no longer necessary or that other measures are more appropriate.

Signature

4/26/21
Date

Name: Terry J. Flowers

Title: Exec. Director

END OF MEMO

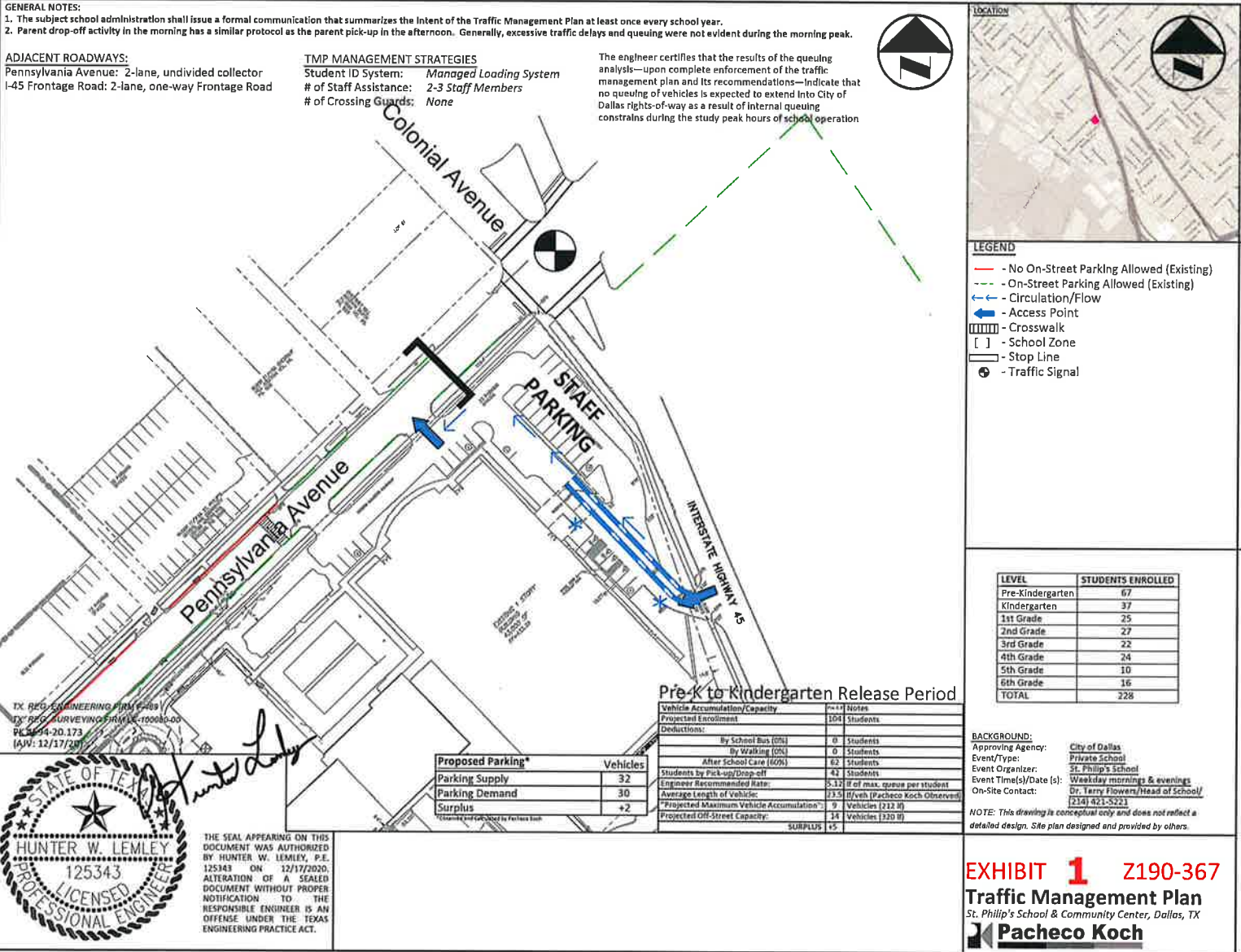

EXHIBIT 1 Z190-367
Traffic Management Plan
 St. Philip's School & Community Center, Dallas, TX
Pacheco Koch

GENERAL NOTES:

1. The subject school administration shall issue a formal communication that summarizes the intent of the Traffic Management Plan at least once every school year.
2. Parent drop-off activity in the morning has a similar protocol as the parent pick-up in the afternoon. Generally, excessive traffic delays and queuing were not evident during the morning peak.

ADJACENT ROADWAYS:

Pennsylvania Avenue: 2-lane, undivided collector
I-45 Frontage Road: 2-lane, one-way Frontage Road

TMP MANAGEMENT STRATEGIES

Student ID System: *Managed Loading System*
of Staff Assistance: *2-3 Staff Members*
of Crossing Guards: *None*

The engineer certifies that the results of the queuing analysis—upon complete enforcement of the traffic management plan and its recommendations—indicate that no queuing of vehicles is expected to extend into City of Dallas rights-of-way as a result of internal queuing constrains during the study peak hours of school operation



LEGEND

- No On-Street Parking Allowed (Existing)
- On-Street Parking Allowed (Existing)
- Circulation/Flow
- Access Point
- Crosswalk
- School Zone
- Stop Line
- Traffic Signal
- Traffic Cone

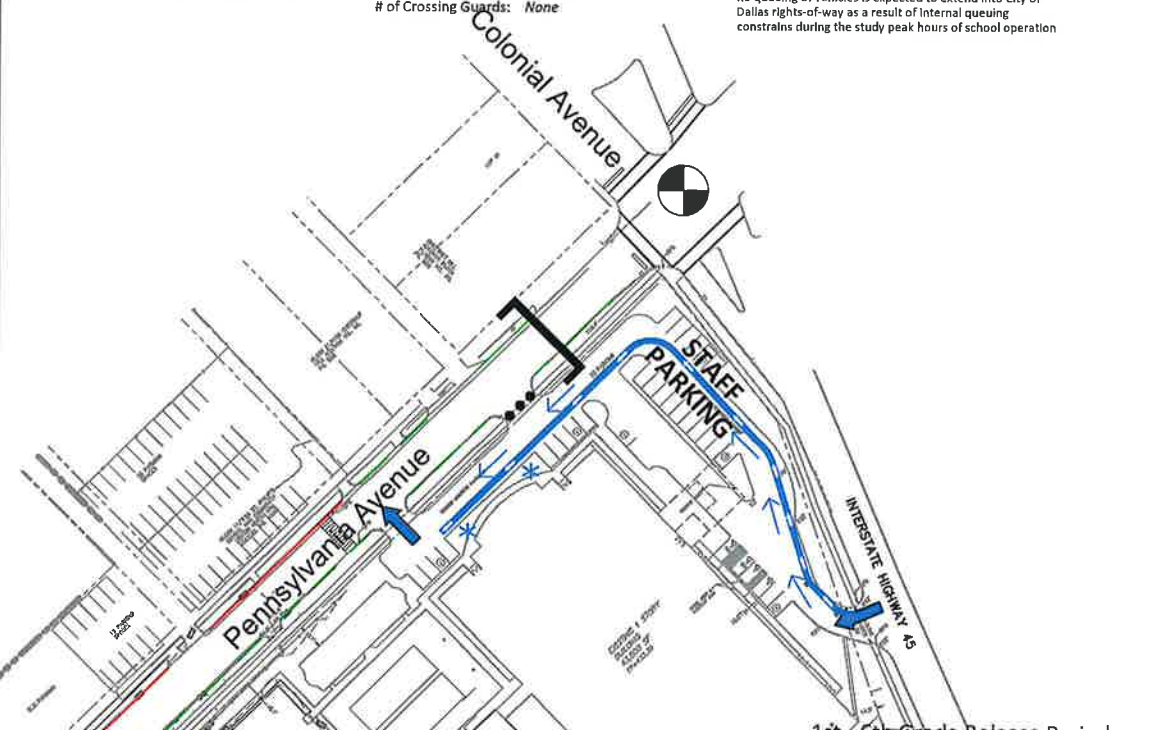

TX REG. ENGINEERING FIRM # 4891
 TX REG. SURVEYING FIRM # 100080-00
 PL 24-20-173
 (AW: 12/17/20)

1st-6th Grade Release Period

Vehicle Accumulation/Capacity	(in #)	Notes
Projected Enrollment	124	Students
Deductions:		
By School Bus (0%)	0	Students
By Walking (0%)	0	Students
After School Care (60%)	74	Students
Students by Pick-up/Drop-off	50	Students
Engineer Recommended Rate:	5.12	# of max. queue per student
Average Length of Vehicle:	21.5	#/veh (Pacheco Koch Observat)
Projected Maximum Vehicle Accumulation:	11	Vehicles (250 ft)
Projected On-Street Capacity:	18	Vehicles (120 ft)
	SURPLUS	+3

Proposed Parking*	Vehicles
Parking Supply	32
Parking Demand	30
Surplus	+2

LEVEL	STUDENTS ENROLLED
Pre-Kindergarten	67
Kindergarten	37
1st Grade	25
2nd Grade	27
3rd Grade	22
4th Grade	24
5th Grade	30
6th Grade	16
TOTAL	228

BACKGROUND:
 Approving Agency: City of Dallas
 Event/Type: Private School
 Event Organizer: St. Philip's School
 Event Time(s)/Date (s): Weekday mornings & evenings
 On-Site Contact: Dr. Terry Flowers/Head of School/
 (214) 421-5221

NOTE: This drawing is conceptual only and does not reflect a detailed design. Site plan designed and provided by others.



THE SEAL APPEARING ON THIS DOCUMENT WAS AUTHORIZED BY HUNTER W. LEMLEY, P.E. 125343 ON 12/17/2020. ALTERATION OF A SEALED DOCUMENT WITHOUT PROPER NOTIFICATION TO THE RESPONSIBLE ENGINEER IS AN OFFENSE UNDER THE TEXAS ENGINEERING PRACTICE ACT.

EXHIBIT 2 Z190-367
Traffic Management Plan
 St. Philip's School & Community Center, Dallas, TX
Pacheco Koch