

**PERKINS
+ WILL**

1610 North Central Expressway
Dallas, Texas 75201
Tel: 214.760.2000
Fax: 214.760.2001
www.perkinswill.com

**WHITE ROCK
ELEMENTARY
SCHOOL**

**RICHARDSON
INDEPENDENT
SCHOOL DISTRICT**
9229 CHISWELL ROAD
DALLAS, TEXAS

ARCHITECT: DANIEL B. GAY
TX LICENSE: 18643
ISSUED: MAY 05, 2017
REVISION OR
CONSTRUCTION

Sheet Information	
Date	09/07/2017
Job Number	150091000
Drawn	TAM
Checked	DM
Approved	DM
Discipline	PLN

**DEVELOPMENT
PLAN**

SHEET

FOR INFORMATION ONLY

2107-894
Copyright © 2017

<p>LEGEND</p> <ul style="list-style-type: none"> PROPOSED ADDITION EXISTING PROPERTY EASEMENT PROPERTY LINE OWNER LINE 30' BUILDING SET BACK LINE 	<p>NOTES</p> <p>SEE PLAT FOR ADDITIONAL NOTES. ALL DIMENSIONS OF AREAS IS SHOWN ARE TO BE MAINTAINED. ALL DIMENSIONS SHOWN ARE TO BE MAINTAINED. ALL DIMENSIONS SHOWN ARE TO BE MAINTAINED.</p>	<p>NOTES BY NUMBER</p> <p>① LOT #105 ② CORNER 304</p>	<p>SITE SUMMARY</p> <p>LAND AREA: 10.0629 ACRES (430,381 SQFT) EXISTING BUILDING AREA: 73,737 SQFT ADDITION AREA: 54,283 SQFT TOTAL CLASSROOMS: 52 MAXIMUM HEIGHT: 40' NUMBER OF STORES: 1 REQUIRED PARKING SPACES (1.5 PER CLASSROOM): 78 MINIMUM LOT COVERAGE = 60% ACTUAL LOT COVERAGE = 30%</p>	<p>VICINITY MAP</p>
--	--	--	--	----------------------------

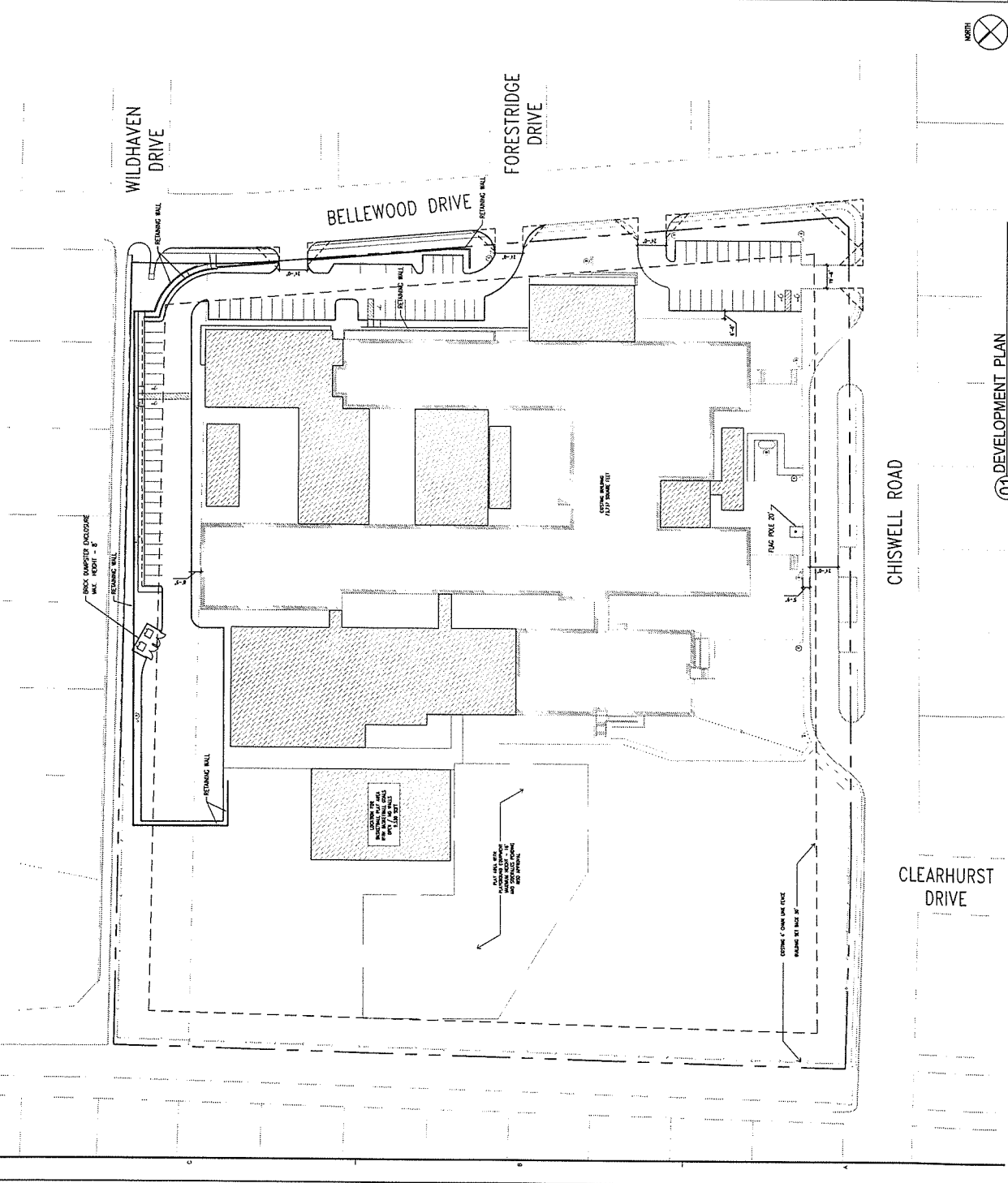

① DEVELOPMENT PLAN
15-08-07