

24015

95856
A-1

Development/Landscape Plan for the
TR. HOOVER COMMUNITY CENTER
for the IDEAL NEIGHBORHOOD
DALLAS, TEXAS

NEAL LACEY - ALLEN PERCE - J. MARK BARRY
3027 HAWK LAKE DRIVE
DALLAS, TEXAS 75220
214 359 0888 (97 214 359 8711 07)

EXHIBIT 557A

Z989-256/8546-SE (MB)

PLANNED DEVELOPMENT DISTRICT NO. 557

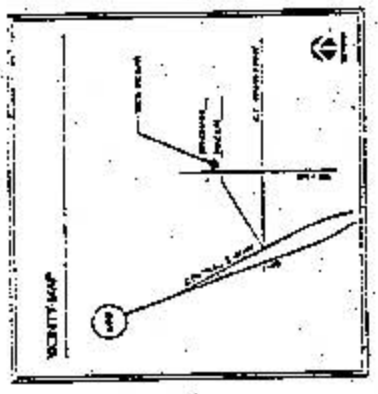

SITE INFORMATION

TOTAL LOT AREA: 339,964 SQ. FT.
 SUBDIVISION AREA: 339,964 SQ. FT.
 PERCENTAGE OF IMPROVEMENT: 88%
 PERCENTAGE OF IMPROVED LOT: 88%
 COVERED AREA:

LANDSCAPE INFORMATION

PLANT	QUANTITY	REMARKS
...

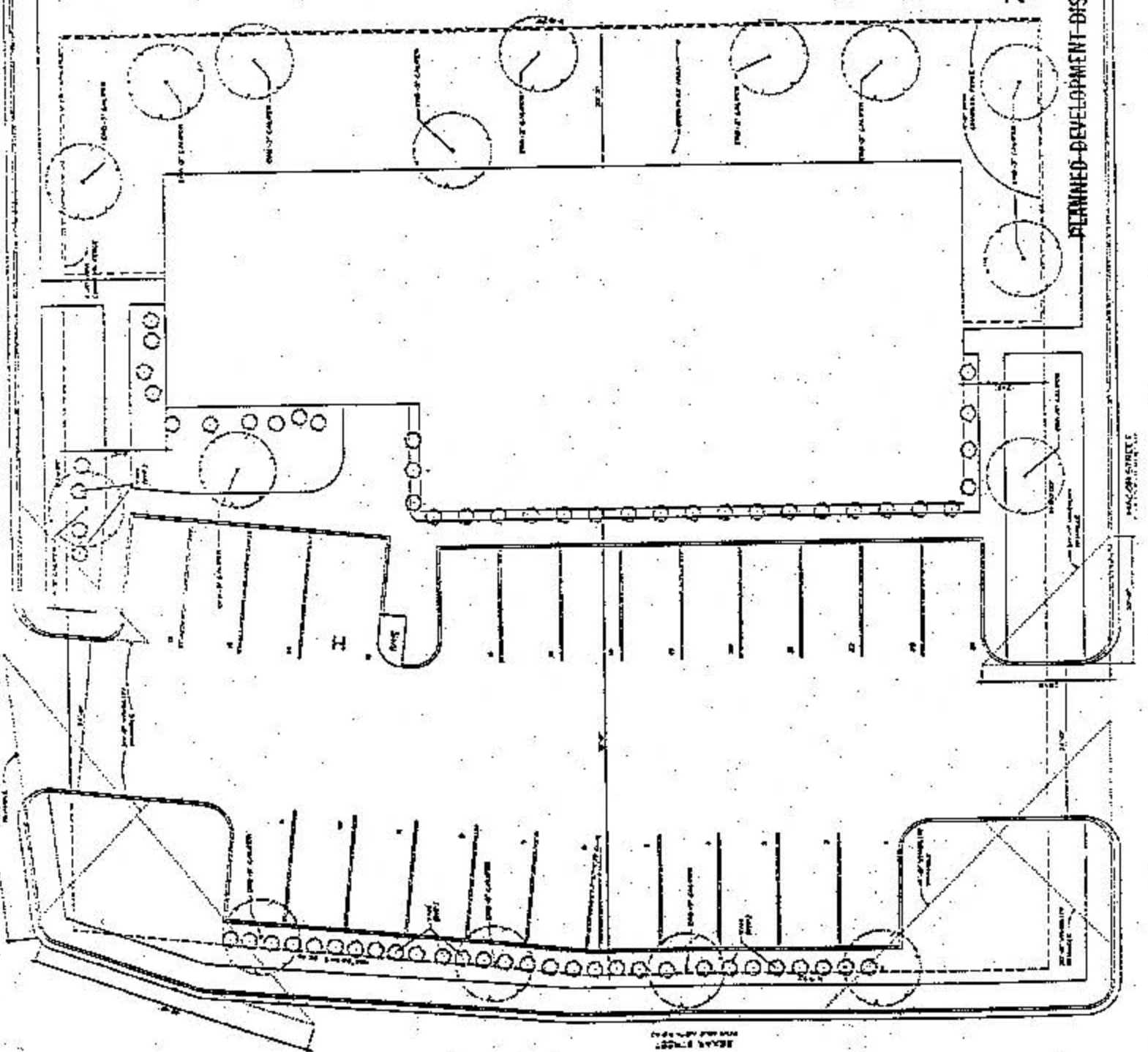

NEAL LACEY - ALLEN PERCE - J. MARK BARRY