

32086

212043

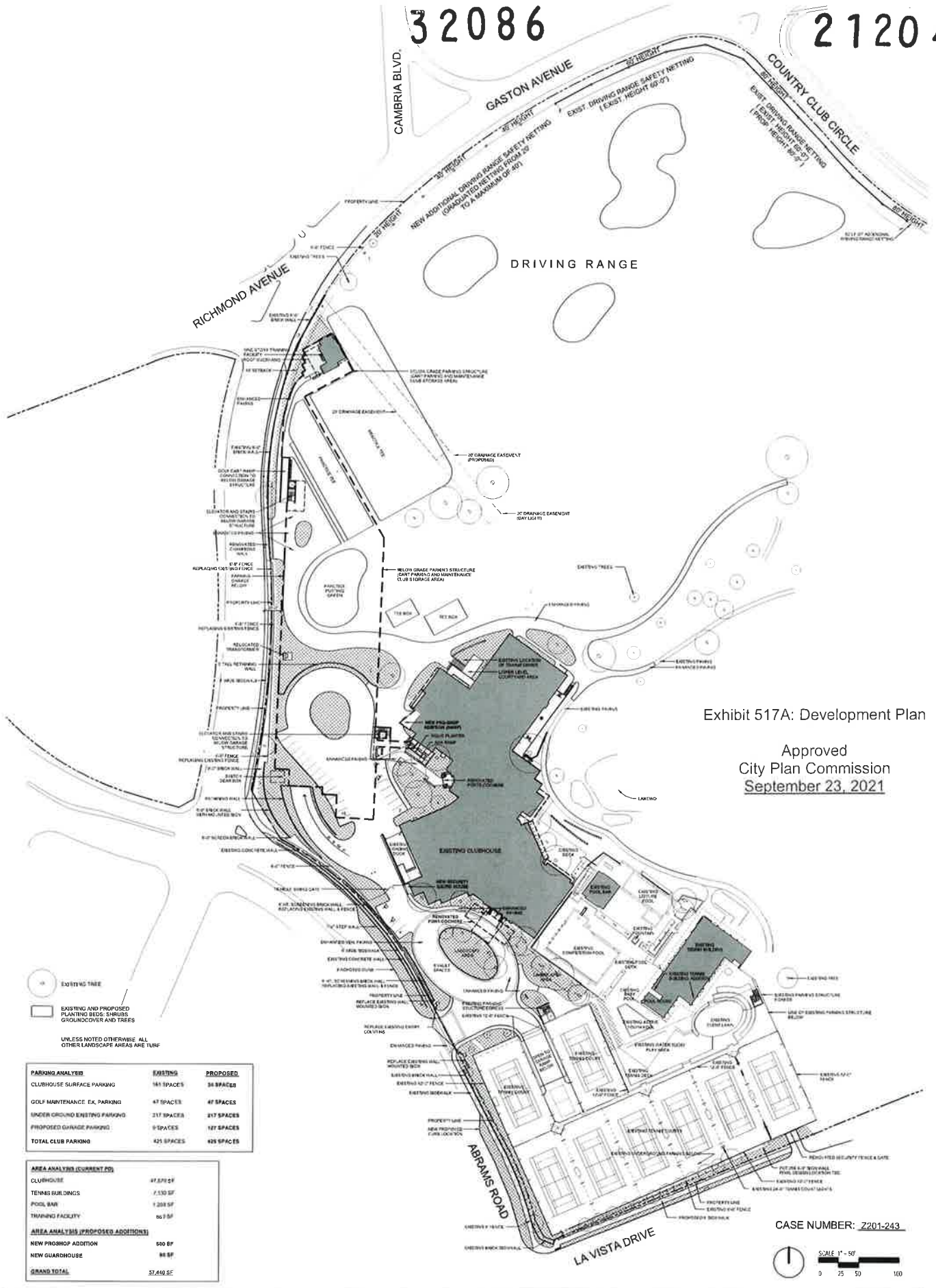

Exhibit 517A: Development Plan
 Approved
 City Plan Commission
 September 23, 2021

PARKING ANALYSIS	EXISTING	PROPOSED
CLUBHOUSE SURFACE PARKING	161 SPACES	36 SPACES
GOLF MAINTENANCE EX. PARKING	47 SPACES	47 SPACES
SENDER GROUND EXISTING PARKING	217 SPACES	217 SPACES
PROPOSED GARAGE PARKING	0 SPACES	127 SPACES
TOTAL CLUB PARKING	425 SPACES	425 SPACES

AREA ANALYSIS (CURRENT PD)	
CLUBHOUSE	47,876 SF
TENNIS BUILDINGS	7,130 SF
POOL BAR	1,208 SF
TRAINING FACILITY	167 SF
AREA ANALYSIS (PROPOSED ADDITIONS)	
NEW PROSHOP ADDITION	500 SF
NEW GUARDHOUSE	88 SF
GRAND TOTAL	57,499 SF

CASE NUMBER: Z201-243
 SCALE 1" = 50'
 0 25 50 100

DEVELOPMENT PLAN- EXHIBIT 517A, Page 2, Phase 1

DALLAS, TEXAS
 1912 Abrams Road, Dallas, TX 75214

PROJECT #: 18012.00 DRAWN BY: TA DATE: 6.7.2021 PRINTED: 6.7.2021



Talley Associates
 1925 San Jacinto, Suite 400
 Dallas, TX 75201
 T: 214-871-7800

