

A DEVELOPMENT/CONCEPTUAL PLAN
SCALE: 1" = 50'-0"

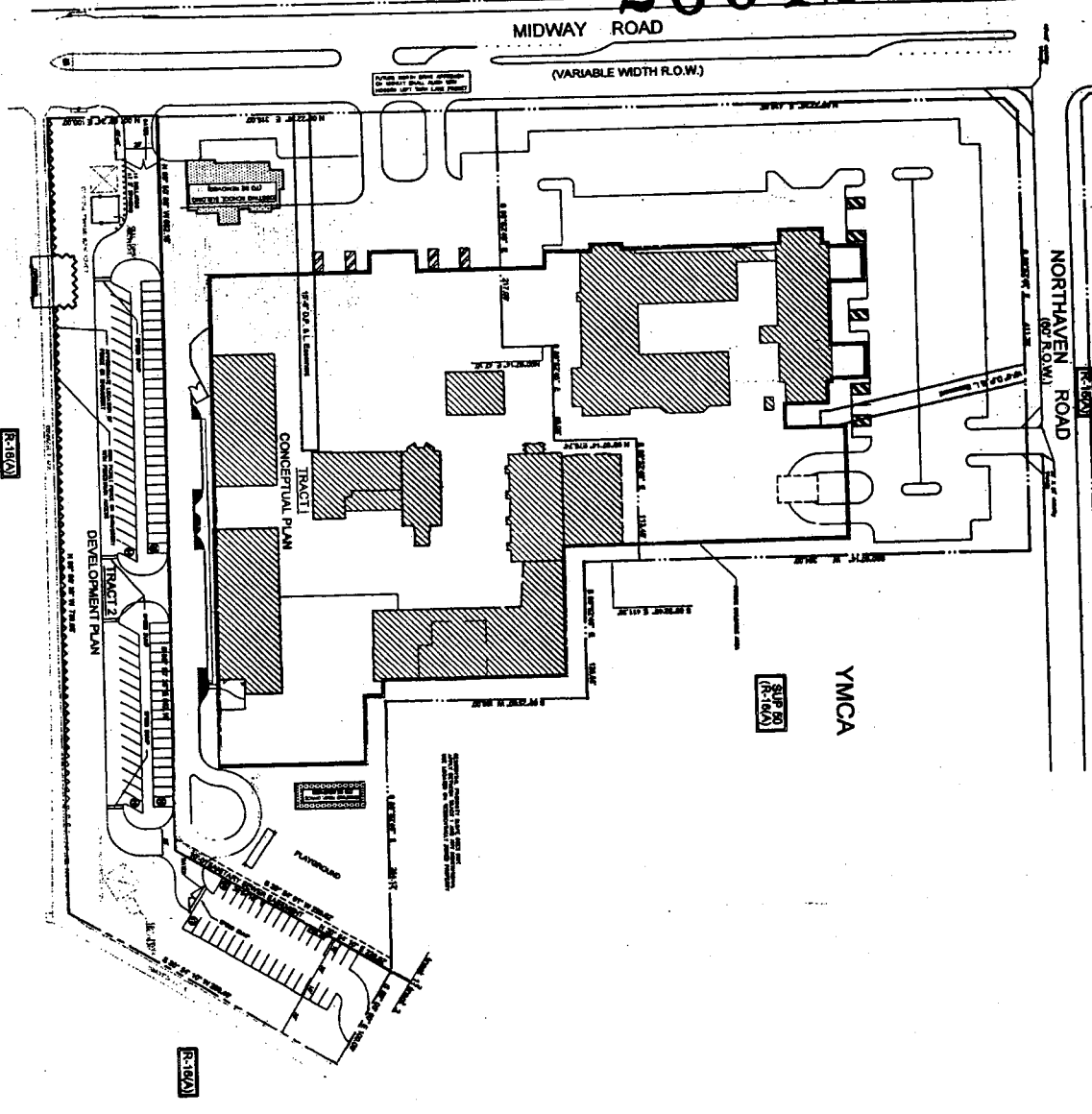

KEY
 EXISTING STRUCTURES
 EXISTING STRUCTURES TO BE REMOVED

OWNER AND APPLICANT
 GOOD SHEPHERD EPISCOPAL SCHOOL
 11122 MIDWAY ROAD
 DALLAS, TEXAS 75244
 PROJECT NO. 2034-298
 DATE: 4-28-95

SITE NOTES
 1. ALL EXISTING UTILITIES TO BE MAINTAINED AND PROTECTED.
 2. ALL NEW UTILITIES TO BE INSTALLED AS SHOWN.
 3. ALL CONSTRUCTION TO BE IN ACCORDANCE WITH THE CITY OF DALLAS ORDINANCES.
 4. ALL DISTURBED AREAS TO BE RESTORED TO ORIGINAL OR BETTER CONDITION.
 5. ALL EROSION CONTROL MEASURES TO BE INSTALLED AND MAINTAINED THROUGHOUT CONSTRUCTION.
 6. ALL TRUCK TRAFFIC TO BE LIMITED TO THE EXISTING DRIVEWAYS.
 7. ALL MATERIALS TO BE STORED IN THE EXISTING STORAGE AREAS.
 8. ALL WASTE MATERIALS TO BE REMOVED FROM THE SITE.
 9. ALL NEIGHBORS TO BE NOTIFIED OF CONSTRUCTION ACTIVITIES.
 10. ALL CONSTRUCTION TO BE COMPLETED WITHIN THE SPECIFIED TIME FRAME.

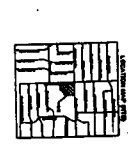

DALLAS RECORDING SERVICE NO. 594
 DEVELOPER: GOOD SHEPHERD EPISCOPAL SCHOOL
 DATE: 4-28-95

D/C-01
 Drawing Title: DEVELOPMENT/CONCEPTUAL PLAN
 Drawing Number: 2034-298
 Date: 12/14/95
 Drawn By: CPM
 Checked By: CPM
 Title: 4-28-95

GOOD SHEPHERD EPISCOPAL SCHOOL
 11122 MIDWAY ROAD
 DALLAS, TEXAS

