

26042
23309

EXHIBIT 489A

SPRING PLAZA

A DEVELOPMENT OF
ENERGITY COMPANY DEVELOPMENT CORPORATION
2800 MARTIN LUTHER KING BLVD.
DALLAS, TEXAS 75215

973484

DATE: 9-25-67
BY: [Signature]
TITLE: [Title]
PROJECT: [Project Name]

TABULATION

General Bldg. - 65,185
Proposed Bldg. - Planned Development
TRACT 1 - 8.83 ACRES 24,811 SQ. FT.
CALCARE - 5,000 SQ. FT.
Lot Coverage - 25%
Minimum Height - 8' (7' Min)
Parking - 1,785 SQ. FT. - 13 Spaces
TRACT 2 - 1.45 ACRES 9,927 SQ. FT.
CALCARE - 1,500 SQ. FT.
Lot Coverage - 25%
Minimum Height - 8' (7' Min)
Parking (Total) - 1,785 - 13 Spaces
Total Parking - 26 Spaces

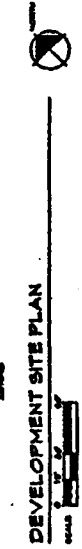
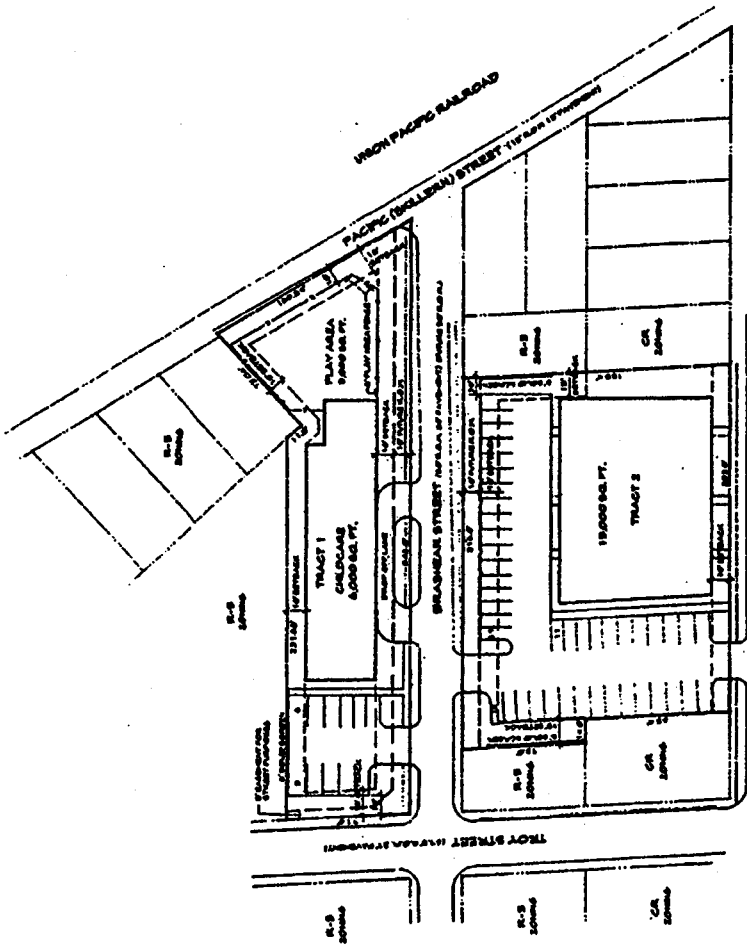

Approved
City Plan Commission

9-25-67

PLANNED DEVELOPMENT DISTRICT NO. 489

7967-300/10374-5E(KC)