

L-35 S FRONTAGE ROAD

972042

23170

EXHIBIT 479A

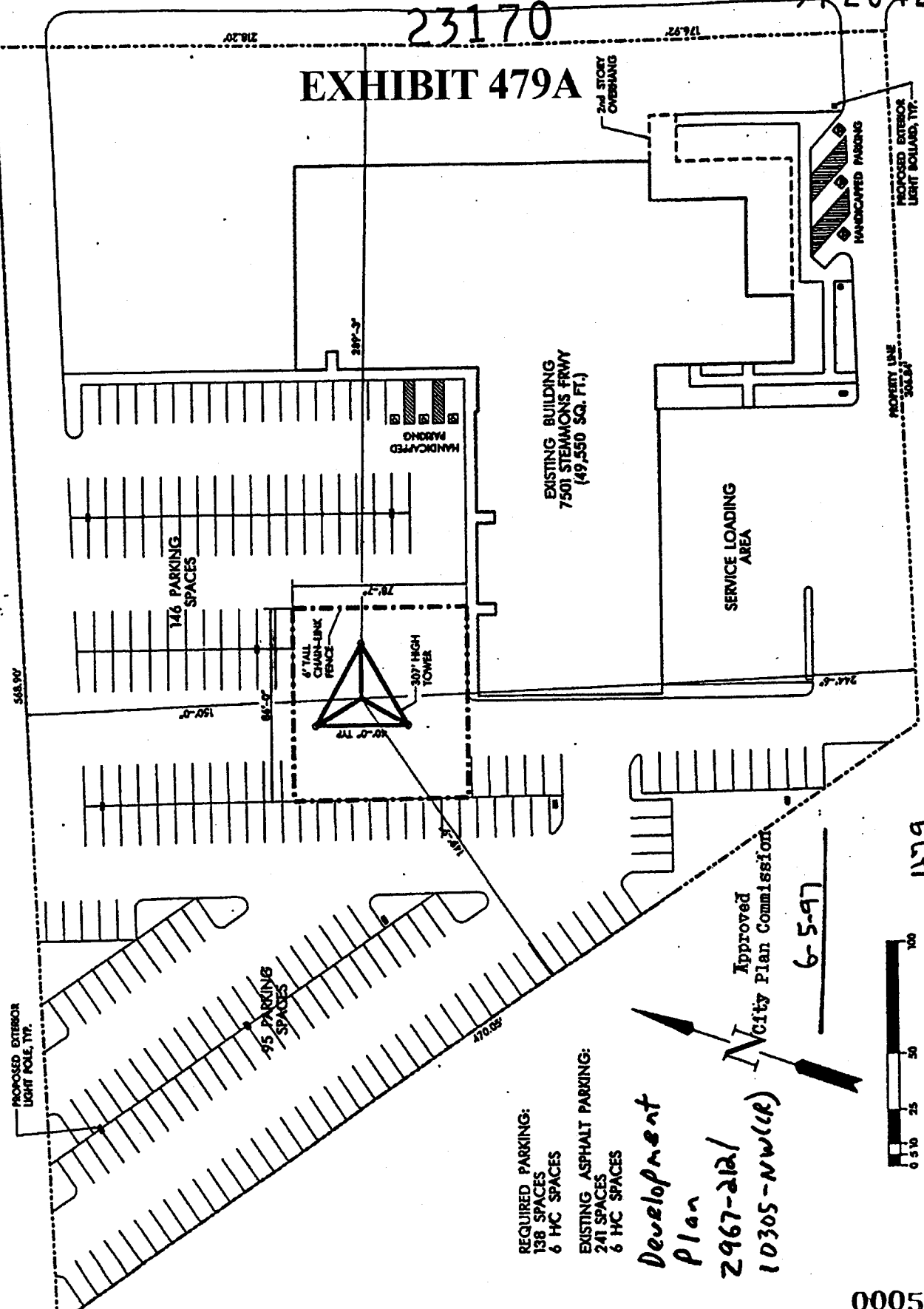

REQUIRED PARKING:
 138 SPACES
 6 HC SPACES

EXISTING ASPHALT PARKING:
 241 SPACES
 6 HC SPACES

Development Plan
 2967-212/1
 10305-NW(1R)

Approved
 City Plan Commission
 6-5-97



PLANNED DEVELOPMENT DISTRICT NO. 479