

**OWNER**  
 HOUSTON INDEPENDENT SCHOOLS DISTRICT  
 1500 S. HOUSTON BLVD.  
 HOUSTON, TX 77058

**ARCHITECT**  
 HKS, INC.  
 3300 S. MORTIMER BLVD., SUITE 100  
 HOUSTON, TX 77058

**STRUCTURAL ENGINEER**  
 TERRY BRANT PAULI, DATE 1/10  
 1500 S. HOUSTON BLVD.  
 HOUSTON, TX 77058

**MEP ENGINEER**  
 HKS, INC.  
 3300 S. MORTIMER BLVD., SUITE 100  
 HOUSTON, TX 77058

**CIVIL ENGINEER**  
 HKS CONSULTING ENGINEERS  
 1500 S. HOUSTON BLVD., SUITE 100  
 HOUSTON, TX 77058

**LANDSCAPE ARCHITECT**  
 CELIA ANDERSON  
 1500 S. HOUSTON BLVD., SUITE 100  
 HOUSTON, TX 77058

# LAKE HIGHLANDS HIGH SCHOOL ADDITION AND RENOVATION

## 31065



NO. \_\_\_\_\_ DATE \_\_\_\_\_  
 REVISION DESCRIPTION  
 PROJECT NUMBER  
 XXXXX  
 DATE  
 016 AUGUST, 2016  
 TITLE  
 PD 467 - CITY OF DALLAS  
 PROJECT  
 PD LANDSCAPE  
 PLAN  
 SHEET NO.  
**L100**  
 81844

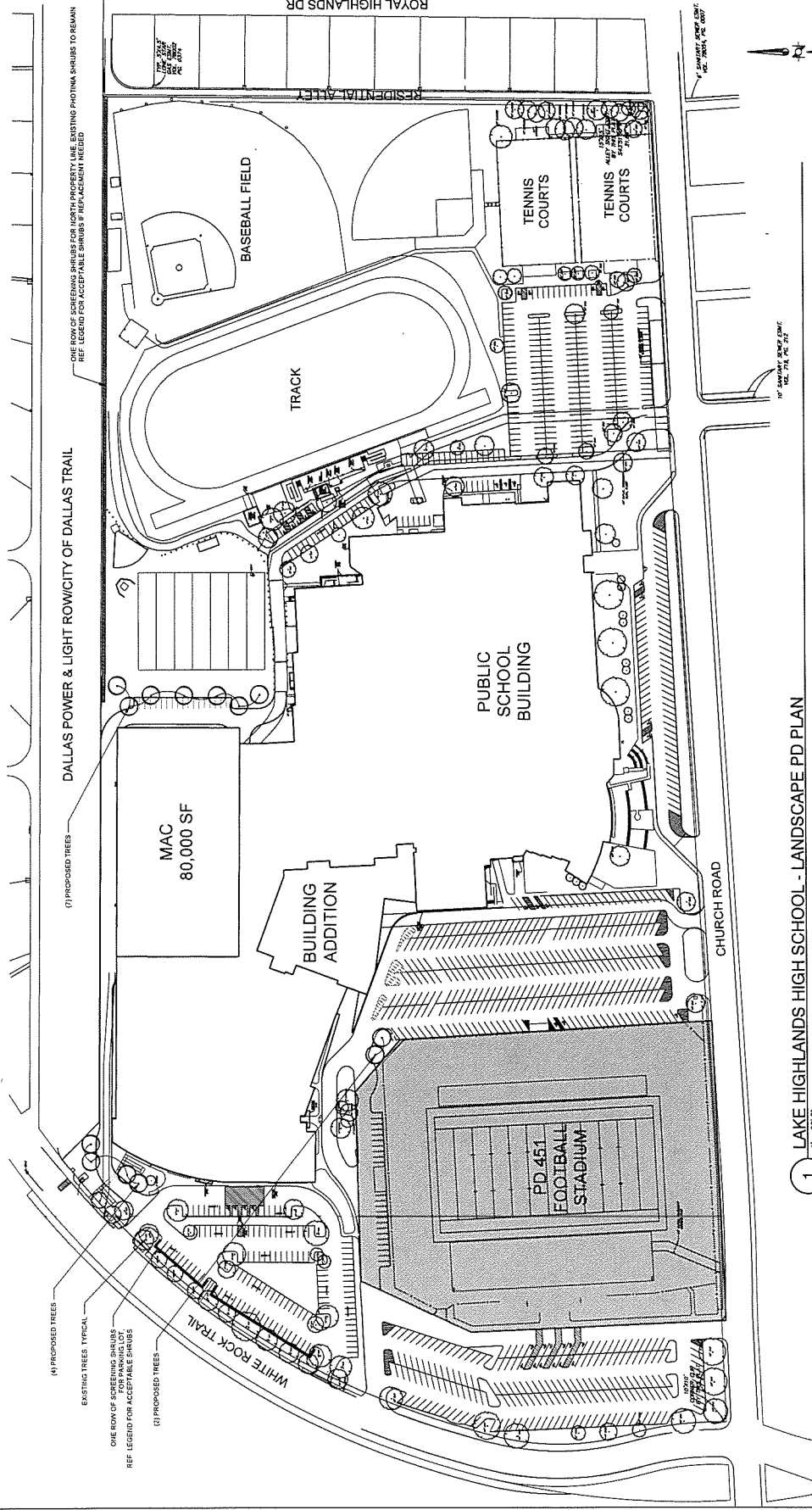

**INTERIM REVIEW ONLY**  
 This document is preliminary, and  
 is not for construction purposes.  
 It is subject to change without  
 notice. It is the responsibility of  
 the user to verify the accuracy  
 and completeness of the information  
 contained herein.  
 Date: 08-29-2016

**Exhibit 467B**  
**Planned Development**  
**District No. 467**

**Z178-317**  
 © 2017 HKS, INC.

- LEGEND**
- EXISTING SHADE (CAMPOXY TREE)
  - REPLACE WITH 3" CAMPER TREE FROM LIST BELOW
    - TEXAS SH FRAXINUS TEXENSIS
    - TEXAS SH FRAXINUS TEXENSIS
    - LACINAK ELM (ULMUS PARVIFLORA)
    - BUR OAK (QUERCUS MACROCARPA)
    - SHUMARD OAK (QUERCUS SHUMARDII)
    - REDFLOW OAK (QUERCUS CUNNINGHAMII)
    - BALD CYPRESS (TAXODIUM DISTICHOM)
  - PROPOSED SHADE (CAMPOXY TREE) FOR NEW PROPERTY/OWNER/UTIL.
    - TEXAS SH FRAXINUS TEXENSIS
    - LACINAK ELM (ULMUS PARVIFLORA)
    - BUR OAK (QUERCUS MACROCARPA)
    - SHUMARD OAK (QUERCUS SHUMARDII)
    - REDFLOW OAK (QUERCUS CUNNINGHAMII)
    - BALD CYPRESS (TAXODIUM DISTICHOM)
  - EXISTING OR PROPOSED ORNAMENTAL TREE (3" CALIPER MIN.)
    - DESERT YALOW (CHLOEZE LINEARIS)
    - GRAND PRINCE (LACINAK ROSA INDIKA)
    - EVER GREEN (LANTANA)
    - SHRUB TREE (ANDROMEDA VITIFOLIA)
    - GRABITALE (YALOW PARASPERME)
    - BUCKLEBUSH (COLLEA FOLIOLATA)
    - BUCKLEBUSH (VIBURNUM RUFIDULUM)
    - SCREENING SHRUBS FOR PARKING LOT - EVERGREEN
      - INDIAN BAYBORN (PARACLYPTIS INDICA)
      - TEXAS SAGE (LEUCOPHYLLUM FRUTICOSUM)
      - SCREENING SHRUBS FOR NORTH PROPERTY LINE - EVERGREEN ONLY
        - HELIOPSIS SCOTTS HOLLY (ILEX Y. WELLS P. STRONG)
        - BARBERRY (LIGULARIA STRONGII)

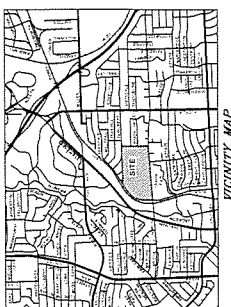

Approved  
 City Plan Commission  
 October 18, 2018

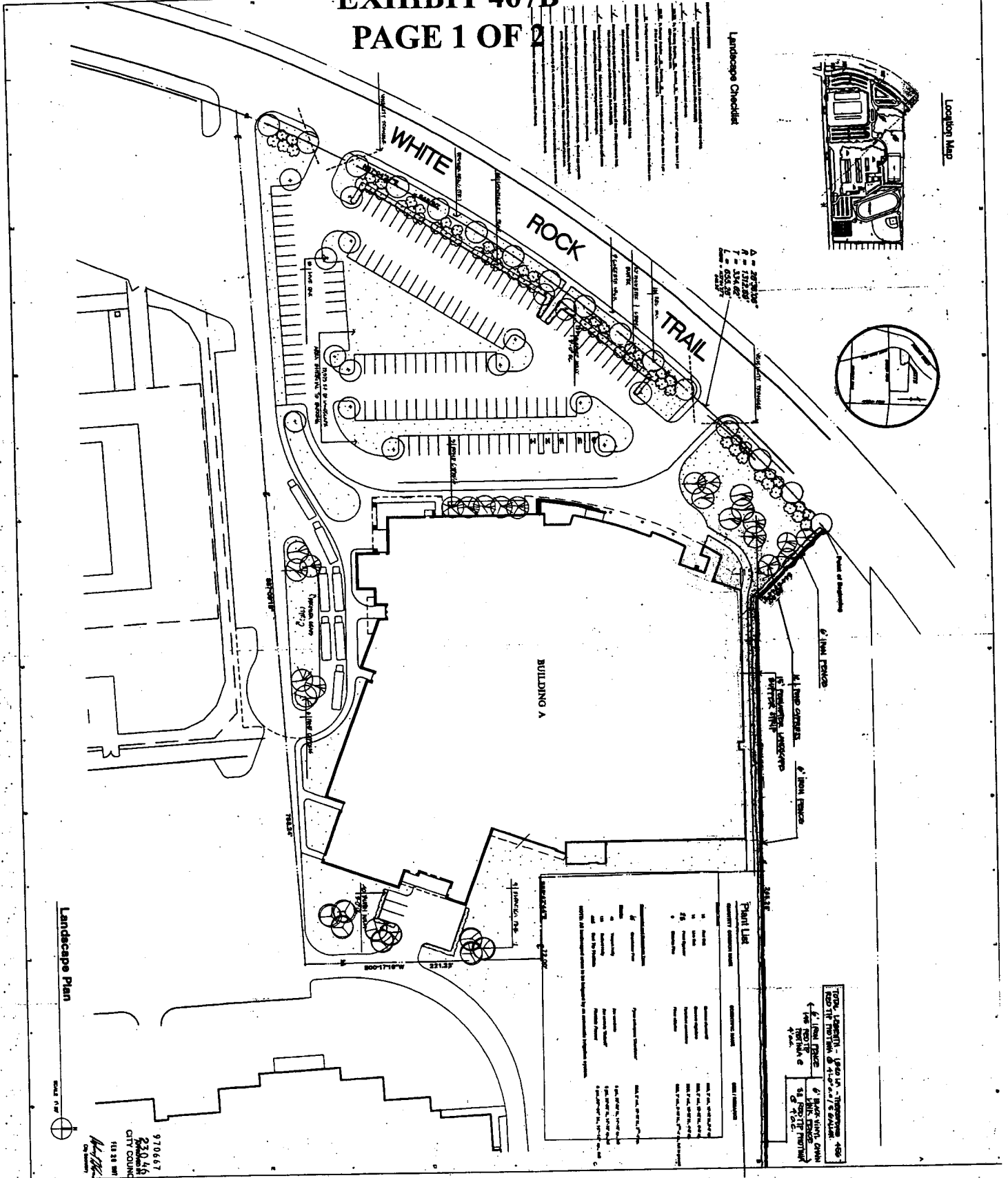

Landscape Checklist

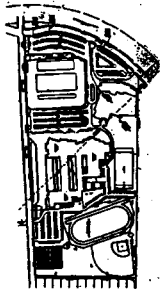

1 - 2' 0" PLANTER  
2 - 2' 0" PLANTER  
3 - 2' 0" PLANTER  
4 - 2' 0" PLANTER  
5 - 2' 0" PLANTER  
6 - 2' 0" PLANTER  
7 - 2' 0" PLANTER  
8 - 2' 0" PLANTER  
9 - 2' 0" PLANTER  
10 - 2' 0" PLANTER  
11 - 2' 0" PLANTER  
12 - 2' 0" PLANTER  
13 - 2' 0" PLANTER  
14 - 2' 0" PLANTER  
15 - 2' 0" PLANTER  
16 - 2' 0" PLANTER  
17 - 2' 0" PLANTER  
18 - 2' 0" PLANTER  
19 - 2' 0" PLANTER  
20 - 2' 0" PLANTER  
21 - 2' 0" PLANTER  
22 - 2' 0" PLANTER  
23 - 2' 0" PLANTER  
24 - 2' 0" PLANTER  
25 - 2' 0" PLANTER  
26 - 2' 0" PLANTER  
27 - 2' 0" PLANTER  
28 - 2' 0" PLANTER  
29 - 2' 0" PLANTER  
30 - 2' 0" PLANTER  
31 - 2' 0" PLANTER  
32 - 2' 0" PLANTER  
33 - 2' 0" PLANTER  
34 - 2' 0" PLANTER  
35 - 2' 0" PLANTER  
36 - 2' 0" PLANTER  
37 - 2' 0" PLANTER  
38 - 2' 0" PLANTER  
39 - 2' 0" PLANTER  
40 - 2' 0" PLANTER  
41 - 2' 0" PLANTER  
42 - 2' 0" PLANTER  
43 - 2' 0" PLANTER  
44 - 2' 0" PLANTER  
45 - 2' 0" PLANTER  
46 - 2' 0" PLANTER  
47 - 2' 0" PLANTER  
48 - 2' 0" PLANTER  
49 - 2' 0" PLANTER  
50 - 2' 0" PLANTER  
51 - 2' 0" PLANTER  
52 - 2' 0" PLANTER  
53 - 2' 0" PLANTER  
54 - 2' 0" PLANTER  
55 - 2' 0" PLANTER  
56 - 2' 0" PLANTER  
57 - 2' 0" PLANTER  
58 - 2' 0" PLANTER  
59 - 2' 0" PLANTER  
60 - 2' 0" PLANTER  
61 - 2' 0" PLANTER  
62 - 2' 0" PLANTER  
63 - 2' 0" PLANTER  
64 - 2' 0" PLANTER  
65 - 2' 0" PLANTER  
66 - 2' 0" PLANTER  
67 - 2' 0" PLANTER  
68 - 2' 0" PLANTER  
69 - 2' 0" PLANTER  
70 - 2' 0" PLANTER  
71 - 2' 0" PLANTER  
72 - 2' 0" PLANTER  
73 - 2' 0" PLANTER  
74 - 2' 0" PLANTER  
75 - 2' 0" PLANTER  
76 - 2' 0" PLANTER  
77 - 2' 0" PLANTER  
78 - 2' 0" PLANTER  
79 - 2' 0" PLANTER  
80 - 2' 0" PLANTER  
81 - 2' 0" PLANTER  
82 - 2' 0" PLANTER  
83 - 2' 0" PLANTER  
84 - 2' 0" PLANTER  
85 - 2' 0" PLANTER  
86 - 2' 0" PLANTER  
87 - 2' 0" PLANTER  
88 - 2' 0" PLANTER  
89 - 2' 0" PLANTER  
90 - 2' 0" PLANTER  
91 - 2' 0" PLANTER  
92 - 2' 0" PLANTER  
93 - 2' 0" PLANTER  
94 - 2' 0" PLANTER  
95 - 2' 0" PLANTER  
96 - 2' 0" PLANTER  
97 - 2' 0" PLANTER  
98 - 2' 0" PLANTER  
99 - 2' 0" PLANTER  
100 - 2' 0" PLANTER

Plant List

PLANT NAME	QUANTITY	DATE	REVISIONS
1. 2' 0" PLANTER	100	05/19/68	1.0
2. 2' 0" PLANTER	100	05/19/68	1.0
3. 2' 0" PLANTER	100	05/19/68	1.0
4. 2' 0" PLANTER	100	05/19/68	1.0
5. 2' 0" PLANTER	100	05/19/68	1.0
6. 2' 0" PLANTER	100	05/19/68	1.0
7. 2' 0" PLANTER	100	05/19/68	1.0
8. 2' 0" PLANTER	100	05/19/68	1.0
9. 2' 0" PLANTER	100	05/19/68	1.0
10. 2' 0" PLANTER	100	05/19/68	1.0
11. 2' 0" PLANTER	100	05/19/68	1.0
12. 2' 0" PLANTER	100	05/19/68	1.0
13. 2' 0" PLANTER	100	05/19/68	1.0
14. 2' 0" PLANTER	100	05/19/68	1.0
15. 2' 0" PLANTER	100	05/19/68	1.0
16. 2' 0" PLANTER	100	05/19/68	1.0
17. 2' 0" PLANTER	100	05/19/68	1.0
18. 2' 0" PLANTER	100	05/19/68	1.0
19. 2' 0" PLANTER	100	05/19/68	1.0
20. 2' 0" PLANTER	100	05/19/68	1.0
21. 2' 0" PLANTER	100	05/19/68	1.0
22. 2' 0" PLANTER	100	05/19/68	1.0
23. 2' 0" PLANTER	100	05/19/68	1.0
24. 2' 0" PLANTER	100	05/19/68	1.0
25. 2' 0" PLANTER	100	05/19/68	1.0
26. 2' 0" PLANTER	100	05/19/68	1.0
27. 2' 0" PLANTER	100	05/19/68	1.0
28. 2' 0" PLANTER	100	05/19/68	1.0
29. 2' 0" PLANTER	100	05/19/68	1.0
30. 2' 0" PLANTER	100	05/19/68	1.0
31. 2' 0" PLANTER	100	05/19/68	1.0
32. 2' 0" PLANTER	100	05/19/68	1.0
33. 2' 0" PLANTER	100	05/19/68	1.0
34. 2' 0" PLANTER	100	05/19/68	1.0
35. 2' 0" PLANTER	100	05/19/68	1.0
36. 2' 0" PLANTER	100	05/19/68	1.0
37. 2' 0" PLANTER	100	05/19/68	1.0
38. 2' 0" PLANTER	100	05/19/68	1.0
39. 2' 0" PLANTER	100	05/19/68	1.0
40. 2' 0" PLANTER	100	05/19/68	1.0
41. 2' 0" PLANTER	100	05/19/68	1.0
42. 2' 0" PLANTER	100	05/19/68	1.0
43. 2' 0" PLANTER	100	05/19/68	1.0
44. 2' 0" PLANTER	100	05/19/68	1.0
45. 2' 0" PLANTER	100	05/19/68	1.0
46. 2' 0" PLANTER	100	05/19/68	1.0
47. 2' 0" PLANTER	100	05/19/68	1.0
48. 2' 0" PLANTER	100	05/19/68	1.0
49. 2' 0" PLANTER	100	05/19/68	1.0
50. 2' 0" PLANTER	100	05/19/68	1.0
51. 2' 0" PLANTER	100	05/19/68	1.0
52. 2' 0" PLANTER	100	05/19/68	1.0
53. 2' 0" PLANTER	100	05/19/68	1.0
54. 2' 0" PLANTER	100	05/19/68	1.0
55. 2' 0" PLANTER	100	05/19/68	1.0
56. 2' 0" PLANTER	100	05/19/68	1.0
57. 2' 0" PLANTER	100	05/19/68	1.0
58. 2' 0" PLANTER	100	05/19/68	1.0
59. 2' 0" PLANTER	100	05/19/68	1.0
60. 2' 0" PLANTER	100	05/19/68	1.0
61. 2' 0" PLANTER	100	05/19/68	1.0
62. 2' 0" PLANTER	100	05/19/68	1.0
63. 2' 0" PLANTER	100	05/19/68	1.0
64. 2' 0" PLANTER	100	05/19/68	1.0
65. 2' 0" PLANTER	100	05/19/68	1.0
66. 2' 0" PLANTER	100	05/19/68	1.0
67. 2' 0" PLANTER	100	05/19/68	1.0
68. 2' 0" PLANTER	100	05/19/68	1.0
69. 2' 0" PLANTER	100	05/19/68	1.0
70. 2' 0" PLANTER	100	05/19/68	1.0
71. 2' 0" PLANTER	100	05/19/68	1.0
72. 2' 0" PLANTER	100	05/19/68	1.0
73. 2' 0" PLANTER	100	05/19/68	1.0
74. 2' 0" PLANTER	100	05/19/68	1.0
75. 2' 0" PLANTER	100	05/19/68	1.0
76. 2' 0" PLANTER	100	05/19/68	1.0
77. 2' 0" PLANTER	100	05/19/68	1.0
78. 2' 0" PLANTER	100	05/19/68	1.0
79. 2' 0" PLANTER	100	05/19/68	1.0
80. 2' 0" PLANTER	100	05/19/68	1.0
81. 2' 0" PLANTER	100	05/19/68	1.0
82. 2' 0" PLANTER	100	05/19/68	1.0
83. 2' 0" PLANTER	100	05/19/68	1.0
84. 2' 0" PLANTER	100	05/19/68	1.0
85. 2' 0" PLANTER	100	05/19/68	1.0
86. 2' 0" PLANTER	100	05/19/68	1.0
87. 2' 0" PLANTER	100	05/19/68	1.0
88. 2' 0" PLANTER	100	05/19/68	1.0
89. 2' 0" PLANTER	100	05/19/68	1.0
90. 2' 0" PLANTER	100	05/19/68	1.0
91. 2' 0" PLANTER	100	05/19/68	1.0
92. 2' 0" PLANTER	100	05/19/68	1.0
93. 2' 0" PLANTER	100	05/19/68	1.0
94. 2' 0" PLANTER	100	05/19/68	1.0
95. 2' 0" PLANTER	100	05/19/68	1.0
96. 2' 0" PLANTER	100	05/19/68	1.0
97. 2' 0" PLANTER	100	05/19/68	1.0
98. 2' 0" PLANTER	100	05/19/68	1.0
99. 2' 0" PLANTER	100	05/19/68	1.0
100. 2' 0" PLANTER	100	05/19/68	1.0

Landscape Plan

970667  
23042  
CITY COUNCIL  
113 33 31

THE LAKE HEIGHTS  
HIGH SCHOOL DISTRICT  
RICHARDSON  
INDEPENDENT  
SCHOOL DISTRICT  
L.A. BRICK AUSTIN

HIDELL  
ASSOCIATES  
ARCHITECTS

2011 University Avenue, Suite 200  
Dallas, Texas 75201  
Tel: 972.382.1111  
Fax: 972.382.1112

CONSTRUCTION MANAGER  
1111 W. Broad Street, Suite 200  
Dallas, Texas 75201  
Tel: 972.382.1111  
Fax: 972.382.1112

OWNER  
1111 W. Broad Street, Suite 200  
Dallas, Texas 75201  
Tel: 972.382.1111  
Fax: 972.382.1112

Revisions  
1. 05/19/68  
2. 05/19/68  
3. 05/19/68  
4. 05/19/68  
5. 05/19/68  
6. 05/19/68  
7. 05/19/68  
8. 05/19/68  
9. 05/19/68  
10. 05/19/68  
11. 05/19/68  
12. 05/19/68  
13. 05/19/68  
14. 05/19/68  
15. 05/19/68  
16. 05/19/68  
17. 05/19/68  
18. 05/19/68  
19. 05/19/68  
20. 05/19/68  
21. 05/19/68  
22. 05/19/68  
23. 05/19/68  
24. 05/19/68  
25. 05/19/68  
26. 05/19/68  
27. 05/19/68  
28. 05/19/68  
29. 05/19/68  
30. 05/19/68  
31. 05/19/68  
32. 05/19/68  
33. 05/19/68  
34. 05/19/68  
35. 05/19/68  
36. 05/19/68  
37. 05/19/68  
38. 05/19/68  
39. 05/19/68  
40. 05/19/68  
41. 05/19/68  
42. 05/19/68  
43. 05/19/68  
44. 05/19/68  
45. 05/19/68  
46. 05/19/68  
47. 05/19/68  
48. 05/19/68  
49. 05/19/68  
50. 05/19/68  
51. 05/19/68  
52. 05/19/68  
53. 05/19/68  
54. 05/19/68  
55. 05/19/68  
56. 05/19/68  
57. 05/19/68  
58. 05/19/68  
59. 05/19/68  
60. 05/19/68  
61. 05/19/68  
62. 05/19/68  
63. 05/19/68  
64. 05/19/68  
65. 05/19/68  
66. 05/19/68  
67. 05/19/68  
68. 05/19/68  
69. 05/19/68  
70. 05/19/68  
71. 05/19/68  
72. 05/19/68  
73. 05/19/68  
74. 05/19/68  
75. 05/19/68  
76. 05/19/68  
77. 05/19/68  
78. 05/19/68  
79. 05/19/68  
80. 05/19/68  
81. 05/19/68  
82. 05/19/68  
83. 05/19/68  
84. 05/19/68  
85. 05/19/68  
86. 05/19/68  
87. 05/19/68  
88. 05/19/68  
89. 05/19/68  
90. 05/19/68  
91. 05/19/68  
92. 05/19/68  
93. 05/19/68  
94. 05/19/68  
95. 05/19/68  
96. 05/19/68  
97. 05/19/68  
98. 05/19/68  
99. 05/19/68  
100. 05/19/68

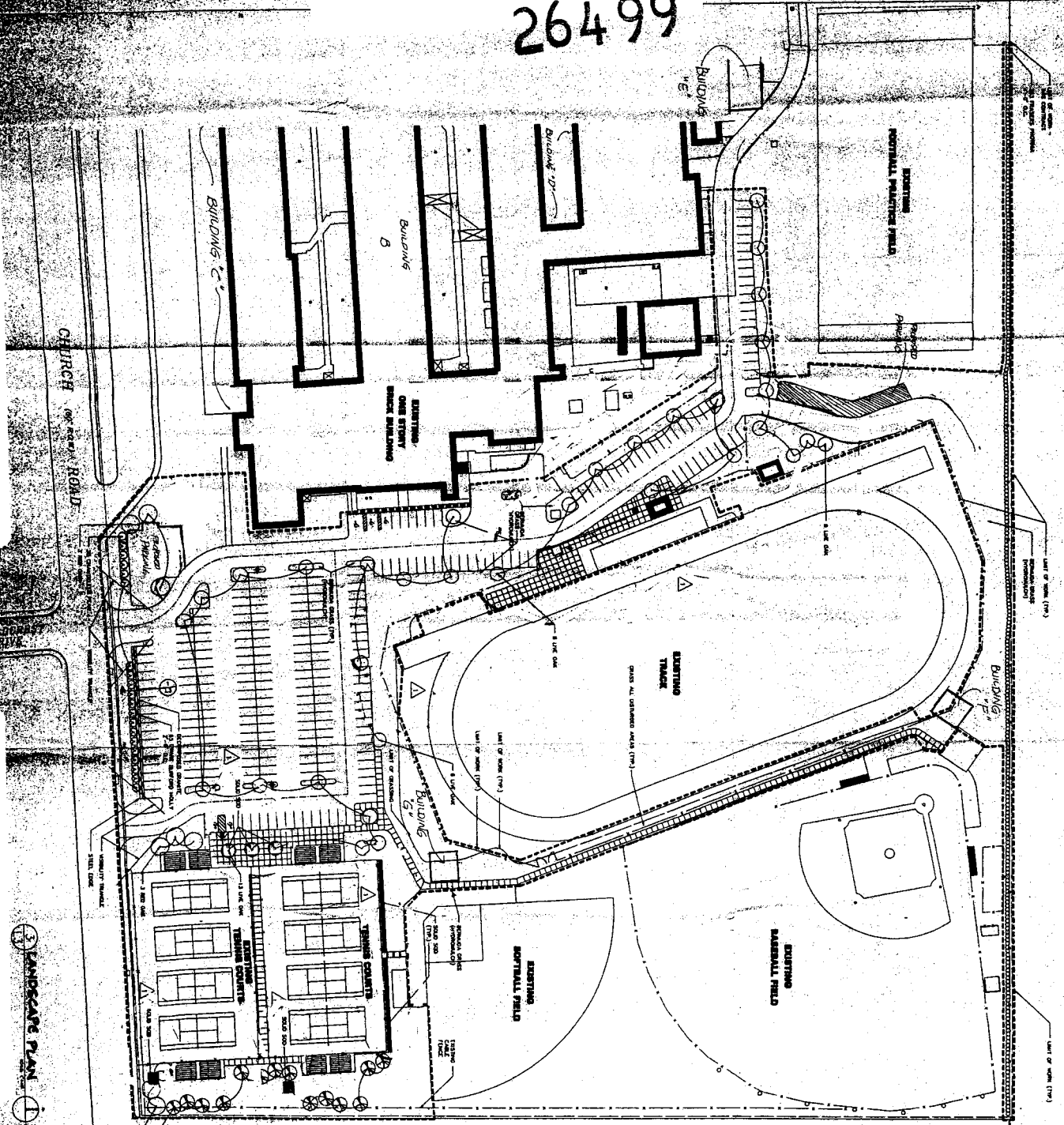

Approved  
 City Plan Commission  
 September 21, 2006

Planned Development  
 District  
 No. 467

LANDSCAPE PLAN

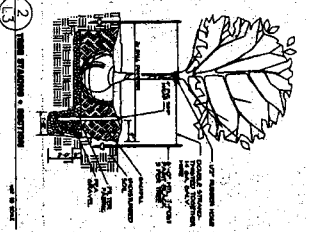
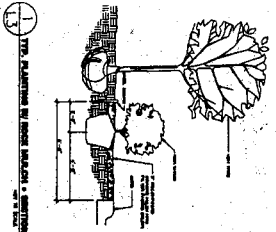

NO.	DATE	DESCRIPTION
1	08/15/06	PRELIMINARY
2	09/21/06	APPROVED

TENNIS COURT REDEVELOPMENT

RICHARDSON INDEPENDENT SCHOOL DISTRICT

HIDELL ASSOCIATES ARCHITECTS



LANDSCAPE PLAN  
 TITLE  
 PROJECT NO. 96066  
 DATE: 08/15/06  
 SCALE: AS SHOWN  
 DRAWN BY: [Name]  
 CHECKED BY: [Name]  
 APPROVED BY: [Name]

Revisions:  
 1. [Description]  
 2. [Description]  
 3. [Description]

Job No. 96066  
 Date: 08/15/06  
 Scale: AS SHOWN  
 Drawn By: [Name]  
 Checked By: [Name]  
 Approved By: [Name]