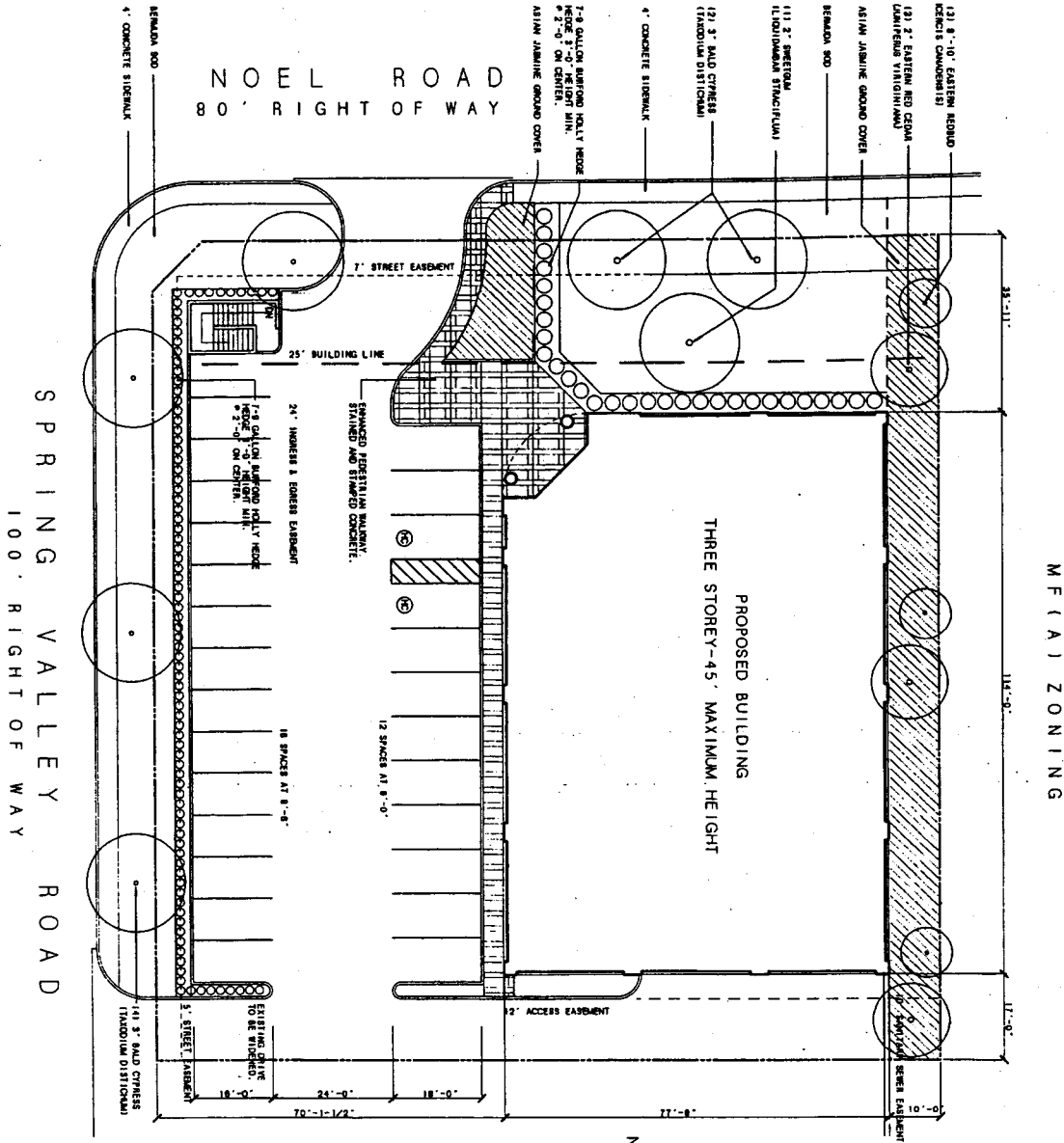

EXHIBIT 460A

DEVELOPMENT PLAN - LANDSCAPE PLAN



DALLAS, TEXAS

88364 S
2294 S

APPROVED BY
CITY COUNCIL
MAY 18 1968

SITE	24,748 S.F.
LOT AREA	24,748 S.F.
BUILDING	
FIRST FLOOR	8,228 S.F.
SECOND FLOOR	8,228 S.F.
THIRD FLOOR	8,292 S.F.
TOTAL	25,145 S.F.
PARKING COUNT	
PARKING REQUIRED BY ZONING	78
PARKING PROVIDED	78
ENHANCED PAVING	
PAVING REQ. 15% 1:237 S.F.	
PAVING PROVIDED 1:285 S.F.	
SITE TREES	
REQ. 1/4 000	8
PROVIDED	13

OWNER REPRESENTATIVE:	
DATE:	
SCALE:	
PROJECT NO.:	
DATE SUBMITTED TO CITY:	
DATE APPROVED BY CITY:	
DATE APPROVED BY COUNTY:	
DATE APPROVED BY STATE:	