

26042 EXHIBIT 419A

05 19 68

01
LANDSCAPE PLAN
1" = 30' 0"

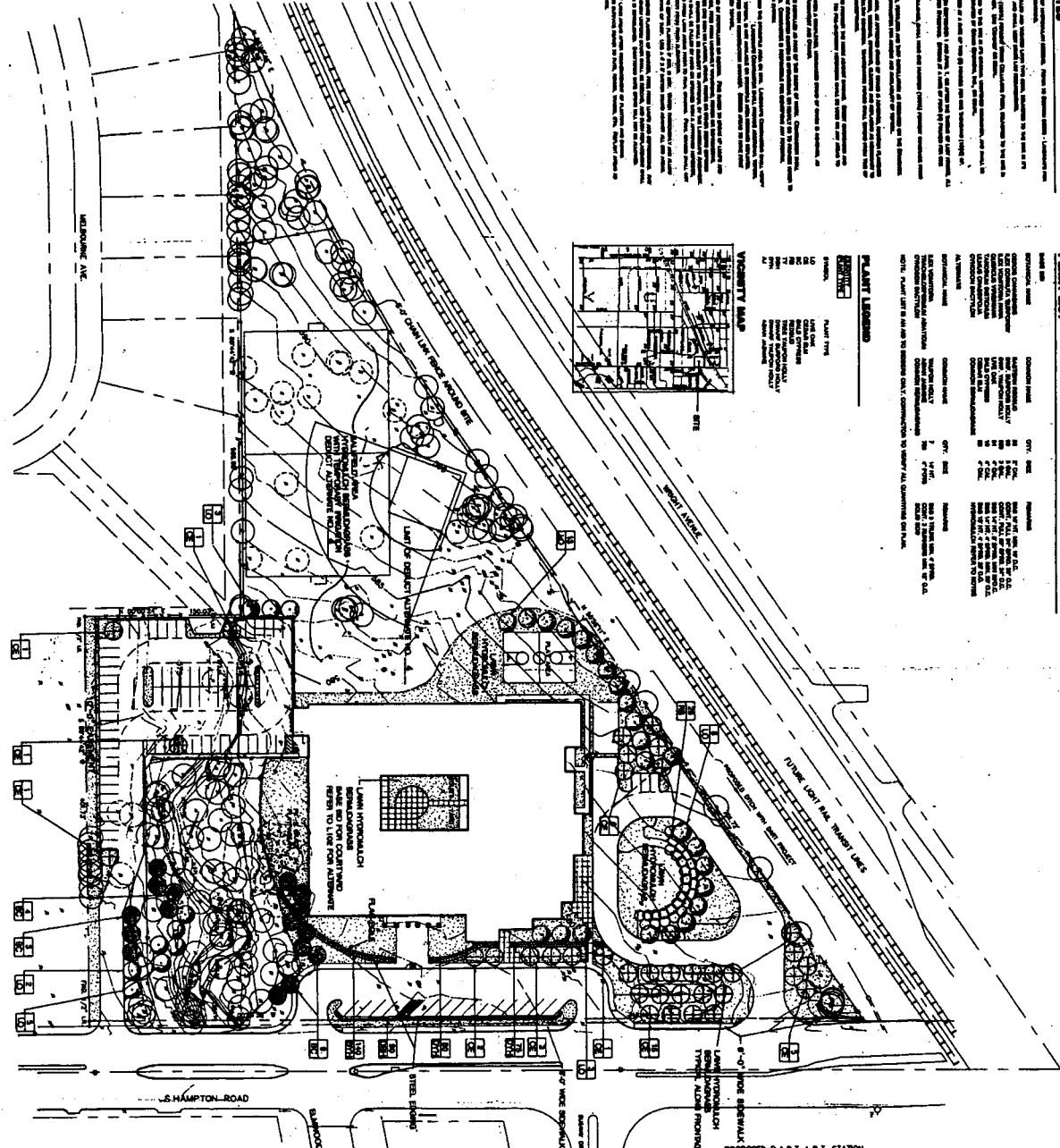

HYDROLOGICAL NOTES

1. The site is situated in a flood plain area and is subject to periodic flooding.
2. The proposed site is located on a slope of approximately 10%.
3. The site is not subject to any special flood hazard areas.
4. The site is not subject to any special flood hazard areas.

PLANT LIST

PLANT NAME	QUANTITY	DATE	REMARKS
PLANT LIST	PLANT LIST	PLANT LIST	PLANT LIST

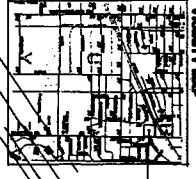

EXISTING TREES NOTES

1. Existing trees to be retained are indicated by a solid circle.
2. Existing trees to be removed are indicated by a circle with a diagonal slash.
3. Existing trees to be protected are indicated by a circle with a red border.
4. Existing trees to be protected are indicated by a circle with a red border.

LANDSCAPE NOTES

1. All trees to be planted are indicated by a circle with a solid fill.
2. All trees to be planted are indicated by a circle with a solid fill.
3. All trees to be planted are indicated by a circle with a solid fill.
4. All trees to be planted are indicated by a circle with a solid fill.

1100

LANDSCAPE SITE PLAN

26-1-04

CITY OF DALLAS

ELIMIN

FOR CONSTRUCTION

DALLAS INDEPENDENT SCHOOL DISTRICT
COWART RELIEF I ELEMENTARY SCHOOL
2115 S HAMPTON ROAD
DALLAS, TEXAS 75204

000144