

PRESTON HIGHLANDS PLANNED USE AREA
CITY OF DALLAS PLANNED DEVELOPMENT DISTRICT NO. _____

NOVEMBER 2004

T	LAND USE	AC.	ALLOWABLE DWELLING UNIT
A	R 7.5	27.24	98 (SINGLE-FAMILY)
B	R 7.5	4.72	N/A (PARK SITE)
C	T.H.1	19.10	113 (SINGLE-FAMILY)
C-1	T.H.1/HOSPITAL USE	2.50	15 (SINGLE-FAMILY, HOSPITAL USE)
D/E	T.H. 2	33.81	311 (SINGLE-FAMILY)
F	N.S.	4.079	N/A (RETAIL - OFFICE)
F-1	N.S. USABLE AREA	2.621	N/A (RETAIL - OFFICE)
	R.O.W.	1.57	N/A

TOTAL 95.64 537 D.U.

ACREAGES INCLUDE RIGHTS OF WAY AS SHOWN.
ACREAGES ABOVE MAY VARY BY NO MORE THAN 10%
AS POSSIBLY REQUIRED BY THE CITY OF DALLAS OR
FINAL DETAILED DESIGN AND ENGINEERING.

NOTE: ENTIRE 95.6 ACRES TO BE RESTRICTED AGAINST
MULTI-FAMILY USES.

PREPARED BY:
CETECH
1861 BROWN BOULEVARD
PHS 662
ARLINGTON, TEXAS 76006
214 / 534 - 1691 (P)
972 / 647 - 0505 (F)

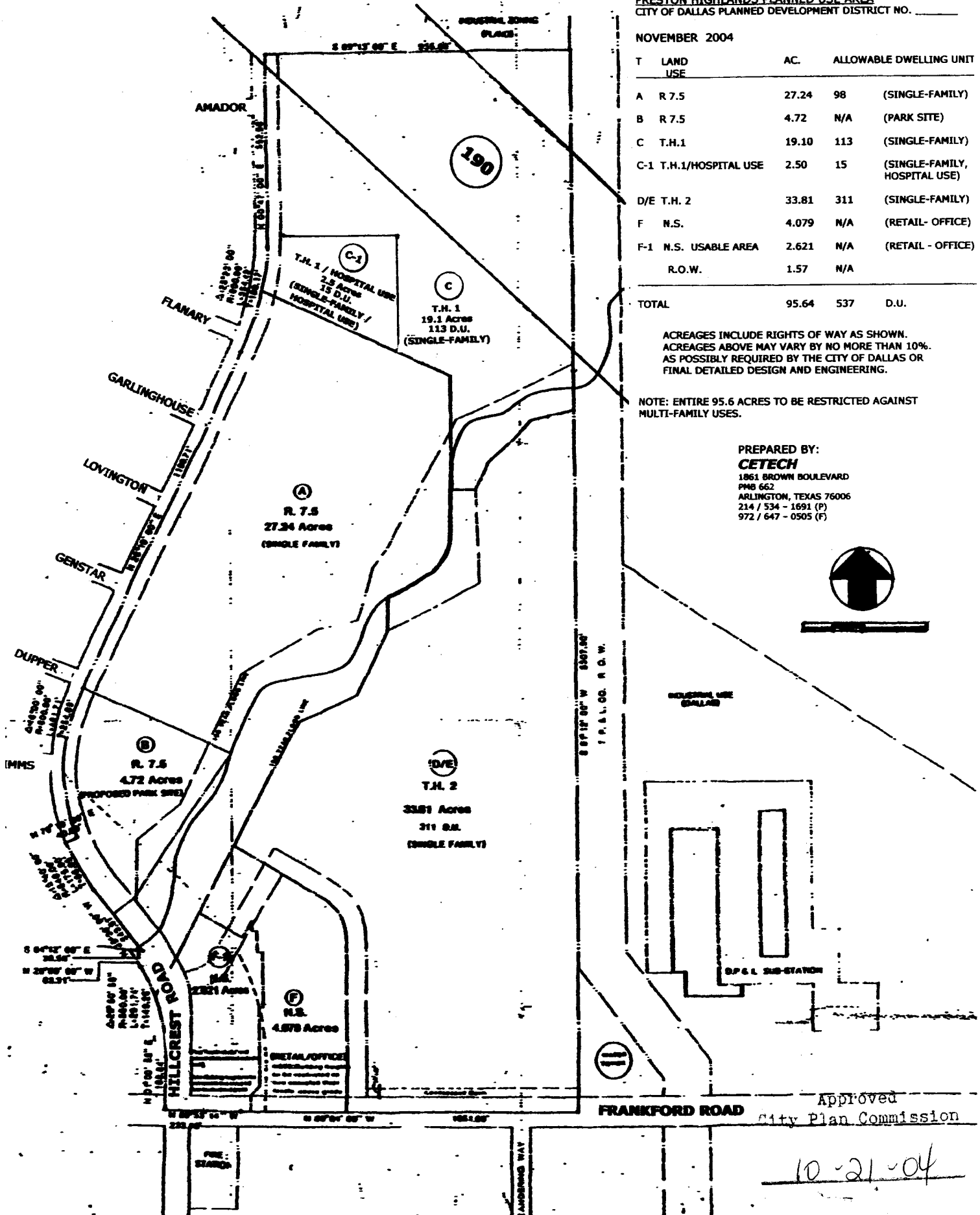

Approved
City Plan Commission

10-21-04

DEED RESTRICTIONS

PLANNED DEVELOPMENT DISTRICT NO. 173