

EXHIBIT 170A

24914

953797
22599

PLANNING
CITY/COUNTY

BY: [Signature]

DATE: 10/1/88

PROJECT: [Signature]

SCALE: 1" = 100'

DATE: 10/1/88

PROJECT: [Signature]

SCALE: 1" = 100'

DATE: 10/1/88

PROJECT: [Signature]

SCALE: 1" = 100'

DATE: 10/1/88

PROJECT: [Signature]

SCALE: 1" = 100'

DATE: 10/1/88

PROJECT: [Signature]

SCALE: 1" = 100'

DATE: 10/1/88

CONCEPT PLAN



Gulf, Colorado & Santa Fe Railroad

State Highway 180

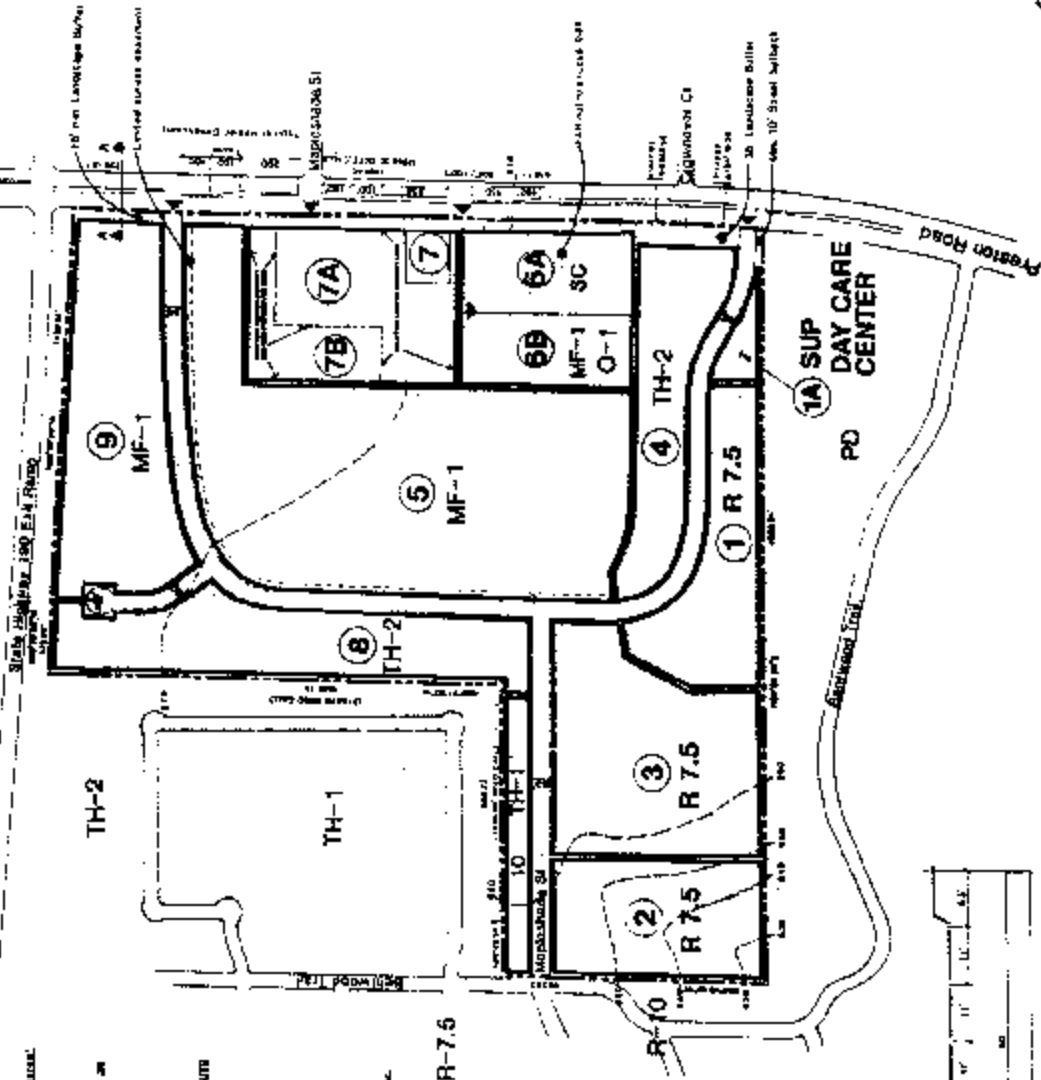

Lot	Area	Zone	Units	R.O.W.	Notes
1	28.11	R-7.5	108	1.48	
2		DAY CARE CENTER			
3		TH-2	44	26	
4	37.88	MF-1	143	1.83	
5	4.32	SC	28	0.48	
6	6.15	Q-1	37	0.48	
7	58	SC	47	0.48	
8	9.28	TH-2			
9	280	TH-1	48	0.38	
TOTALS:	111.6		328	1.03	

Total Project Area 111.6 Acres R-7.5

Land Use	Acres	M. D. U. 2
Q-1 (office)	6.15	4
SC (shopping center)	14.37	13
MF-1 (multi-family)	43.85	39
TH-1 (townhouse)	2.21	2
TH-2 (townhouse)	12.19	15
R-7.5	28.21	82
R.O.W.	7.73	7
DAY CARE CENTER	3.06	1
TOTALS	115.48	109

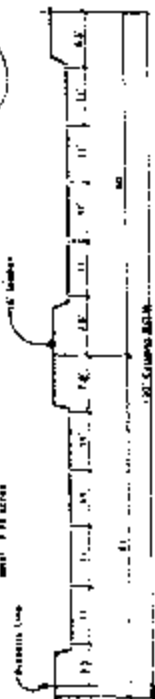

Preston Road Section A - A

100' Easement