

25508

040781

23285
FARMOUNT PLACE



REVISIONS
DATE: 11-13-11

DATE: 11-13-11

SHEET

EXHIBIT 148A

DEVELOPMENT PLAN A

NO SCALE
NORTH



DEVELOPMENT PLAN A

NO SCALE
NORTH

1. The site is proposed to be used as follows:
 a. 1.2 acres to be used as a site of 1,000 S.F. of office building, 2nd floor, with parking for 100 cars.
 b. 1.2 acres to be used as a site of 1,000 S.F. of office building, 2nd floor, with parking for 100 cars.
 c. 1.2 acres to be used as a site of 1,000 S.F. of office building, 2nd floor, with parking for 100 cars.

2. The site is proposed to be used as follows:
 a. 1.2 acres to be used as a site of 1,000 S.F. of office building, 2nd floor, with parking for 100 cars.
 b. 1.2 acres to be used as a site of 1,000 S.F. of office building, 2nd floor, with parking for 100 cars.
 c. 1.2 acres to be used as a site of 1,000 S.F. of office building, 2nd floor, with parking for 100 cars.

3. The site is proposed to be used as follows:
 a. 1.2 acres to be used as a site of 1,000 S.F. of office building, 2nd floor, with parking for 100 cars.
 b. 1.2 acres to be used as a site of 1,000 S.F. of office building, 2nd floor, with parking for 100 cars.
 c. 1.2 acres to be used as a site of 1,000 S.F. of office building, 2nd floor, with parking for 100 cars.

4. The site is proposed to be used as follows:
 a. 1.2 acres to be used as a site of 1,000 S.F. of office building, 2nd floor, with parking for 100 cars.
 b. 1.2 acres to be used as a site of 1,000 S.F. of office building, 2nd floor, with parking for 100 cars.
 c. 1.2 acres to be used as a site of 1,000 S.F. of office building, 2nd floor, with parking for 100 cars.

5. The site is proposed to be used as follows:
 a. 1.2 acres to be used as a site of 1,000 S.F. of office building, 2nd floor, with parking for 100 cars.
 b. 1.2 acres to be used as a site of 1,000 S.F. of office building, 2nd floor, with parking for 100 cars.
 c. 1.2 acres to be used as a site of 1,000 S.F. of office building, 2nd floor, with parking for 100 cars.

6. The site is proposed to be used as follows:
 a. 1.2 acres to be used as a site of 1,000 S.F. of office building, 2nd floor, with parking for 100 cars.
 b. 1.2 acres to be used as a site of 1,000 S.F. of office building, 2nd floor, with parking for 100 cars.
 c. 1.2 acres to be used as a site of 1,000 S.F. of office building, 2nd floor, with parking for 100 cars.

7. The site is proposed to be used as follows:
 a. 1.2 acres to be used as a site of 1,000 S.F. of office building, 2nd floor, with parking for 100 cars.
 b. 1.2 acres to be used as a site of 1,000 S.F. of office building, 2nd floor, with parking for 100 cars.
 c. 1.2 acres to be used as a site of 1,000 S.F. of office building, 2nd floor, with parking for 100 cars.

8. The site is proposed to be used as follows:
 a. 1.2 acres to be used as a site of 1,000 S.F. of office building, 2nd floor, with parking for 100 cars.
 b. 1.2 acres to be used as a site of 1,000 S.F. of office building, 2nd floor, with parking for 100 cars.
 c. 1.2 acres to be used as a site of 1,000 S.F. of office building, 2nd floor, with parking for 100 cars.

9. The site is proposed to be used as follows:
 a. 1.2 acres to be used as a site of 1,000 S.F. of office building, 2nd floor, with parking for 100 cars.
 b. 1.2 acres to be used as a site of 1,000 S.F. of office building, 2nd floor, with parking for 100 cars.
 c. 1.2 acres to be used as a site of 1,000 S.F. of office building, 2nd floor, with parking for 100 cars.

10. The site is proposed to be used as follows:
 a. 1.2 acres to be used as a site of 1,000 S.F. of office building, 2nd floor, with parking for 100 cars.
 b. 1.2 acres to be used as a site of 1,000 S.F. of office building, 2nd floor, with parking for 100 cars.
 c. 1.2 acres to be used as a site of 1,000 S.F. of office building, 2nd floor, with parking for 100 cars.

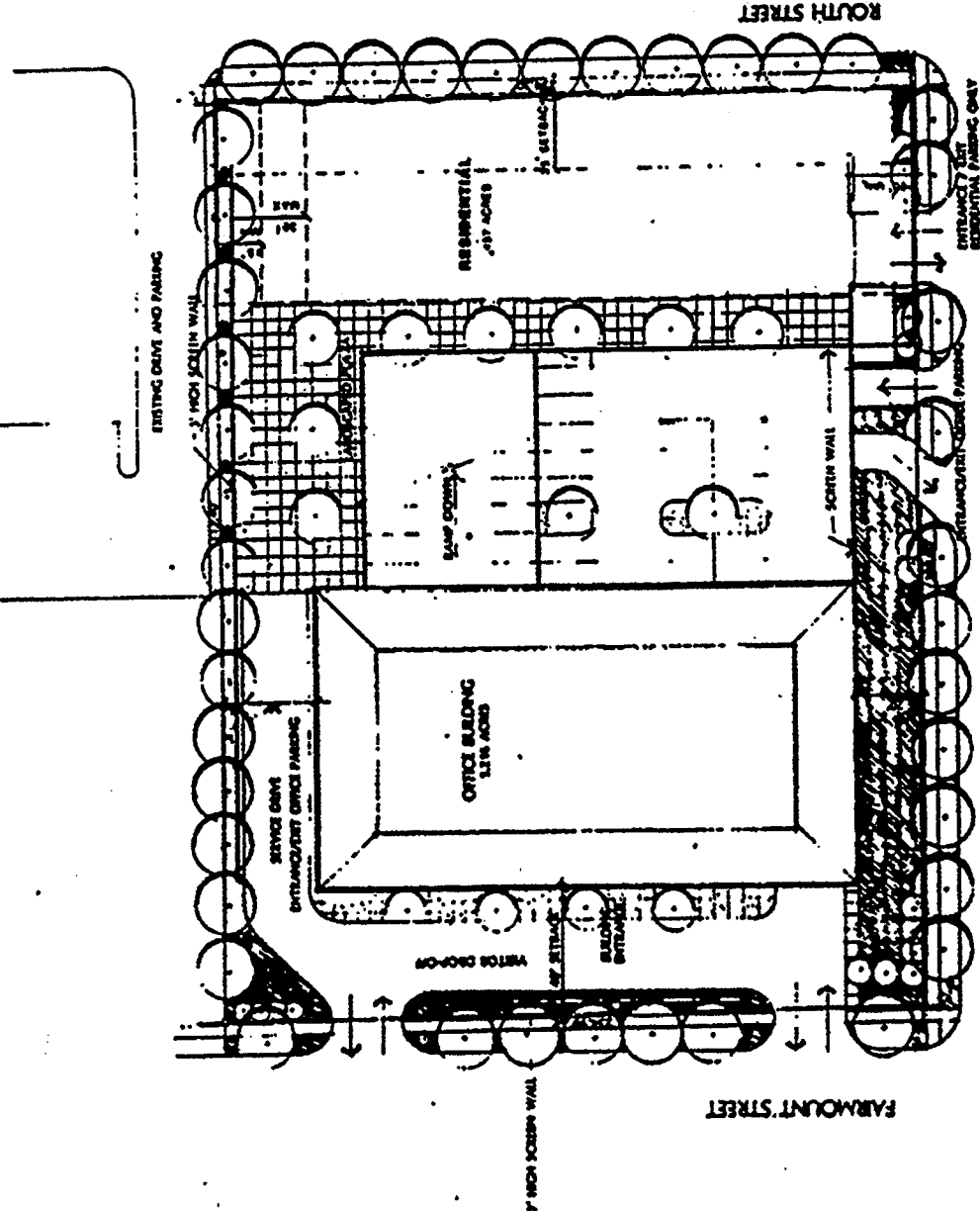

PLANNED DEVELOPMENT DISTRICT NO. 148
 2967-185/ 2995-c (RD)