

BORDER, F:\VCS\33\33\33\1.001, 1-4, 6-8, 17, 18, 36, 48-53
 STATION, F:\VCS\33\33\33\1.040, 9-11, 13, 15, 16, 18, 21-36, 41
 CIVIL, F:\VCS\33\33\33\1.040, 9-13, 15, 16, 19, 20, 32, 34-39
 BOUND, F:\VCS\33\33\33\1.040, 1-2, 4-15, 17-22, 24-29, 31, 32, 34, 35, 41
 SITE, F:\VCS\33\33\33\3.025, 1-3, 5-18, 18, 20, 22-45, 47-49, 51-53

MODIFY, F:\VCS\33\33\33\1.001, 1-1, 2, 20, 22-30, 32-45, 47, 49, 51-53
 LAND, F:\VCS\33\33\33\1.001, 1-1, 2, 20, 22-30, 32-45, 47, 49, 51-53
 LAND, F:\VCS\33\33\33\1.001, 1-1, 2, 20, 22-30, 32-45, 47, 49, 51-53
 TOPOT, F:\VCS\33\33\33\1.001, 2-5, 8, 9, 11, 13, 15, 20, 25, 29, 49, 52
 SHEET, F:\VCS\33\33\33\1.020, 1-20, 22-25, 27-45, 47-49, 51-52

F:\VCS\33\33\33\1.001\Drawings\3318.dwg
 User: 7/11/68 10:00
 F:\VCS\33\33\33\1.001\Drawings\3318.dwg
 User:

EXHIBIT 506A

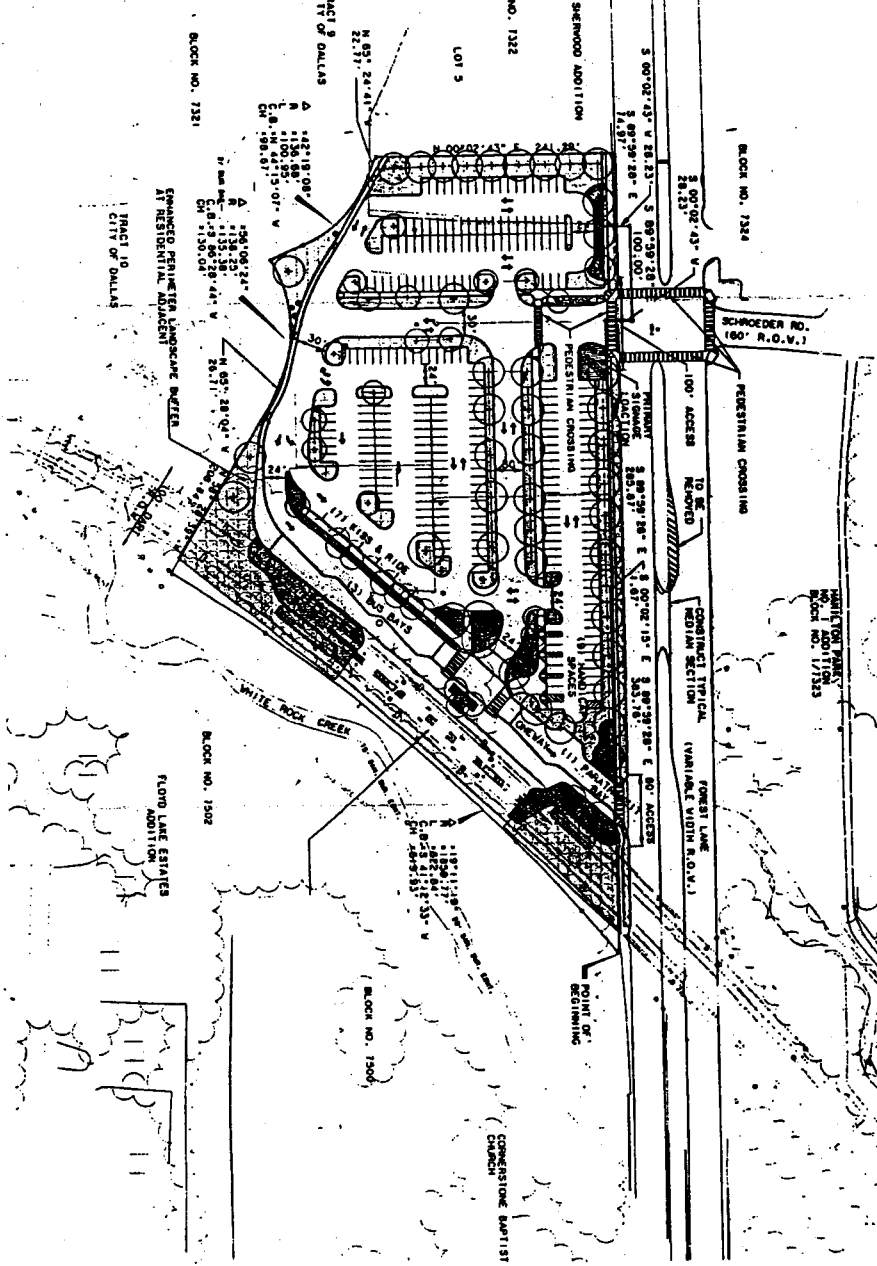

REV	DATE	DESCRIPTION	BY	CHK	APP	DATE	DESCRIPTION	BY	CHK	APP

NOTE: LANDSCAPE AREAS TO BE WATERED BY A FULLY AUTOMATIC UNDERGROUND IRRIGATION SYSTEM.

CAYE COOK A.S.L.A.
 Landscape Architect
 1100 Parkview Plaza, Suite 200
 Dallas, TX 75244-2000

LANSTV
 Landscape Architects & Planners, Inc.
 and City Department
 GARDNER
 CHAMBERLAIN & YERGEN
 VINDAUX ASSOCIATES

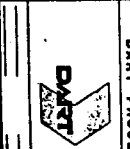

DATE	1/28/68
DESIGNED BY	A. J. JENSEN
CHECKED BY	S. E. WILSON
IN CHARGE BY	A. J. JENSEN
DATE	1/28/68

CONTRACT NO. C-92000191
 CONTRACT SHEET NO. 1 OF 2
LIGHT RAIL TRANSIT SYSTEM
 LINE SECTION NC-3
 CITY OF DALLAS
 DEVELOPMENT & LANDSCAPE PLAN
 FOREST LANE STATION
 PROPOSED ZONING
 PLANNED DEVELOPMENT

APPROVED BY
23579
 CITY COUNCIL
 JAN 24 1968
 Approved
 Mayor
 City

PROPERTY DESCRIPTION	REMARKS
Block 1232 Lot 1	TRACT 3 DALLAS AREA RAPID TRANSIT
Block 1232 Lot 2	TRACT 3 DALLAS AREA RAPID TRANSIT
Block 1232 Lot 1	WORLD F. DRV
Block 1232 Lot 3	ANNON KLANBERG
Block 1232 Lot 3.1	WESTERN SAYING AND ASSOCIATION
Block 1232 Lot 1	TRACT 4 HONNIE E. BOWEN
Block 1232 Lot 11	FOREST LANE 11

LANDSCAPE ORDINANCE
 MANDATORY PROVISIONS
 - SITE TREES (REMOVED, BE PROVIDED FOREST LANE - 3) RECORDED, 13 PROVIDED
 - PARKING LOT TREES PROVIDED
 - RESIDENTIAL ADJACENCY - NONE
 DESIGN STANDARDS
 - PERESTRIAN FACILITIES
 - STREET BOWEN PLANTING
 TREE MITIGATION
 - PROJECTED TREES TO BE REMOVED WILL BE MITIGATED BY NEW TREE PLANTING

- PLANT LEGEND**
- LARGE CANOPY TREE
 - SMALL TREE
 - SHRUB
 - GROUND COVER
 - GROSS (LAWN)
 - EXISTING TREE
 - TO REMAIN
 - EXISTING TREE

GENERAL NOTES:
 1. PLANNING WILL COMPLY WITH ALL CITY OF DALLAS ZONING ORDINANCES AND CITY STREET PLANNING. THE PROPOSED PROPERTY INCLUDES PARCELS OF LAND IN THE FOLLOWING ZONING DISTRICTS: COMMERCIAL RETAIL DISTRICT, CS (COMMERCIAL SERVICE DISTRICT), STATION TYPE PLATFORM PROPERTY LOCATION: FOREST LANE STATION, WHITE ROCK CREEK.

SCALE (IN FEET)
 0 30 60 120

