

25423

032856

EXHIBIT 67E

001 DEVELOPMENT PLAN
SCALE 1" = 30'-0"

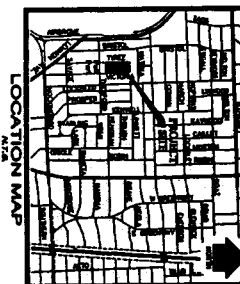
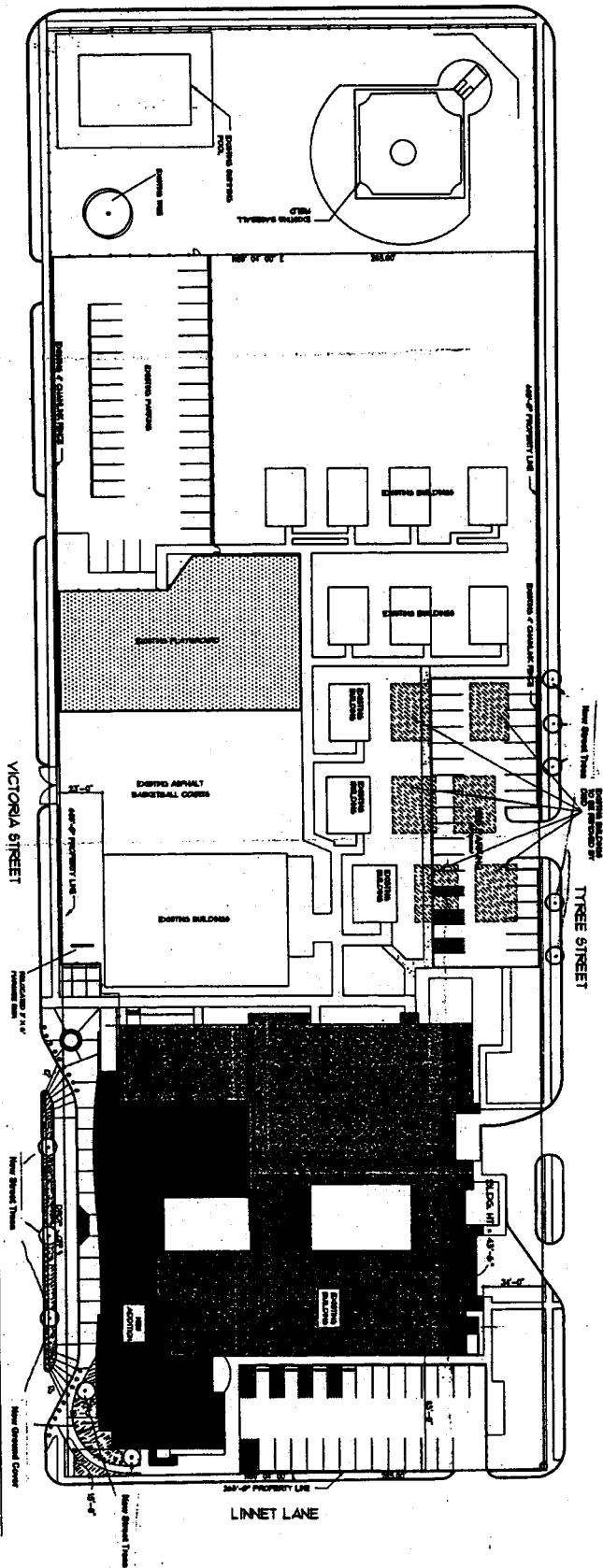

SITE DATA SUMMARY

PROPOSED AREA	14,886 SQ. FT.
TOTAL LOT AREA	13,827 SQ. FT.
TOTAL BUILDING AREA	14,886 SQ. FT.
ADDITIONS	13,827 SQ. FT.
RENOVATION AREA	1,059 SQ. FT.
MAJOR BUILDING HEIGHT	12'-0"
TOTAL LOT COVERAGE	107%
CLASSROOMS	23
BOYSCOUTS	2
PARKING PROVIDED	30
PARKING REQUIRED	30
EXISTING	0
PROPOSED	30

Site area enclosed
1-5-15-03 3003-310 1
NAMED INSTRUMENT NUMBER 30,032

DESIGN DEVELOPMENT
DSD 8P/03
CITY COUNCIL
JUN 11 2003
031703
25283

PROJECT NO. 0208
DATE: 27 APRIL 2003
DRAWN BY:
CHECKED BY:
SHEET 01 OF 01 SHEETS
DEV 1

Additions and Renovations to
K. B. Polk Elementary School
6911 Victoria Avenue Dallas, Texas 75209
for the
Dallas Independent School District

PRELIMINARY
Independent Documents
Not for Construction
Without Approval
of the City of Dallas
Texas Registration #1466

PRATT JACKSON

1546 STEAKING FRWY #2 - DALLAS, TEXAS 75207-214-520-4000