

**CURRENT ZONING - PDZ7
PARKING CALCULATIONS**

LEVEL	SUITE	Parking for Office	Parking for Storage	Total Parking for Level
LEVEL ONE	SUITE 100	4100233 = 1	307261000 = 3	307261001 = 4
	Parking for Storage		307261000 = 3	
	Total Parking for Level One		307261000 = 3	307261001 = 4
LEVEL TWO	SUITE 200 OFFICE	5137233 = 15	1888900 = 3	1888901 = 18
	Parking for Office		1888900 = 3	
	Parking for Storage		1888900 = 3	
	Total Parking for Level Two	5137233 = 15	1888900 = 3	1888901 = 18
LEVEL THREE	SUITE 300 SURGERY CENTER	1152333 = 3	1850200 = 6	1850201 = 9
	Parking for Office		1850200 = 6	
	Parking for Storage		1850200 = 6	
	Total Parking for Level Three	1152333 = 3	1850200 = 6	1850201 = 9
	SUITE 301 OFFICE	2242333 = 13	1850200 = 6	1850201 = 19
	Parking for Office		1850200 = 6	
	Parking for Storage		1850200 = 6	
	Total Parking for Level Three	2242333 = 13	1850200 = 6	1850201 = 19
	Total Parking for Level Three	2242333 = 13	1850200 = 6	1850201 = 19

Total parking available for building = 42
 Total parking required for building = 42
 Note: Maximum floor area for office/showroom/warehouse uses is 4,500 square feet

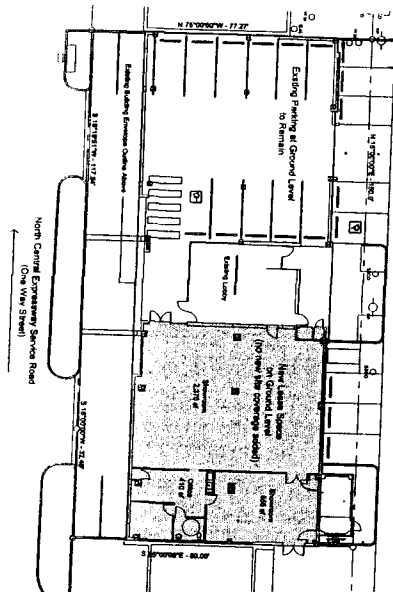

development plan

development plan

knox place II

4633 North Central Expressway
Dallas, Texas 75205

4633 North Central, LLC
Dallas, Texas

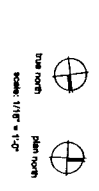

Edin Bradley Smith & Associates, Inc.
11000 Preston Road, Suite 200, Dallas, Texas 75240
Phone: 972-361-1100 Fax: 972-361-1101

Z089-197

Approved
City Plan Commission
June 11, 2009

Planned Development
District No. 27