

083093

- KEY NOTES**
- ① POSITION 8'-0" WOOD FENCE
  - ② POSITION 8' BLACK IRONCLAD POST FENCE
  - ③ POSITION 8' BLACK IRONCLAD POST FENCE
  - ④ POSITION 8' CHAIN-LINK FENCE

**KEY NOTES**

**AREA MAP**  
NOT TO SCALE

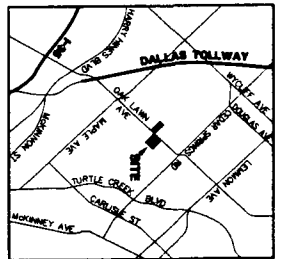

SITE DATA A	TRACT 1		TRACT 2		TRACT 3		TOTAL
	USE:	CURRENT:	CURRENT:	CURRENT:	CURRENT:	PARKING	
USE: ANIMAL CLINIC WITHOUT OUTSIDE RUNS AND OFFICE (INCLUDES INDOOR ANIMAL DAY CARE & INDOOR BOARDING) ANIMAL CLINIC & KENNEL WITH OUTSIDE RUNS AND OFFICE SITE AREA: EXISTING BUILDING AREA: OUTSIDE RUN AREA: LOT COVERAGE: $\Delta$ HEIGHT: FEET: STORIES: PARKING	ANIMAL CLINIC WITHOUT OUTSIDE RUNS AND OFFICE (INCLUDES INDOOR ANIMAL DAY CARE & INDOOR BOARDING) ANIMAL CLINIC & KENNEL WITH OUTSIDE RUNS AND OFFICE 0.148 ACRES $\pm$ 5,501 SF. $\pm$ $\Delta$ 1,213 SQ FT. $\pm$ 36.3X 18 FT. ONE STORY VET CLINIC: 5,501 SF. $\bullet$ 1 CAR/300 S.T. = 18 CARS	ANIMAL CLINIC WITHOUT OUTSIDE RUNS AND OFFICE (INCLUDES INDOOR ANIMAL DAY CARE & INDOOR BOARDING) ANIMAL CLINIC & KENNEL WITH OUTSIDE RUNS AND OFFICE 0.133 ACRES $\pm$ FIRST FLOOR: 8,745 SF. $\pm$ SECOND FLOOR: 12,698 SF. $\pm$ TOTAL: 21,443 SF. $\pm$ 1,809 SQ FT. $\pm$ 46.3X 28 FT. TWO STORY VET CLINIC: 15,984 SF. $\bullet$ 1 CAR/300 S.T. = 52 CARS OFFICE: 5,879 SF. $\bullet$ 1 CAR/366 S.T. = 16 CARS TOTAL = 68 CARS	ANIMAL CLINIC WITHOUT OUTSIDE RUNS AND OFFICE (INCLUDES INDOOR ANIMAL DAY CARE & INDOOR BOARDING) ANIMAL CLINIC & KENNEL WITH OUTSIDE RUNS AND OFFICE 0.133 ACRES $\pm$ 8,745 SF. $\pm$ 12,698 SF. $\pm$ TOTAL: 21,443 SF. $\pm$ 1,809 SQ FT. $\pm$ 46.3X 28 FT. TWO STORY VET CLINIC: 15,984 SF. $\bullet$ 1 CAR/300 S.T. = 52 CARS OFFICE: 5,879 SF. $\bullet$ 1 CAR/366 S.T. = 16 CARS TOTAL = 68 CARS	ANIMAL CLINIC WITHOUT OUTSIDE RUNS AND OFFICE (INCLUDES INDOOR ANIMAL DAY CARE & INDOOR BOARDING) ANIMAL CLINIC & KENNEL WITH OUTSIDE RUNS AND OFFICE 0.133 ACRES $\pm$ 8,745 SF. $\pm$ 12,698 SF. $\pm$ TOTAL: 21,443 SF. $\pm$ 1,809 SQ FT. $\pm$ 46.3X 28 FT. TWO STORY VET CLINIC: 15,984 SF. $\bullet$ 1 CAR/300 S.T. = 52 CARS OFFICE: 5,879 SF. $\bullet$ 1 CAR/366 S.T. = 16 CARS TOTAL = 68 CARS	54 CARS 5 CARS 5 CARS 4 CARS 68 CARS	1.115 ACRES $\pm$ 26,944 SF. $\pm$ $\Delta$ 3,022 SQ FT. $\pm$ 29.3X 86 CARS	

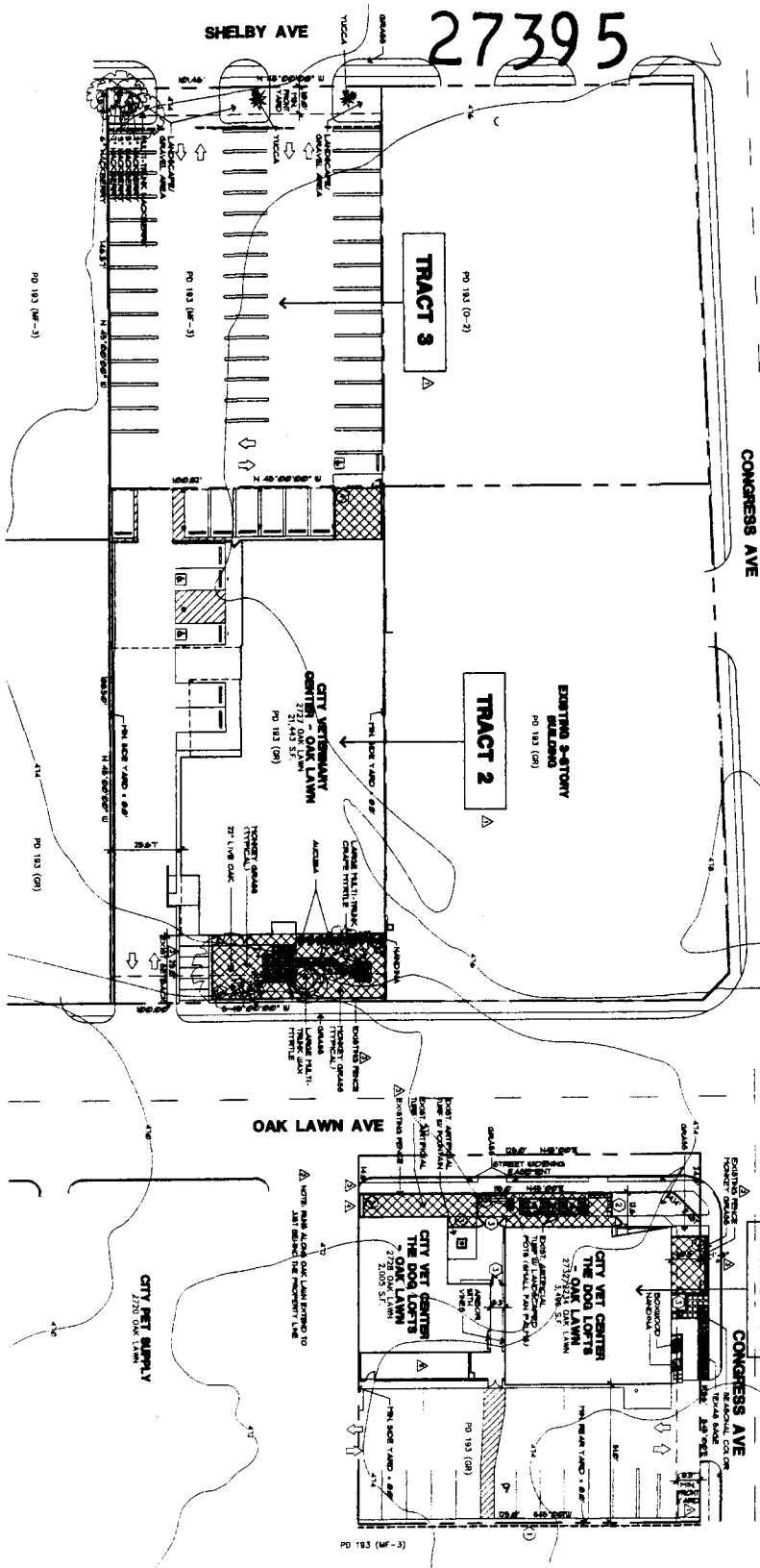

27395

Planned Development  
Subdistrict No. 84

Planned Development  
District No. 193



OUTSIDE RUNS  $\Delta$



DEVELOPMENT PLAN

SCALE: 1" = 20'-0"

**ZONING PROPOSAL**  
CASE NUMBER: 2078-236

**2727, 2728 & 2732/2734 OAK LAWN AVE.**  
LOTS 6, 7, 12 & 13 OF BLOCK 1/13137 & PART OF BLOCK 2/1025  
CITY OF DALLAS, DALLAS COUNTY, TEXAS

**OWNER: CANNON PROPERTIES LP**  
Dallas, Texas 75219  
2727 Oak Lawn Ave, Suite 201  
214-522-0030/214-522-0040 fax

DATE: 3-28-08  
SCALE: 1" = 20'-0"

REVISIONS:  
10-2-08  
11-10-08

DATE: 3-28-08  
SCALE: 1" = 20'-0"

REVISIONS:  
10-2-08  
11-10-08

**A1**

GRAPHIC SCALE  
0 25 50 100



**DANIELS & ASSOCIATES ARCHITECTS**  
4324 N. Stemmons Rd.  
Suite C202  
Dallas, Texas 75208  
972-255-4141 fax