

083095

27392

Exhibit 804A

LAND AREA: 3.75 ACRES (163,350 SF)
 TOTAL GARAGE: 333,240 SF (LEVELS 1-5)
 LEASE AREA GROUND LEVEL: 40,704 SF
 MEDICAL OFFICE LEASE AREA LEVELS (LEVELS 6-12): 219,296 SF
 TOTAL LEASE AREA: 260,000 SF
 FLOOR AREA RATIO:
 - MEDICAL OFFICE BUILDING (260,000 SF)
 - SITE AREA (163,350 SF) - 1.6
 - MEDICAL OFFICE BUILDING (260,000 SF)
 + PARKING STRUCTURE (333,240 SF)
 - SITE AREA (163,000 SF) - 3.63
 HEIGHT: 12 STORIES OR 210 FEET
 PARKING:
 - GROUND LEVEL LEASE AREA 1 SPACE/ 250 GSF - 163
 - MEDICAL OFFICE LEASE AREA 1 SPACE/ 290 GSF - 878
 TOTAL PARKING: 1041
 - 1000 GARAGE SPACES
 - 41 SURFACES SPACES

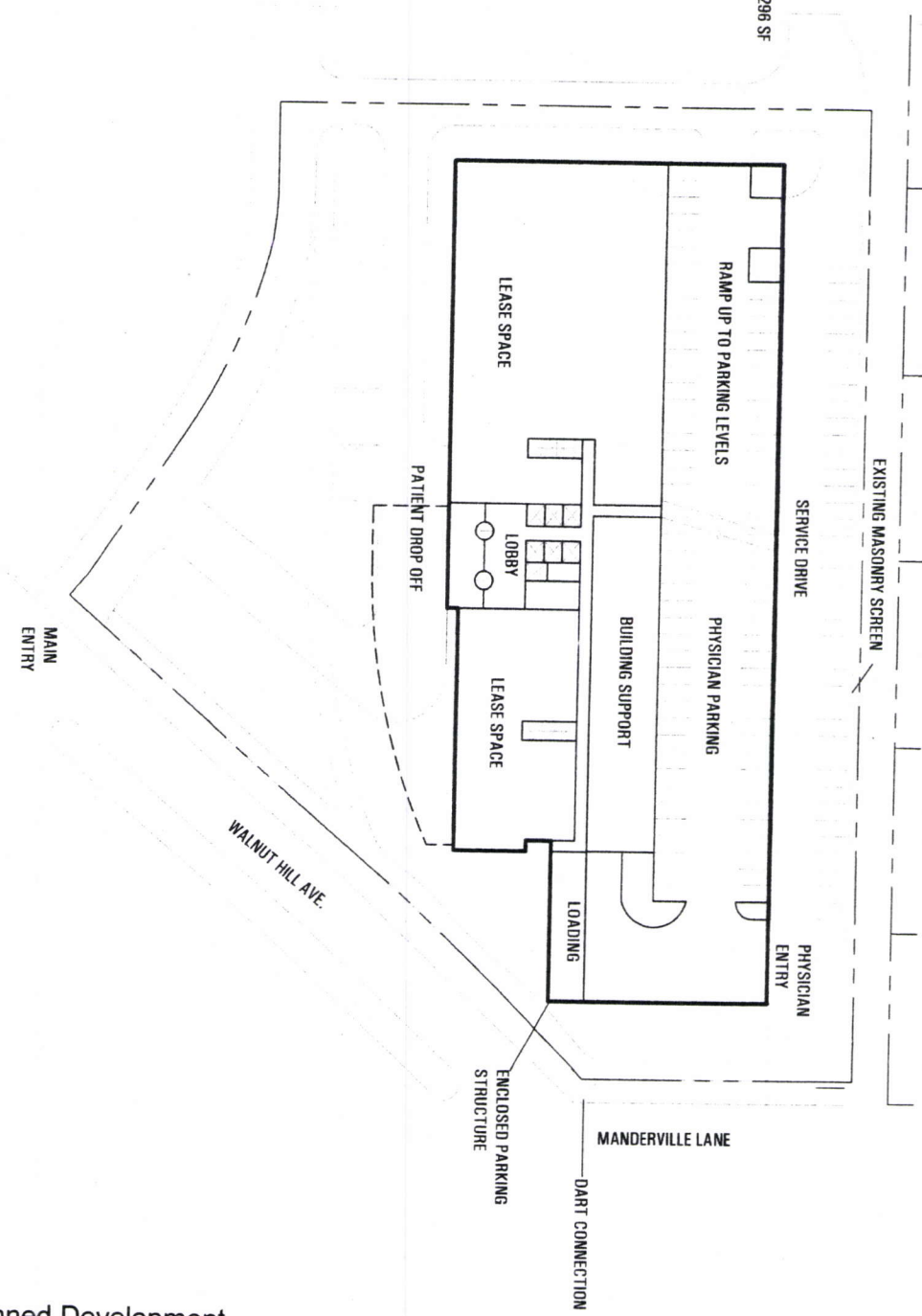

WALNUT HILL
 MEDICAL PLAZA
 02 OCTOBER 2008



Planned Development
 District No. 804

Approved
 City Plan Commission
 October 16, 2008

Zoning Case Number: Z078-280