

081446

Exhibit 1E

27181

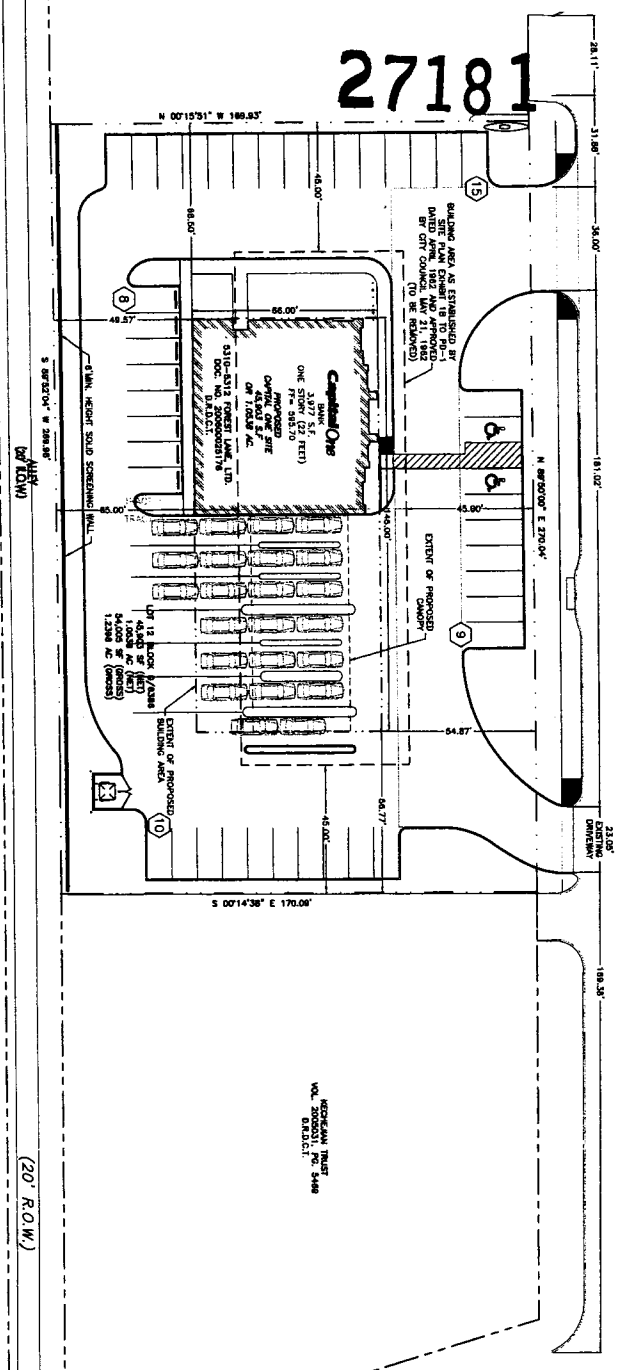

FOREST LANE
(REV. L&M)

EASTERN AVENUE
(REV. L&M)

DALLAS NORTH TOLLWAY
(REV. L&M)

Planned Development
District No. 1

Approved
City Plan Commission
April 10, 2008

SITE DATA SUMMARY TABLE

NAME PROPOSED:	CAPITAL ONE
PROPOSED USE:	BANK B/TWNC THRU
SITE AREA:	1,053.7 ACRES (44,800 S.F.)
BUILDING AREA:	0,091.8 ACRES (3,887 S.F.)
UNUSUAL BUILDING HEIGHT:	2 STORIES
LOT COVERAGE:	8.71% OF TOTAL LOT AREA
TOTAL PARKING REQUIRED:	22 SPACES REQUIRED (1 PER 200 S.F.)
PARKING PROVIDED:	42 SPACES PROVIDED
HANDICAP SPACES REQUIRED:	1 HANDICAP SPACE
HANDICAP SPACES PROVIDED:	2 HANDICAP SPACES (2 VAN ACCESSIBLE)

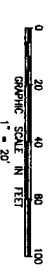
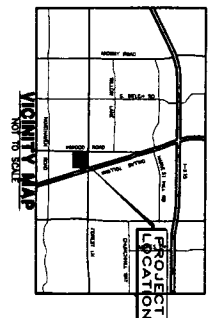

LEVINSON, ALCOSSER ASSOCIATES, L.P.
1177 N. Loop South, Suite 800 Houston, Texas 77028
Tel: 713.972.0000 Fax: 713.972.0000

ARCHITECTURE PLANNING INTERIOR DESIGN

Carbor II Burgess
Consultants in Planning, Engineering and Architecture
1777 MAIN STREET, SUITE 700
DALLAS, TEXAS 75210
TEL. (817) 222-6500
FAX (817) 222-6500

DATE: APRIL 10, 2008
DRAWN BY: [Signature]

Capital One
Design/Construction, Southern Franchise
201 St. Charles Ave, Suite 2200
New Orleans, LA 70170

**CAPITAL ONE
DALLAS**

FOREST AND TOLLWAY
DALLAS, TEXAS

FILE: P:\DR\1\Map\1777_Main_South_Tollway_2954333\Civil\Sheet\City of Dallas\2078-181.dwg XREFSMT-Gen: 2954333CMT; 2954333TOP; 2954333BOR (2.dwg) MODIFIED: Apr 17, 2008 14:46m PLOTTED: Apr 18, 2008 8:57am BY: gshyd PLOT SCALE: 1:30