

27195

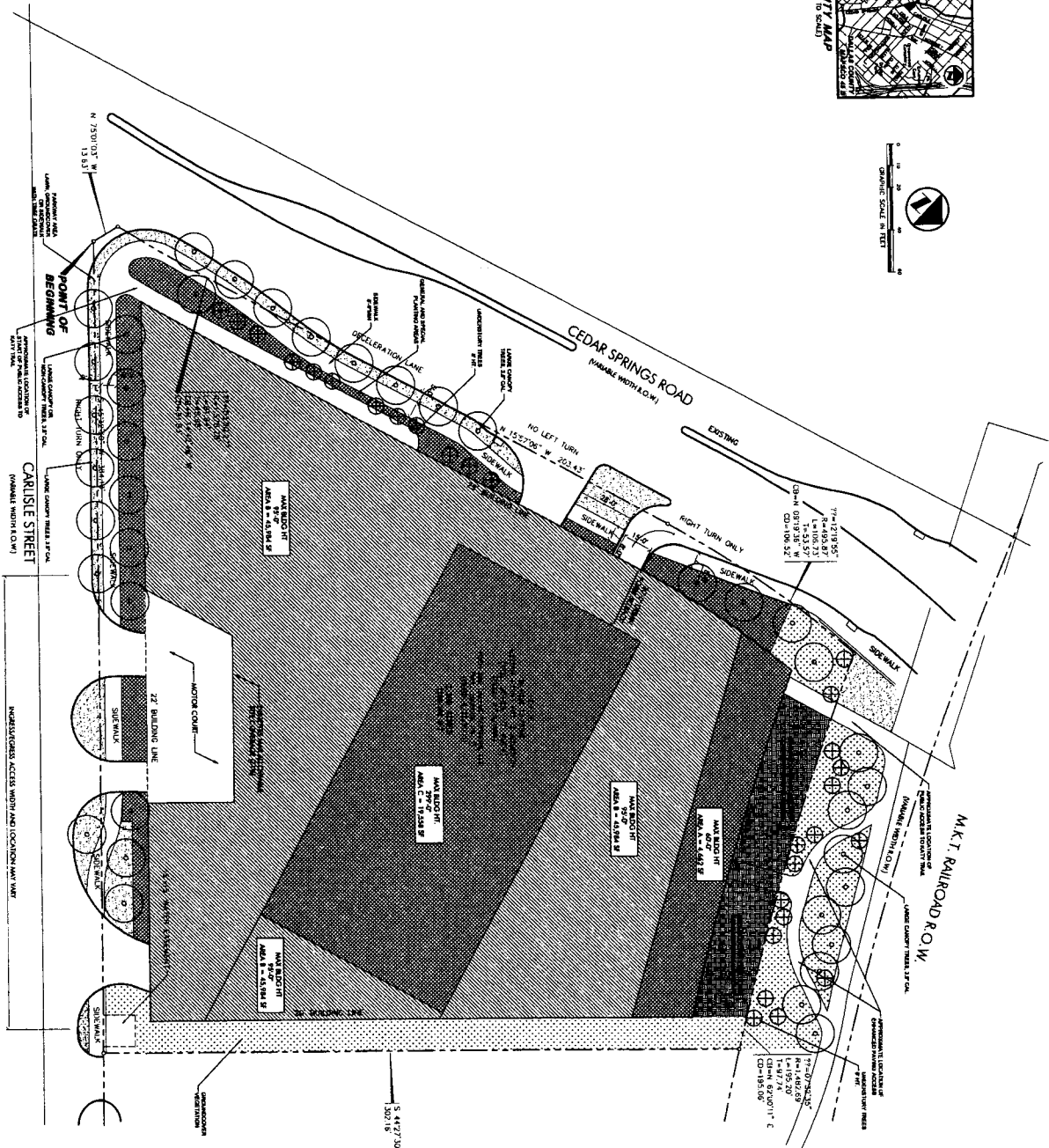

PROJECT INFORMATION	
SITE AREA =	2.389 ACRES, 103,580 SF
MINIMUM ALLOWABLE SITE COVERAGE =	7.1% = 71,398 SF
ACTUAL SITE COVERAGE =	70% = 72,528 SF
MAXIMUM BUILDING HEIGHT =	70' = 17,238 SF = 20% of lot area
MAXIMUM BUILDING HEIGHT =	45' = 10,400 SF = 50% of lot area
SITE ELEVATION =	450'-0" MSL

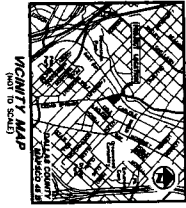
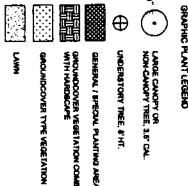

**LANDSCAPE PLANT LEGEND**

- LANDSCAPE PLANTING ON NON-CANOPY TREES 3" CAL.
- LANDSCAPE PLANTING ON CANOPY TREES 3" CAL.
- LANDSCAPE PLANTING ON CANOPY TREES 6" CAL.
- LANDSCAPE PLANTING ON CANOPY TREES 12" CAL.
- LANDSCAPE PLANTING ON CANOPY TREES 18" CAL.
- LANDSCAPE PLANTING ON CANOPY TREES 24" CAL.
- LANDSCAPE PLANTING ON CANOPY TREES 30" CAL.
- LANDSCAPE PLANTING ON CANOPY TREES 36" CAL.
- LANDSCAPE PLANTING ON CANOPY TREES 42" CAL.
- LANDSCAPE PLANTING ON CANOPY TREES 48" CAL.
- LANDSCAPE PLANTING ON CANOPY TREES 54" CAL.
- LANDSCAPE PLANTING ON CANOPY TREES 60" CAL.
- LANDSCAPE PLANTING ON CANOPY TREES 66" CAL.
- LANDSCAPE PLANTING ON CANOPY TREES 72" CAL.
- LANDSCAPE PLANTING ON CANOPY TREES 78" CAL.
- LANDSCAPE PLANTING ON CANOPY TREES 84" CAL.
- LANDSCAPE PLANTING ON CANOPY TREES 90" CAL.
- LANDSCAPE PLANTING ON CANOPY TREES 96" CAL.
- LANDSCAPE PLANTING ON CANOPY TREES 102" CAL.
- LANDSCAPE PLANTING ON CANOPY TREES 108" CAL.
- LANDSCAPE PLANTING ON CANOPY TREES 114" CAL.
- LANDSCAPE PLANTING ON CANOPY TREES 120" CAL.

**LANDSCAPE PLANTINGS**

LANDSCAPE PLANTINGS TO BE PROVIDED BY THE CONTRACTOR AND MAINTAINED BY THE OWNER.

ALL PLANTINGS SHALL BE INSTALLED AND MAINTAINED IN ACCORDANCE WITH THE FOLLOWING SPECIFICATIONS:

- PLANTINGS SHALL BE INSTALLED IN ACCORDANCE WITH THE FOLLOWING SPECIFICATIONS:
- PLANTINGS SHALL BE MAINTAINED IN ACCORDANCE WITH THE FOLLOWING SPECIFICATIONS:
- PLANTINGS SHALL BE REPLACED IN ACCORDANCE WITH THE FOLLOWING SPECIFICATIONS:

Planned Development  
District No. 184

**CLP.1**



**NOT FOR CONSTRUCTION**

**LANDSCAPE PLAN**

Project number: 0782180  
Date: 08/04/06

**PROJECT INVESTMENTS**

BO KA POWER

BO KA POWER

architectural - interior - planning - graphics  
6078 Park Lane, Suite 200 Dallas, TX 75231  
Tel: 972.201.0000 Fax: 972.291.5000  
www.bokapower.com

These documents are issued by the architect, engineer, planner, and landscape architect, and are not to be construed as a contract. The contract is the contract documents between the owner and the architect, engineer, planner, and landscape architect.

BO KA POWER