

EXHIBIT 656A

SCALE: 1" = 60'-0"

DATE

DEVELOPMENT PLAN

SITE DATA:	
PROPOSED USE:	PUBLIC SCHOOL
TOTAL LOT AREA:	104,248 SQ. FT.
TOTAL BUILDING AREA:	103,000 SQ. FT.
EXISTING ADDITION:	39,202 SQ. FT.
CLASSROOMS:	41
EXISTING PROPOSED:	20
PARKING REQUIRED:	592
EXISTING:	559
TOTAL REQUIRED:	235

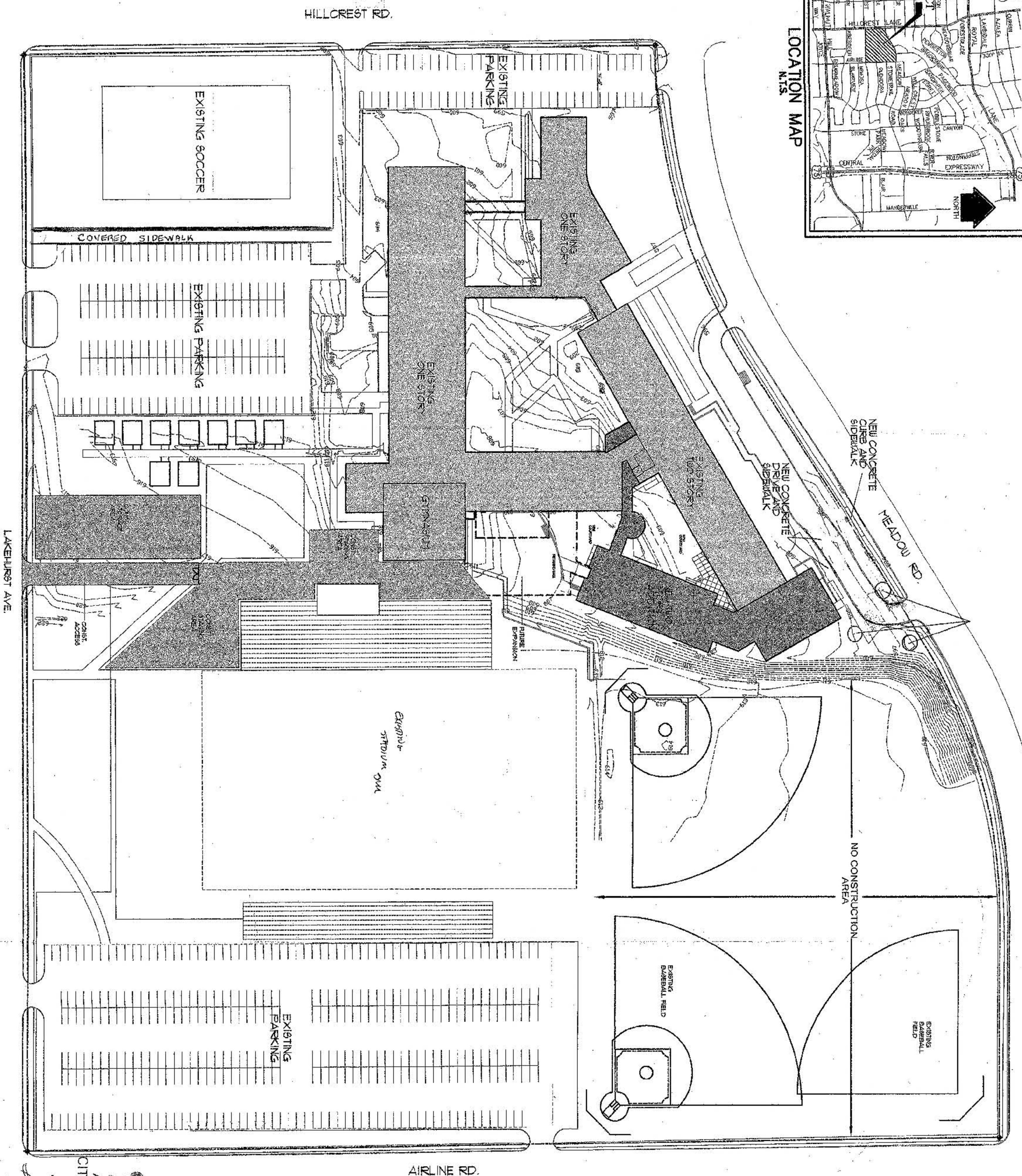
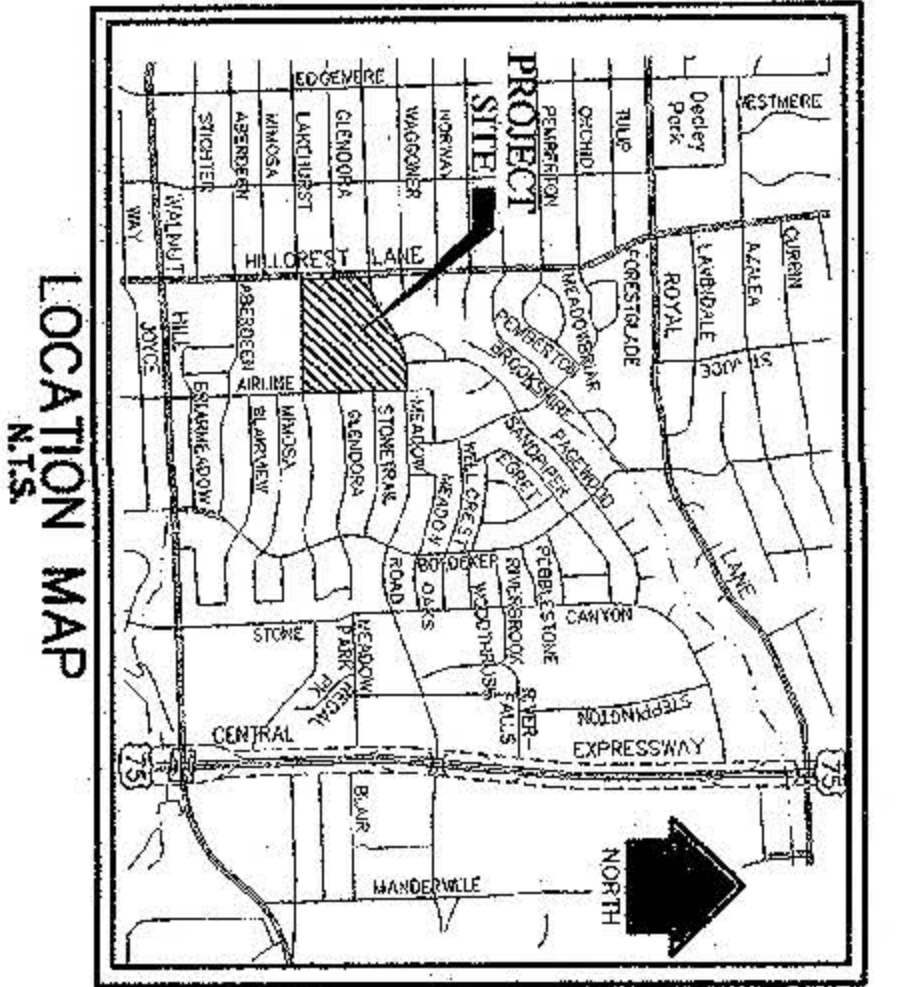

APPROVED BY
CITY COUNCIL
JUN 25 2003
081851
25300
City Plan Commission
6-5-03
Z023-214

PLANNED DEVELOPMENT DISTRICT NO. 656

Exhibit 656A

PRATT JACKSON
ARCHITECTURE

1645 STEMMONS FRWY #2 • DALLAS, TEXAS 75207 • 214-939-0508

PRELIMINARY
Incomplete Documents
May Not Be Used For
Regulatory Approval,
Permit, or Construction
James Reece Pratt
Texas Registration #1455

Additions and Renovations to
Benjamin Franklin Middle School
6920 Meadow Road Dallas, Texas 75230
for the
Dallas Independent School District

SCHEMATIC DESIGN
DSD BP003

Project No: 02205
Date: MAY 29, 2003
Drawn By: AGR
Checked By: RJ/SJ
Sheet of Sheets

A2.1